



INFORMATION DESK AND STAIR AT MAIN LOBBY



MAIN LOBBY WALKWAY



VIEW FROM MAIN ENTRANCE LOOKING WEST



MAIN LOBBY AND INFORMATION DESK FROM SECOND FLOOR



MAIN ENTRY LOOKING NORTH WEST



MAIN ENTRY AND MONUMENT



WEST ENTRANCE AND PARKING



VA/DA CAMPUS OVERVIEW



VA/DA CAMPUS OVERVIEW



EXTERIOR DESIGN

1
 Enhancement: Window louvers.
 Why: The adjustable metal shade louvers allow control of solar heat gain on the south-facing exposure, while allowing natural light to enter the building. Views to the exterior are preserved.

2 EXTENDED ROOF
 Enhancement: Extended roof at walkway.
 Why: The covered walkway has been widened to provide maximum protection for visitors exiting vehicles at the drop-off area. Additionally, the walkway roof now provides coverage for all entry/exit doors at the front of the building, and is visually connected to the building.

3 LIGHT SHELF
 Enhancement: Window shape/light shelf.
 Why: The solar heat gain on the south-facing windows can be controlled/limited, creating more comfortable work areas. The shade elements penetrate the glazing plane, providing a "light shelf" which reflects natural light deeper into the room, thereby reducing artificial lighting requirements and lowering energy costs.

PROPOSED MODIFICATIONS

4 TOWER ELEMENT
 Enhancement: Parapet tower element.
 Why: The new "tower fin" at the lobby intersection serves multiple purposes:
 a. The roof parapet screens from view the tall code-required smoke extractors above the glass lobby.
 b. The "tower" element helps unify the building design composition by bridging the glass lobby.
 c. The "tower" provides a distinct way-finding device for veterans visiting the facility for the first time, indicating the point of entry.
 d. The top of the parapet provides a clearly-visible location for signage or the VA logo.

5 COVERED ENTRY
 Enhancement: Covered area at west entry.
 Why: Adding a roof area at the west entry provides multiple benefits to the user groups:
 a. The roof element provides a signage location, assisting visitors with way-finding.
 b. The covered area provides protection from sun, rain, and wind from approaching storm systems.



FIRST FLOOR

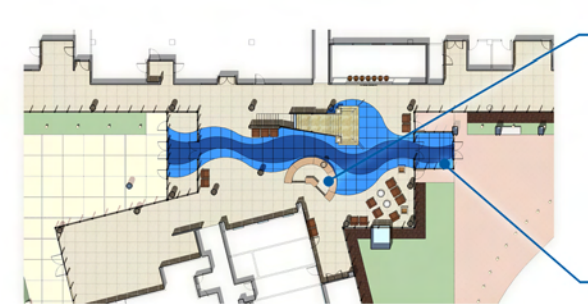

ENLARGED LOBBY PLAN

INTERIOR DESIGN

6 INFORMATION / HELP
 Enhancement: Relocate information/help desk in lobby; change to curvilinear shape.
 Why: An information desk re-located as shown has the following benefits:
 a. Improved visibility for guests entering the lobby from east or west doors.
 b. The curved/circular shape appears more user-friendly, while increasing work area.
 c. Locating the information desk under the second floor provides a more secure location for staff, provides more options for lighting the work area, and is closer to the elevators (for giving directions to visitors).
 d. People descending the grand stair will no longer "look down" on information desk staff, or over their shoulder (HIPAA issues).
 e. Improved HVAC control/comfort for staff at information desk.
 f. Increased security by allowing staff to view patients and visitors ascending the stair.

7 WALKWAY
 Enhancement: Meandering, organic "walkway" connecting east & west building entries.
 Why: Made of multiple colors of terrazzo, the meandering path is a curvilinear way-finding device, leading visitors to the information desk or to the grand stair. The multi-shade "river" through the lobby also creates a visually soothing and calming element within the spacious lobby and leads to nearby exterior meditation/quiet areas.

PROPOSED MODIFICATIONS

8 VA LOBBY LOGO
 Enhancement: VA logo on the east and west lobby glazing.
 Why: The over-scale logo, applied via chemical frit on the lobby glass, provides shading and limits solar heat gain into the lobby space, providing a more comfortable work environment for staff and visitors, while still allowing ample natural light into the space. The amount of "clear" glass vs "fritted" glass would be precisely engineered for maximum benefit.
 The large logos are also project identifiers at the building points of entry. In addition to way-finding assistance, the logos also serve as signage and interesting building detail, particularly when back-lit at night.

9 STAIRWAY
 Enhancement: Stairway widens at the base; enhanced landing design, including specialty lighting.
 Why: To encourage patients, staff and visitors to utilize the stairs as much as possible. The stairway should be a welcoming and interesting design element along the journey.



EAST ELEVATION



SOUTH ELEVATION



WEST ELEVATION



NORTH ELEVATION

SFO NO. VA-101-13-I-0004

MONTEREY, CALIFORNIA

JOINT INTEGRATED VA / DAH HEALTH CARE CENTER



SITE DESIGN PROPOSED MODIFICATIONS



1 LOWERED SITE CONTOURS

The existing pedestrian link, without retaining wall or steps, allows HCC patients and visitors to easily access entertainment and shopping opportunities at the proposed Cinema and Dunes Shopping Center directly to the north.

The redesigned site and building allow at-grade access at stair towers making emergency egress easier and safer and providing opportunity for community staff access from dedicated staff parking areas and reduced use of ramps.

2 PEDESTRIAN PROMENADE

Widened pedestrian boulevard, linking the overlook, the "preferred parking" and the building entry, for improved way-finding and building entry experience.

3 REDESIGNED OVERLOOK PLAZA

Steeper grading operations further away from the heritage Monterey Cypress trees that are designated to be preserved and protected in place along the perimeter of the site.

4 REDUCE IMPACT OF EXCAVATION ACTIVITIES

Prevents environmental damage caused by removing 70,000 cubic yards of earth from a "sensitive site" across from nearby.

5 REDESIGNED OUTDOOR EXERCISE AREA

Shade canopy provides shelter, privacy, and a softer landscaped edge around the Outdoor Exercise Area for the Physical Medicine and Rehabilitation Clinic.

6 PROVIDED AREAS OF RESPITE

The landscape incorporates two areas of respite, one of which is accessible from the dining terrace. The central green space area of respite is the formal outdoor water feature which provides a calming, tranquil quality to the environment.

7 REFINED DINING TERRACE

Landscape berm beyond the perimeter of the low retaining wall in conjunction with the lower South Bay helps to deflect the Dining Terrace from an onshore wind.

8 IMPROVED ACCESSIBLE PARKING

A "preferred parking" area is provided for disabled visitors in keeping with VA Program Guide PG-18-13. Accessible parking directly connects to the promenade which is situated along the central axis of the building entrance.

SFO NO. VA-101-13-I-0004

MONTEREY, CALIFORNIA

JOINT INTEGRATED VA/DA HEALTH CARE CENTER

