

VALUABLE

RETURN TO
**CARR & J. E.
 GREINER CO.
 JACKSONVILLE,
 N. C.**

SUBJECT Sewers in Disposal Field Area
Airport Section

FIELD PARTY

IN CHARGE _____
 INSTRUMENT _____
 NOTES _____
 TAPE READ _____
 TAPE OR ROD _____
 TAPE OR ROD _____
 INSTRUMENT NO. _____
 TAPE NO. _____

WEATHER

CLEAR _____ SNOW _____
 CLOUDY _____ HOT _____
 WINDY _____ MODERATE _____
 RAIN _____ COLD _____
 FAIR _____ FOG _____
 FIGURED BY _____
 NOTES CHECKED BY _____
 PLOTTED BY FW DATE _____ 19____

FILE NO. 118

FLDR. NO. _____

SHEET _____

DATE _____ 19____

STATION	DIST.	ANGLE	+	H. I.	- VER: ANG. DIFF.	ELEVATION
		° ' "				

B.M. # 639			3.98	13.11		9.135
------------	--	--	------	-------	--	-------

Administration Bldg. Outlet					5.64	7.47
-----------------------------	--	--	--	--	------	------

M.H. # 411 ?						
Top of Casing			3.59			9.58
Present Water Level			6.21			6.90
Floor of M.H. "			7.00			6.11
8" Casing on Concrete						

M.H. # 373						
Top of Casing			4.11			9.00
Present Water Level			6.20			6.91
Floor of M.H.			8.32			4.79

Septic Tank's Top			6.30			6.81
Inlet Pipe Invert			8.84			4.27
Outlet "			8.84			4.27

M.H. # 452						
Top			4.95			8.16
Present Water Level			6.21			6.90
Floor of M.H.			8.90			4.21
8" Stub			5.65			4.46
Invert of Outlet to Disposal Field			7.97			4.35

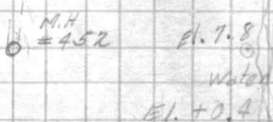
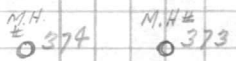
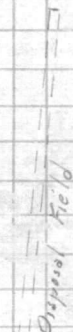
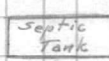
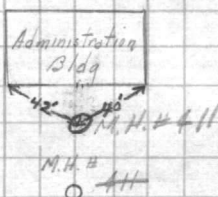

Rechecked and could find no evidence of Stub.

FILE NO.

DATE
CLASS
AUTHOR
TITLE
SUBJECT
SERIALS
EDITION
FORM

FIELD NO.
LOCALITY
COLLECTOR
DATE
TIME
LOCAL NAME
LOCAL USE



CHANGING INFORMATION
THE COMPANY

VALUABLE

SUBJECT _____

RETURN TO
 CARR & J. E.
 GREINER CO.
 JACKSONVILLE,
 N. C.

FIELD PARTY

_____. IN CHARGE
 _____. INSTRUMENT
 _____. NOTES
 _____. TAPE READ
 _____. TAPE OR ROD
 _____. TAPE OR ROD
 _____. INSTRUMENT NO.
 _____. TAPE NO.

WEATHER

CLEAR SNOW
 CLOUDY HOT
 WINDY MODERATE
 RAIN COLD
 FAIR FOG

FILE No. _____

FLDR. No. _____

SHEET _____

FIGURED BY _____

NOTES CHECKED BY _____

PLOTTED BY _____ DATE _____ 19 _____

STATION	DIST.	ANGLE	+	H. I.	— VER: ANG. DIFF.	ELEVATION
B.M.#639		° ' "		3 96	13.29	9.135
8" stub toward landing field.				8.23		5.06
8" " " River						⁷¹ 4.30
2 1/2 let				8 11		5.18
						⁷¹ 4.47
M.H.# ⁴¹¹ 7 16 1/2' from Adm. Bldg.				3 44		9.85
top of casing				5 90		7.39
present water level				5 94		7.35
Floor of M.H.						
outlet						

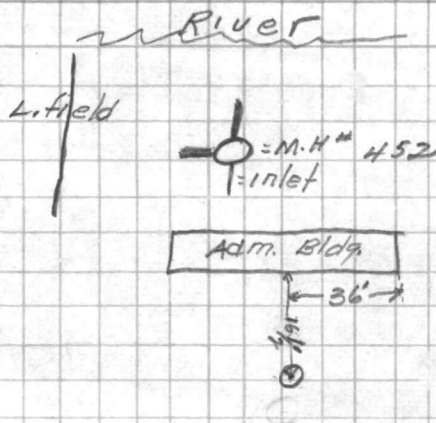

5.00

	10.61
	<u>3.95</u>
	14.56
8.32	<u>3.12</u>
<u>3.95</u>	5
12.90	

	4.36
	<u>8.90</u>
	13.26
5.64	
<u>3.95</u>	
9.62	

	7.94
	<u>21</u>
	8.65

244

VALUABLE
 RETURN TO
 CARR & J. E.
 GREINER CO.
 JACKSONVILLE,
 N. C.

 SUBJECT Profile of 6" Transit
Water Line Rt. of "A" ST.
from Well 6. towards 11th ST.
Tent Camp # 2

FIELD PARTY

 _____ IN CHARGE
 _____ INSTRUMENT
 _____ NOTES
 _____ TAPE READ
 _____ TAPE OR ROD
 _____ TAPE OR ROD
 _____ INSTRUMENT NO.
 _____ TAPE NO.

WEATHER

 CLEAR _____ SNOW _____
 CLOUDY _____ HOT _____
 WINDY _____ MODERATE _____
 RAIN _____ COLD _____
 FAIR _____ FOG _____
 FIGURED BY _____
 NOTES CHECKED BY _____
 PLOTTED BY _____

 FILE No. 118
 FLDR. No. _____
 SHEET 1st
 DATE 4-2 1942

STATION	DIST.	ANGLE		H. I.	ELEVATION	
		°	' "		VER.	ANG. DIFF.
10 th ST Rec. Bldg. B.M.				4.60	26.50	21.90
0+00				9.97	16.53	
0+05				9.83	16.67	
0+50				9.90	16.68	
1+18				9.88	16.62	
+50				9.83	16.67	
2+00				9.95	16.55	
+50				9.88	16.62	
3+00				9.81	16.69	
+50				9.76	16.74	
4+00				9.92	16.58	
+50				9.86	16.64	
5+00				9.95	16.55	
+50				9.72	16.78	

 Well "6." on A ST. between 9th and 10th STs.
 8"x6" Tee 2-22 $\frac{1}{2}$ " Bands

6" Valve

 Not enough
 information

VALUABLE

SUBJECT

DATE
STATE

SHIRAZI MORGAN (M)
FAT COUNTY U.S.A

FILE NO

ATTORNEY
FIRM

DATE

VALUABLE
 RETURN TO
 CARR & J. E.
 GREINER CO.
 JACKSONVILLE,
 N. C.

 SUBJECT Profile of 6" Transit Water
Line Rt. "A" Street
Tent Camp #2
FIELD PARTY
 IN CHARGE _____
 INSTRUMENT _____
 NOTES _____
 TAPE READ _____
 TAPE OR ROD _____
 TAPE OR ROD _____
 INSTRUMENT NO. _____
 TAPE NO. _____
WEATHER
 CLEAR _____ SNOW _____
 CLOUDY _____ HOT _____
 WINDY _____ MODERATE _____
 RAIN _____ COLD _____
 FAIR _____ FOG _____

FILE No. _____

FLDR. No. _____

SHEET 2 of
 FIGURED BY _____
 NOTES CHECKED BY _____
 PLOTTED BY _____
 DATE 4-2 19 42

STATION	DIST.	ANGLE		+	H. I.	VER. ANG. DIFF.		ELEVATION
		°	' "					
6+00					26.50		9.52	1698
+22								
T.P.						2.42	24.08	

6+00

+22

T.P.

26.50

9.52 1698

2.42 24.08

Pole

Tack in Top stump is Rt. 6+12

on 3.1.1

VALUABLE

100% RAG CONTENT U.S.A.

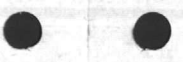

(31)

VALUABLE

SUBJECT Profile of 4" water line
between "E" & "F" St. from 10th to 11th

RETURN TO
CARR & J. E.
GREINER CO.
JACKSONVILLE,
N. C.

FIELD PARTY
O'Shea IN CHARGE
INSTRUMENT _____
NOTES _____
TAPE READ _____
TAPE OR ROD _____
TAPE OR ROD _____
INSTRUMENT NO. _____
TAPE NO. _____

WEATHER
CLEAR _____
CLOUDY
WINDY
RAIN _____
FAIR _____
SNOW _____
HOT _____
MODERATE _____
COLD
FOG _____
FIGURED BY _____
NOTES CHECKED BY _____
PLOTTED BY JFW

FILE No. 118
FLDR. No. _____
SHEET 1 of 2
DATE 1-8 1942

STATION	DIST.	ANGLE ° ' "	+	H. I.	— VER: ANG. DIF.	ELEVATION	
BM#579			7.615	19.560		11.915	
45+66					9.52	10.04	8"X4" Tee ✓
+70					9.51	10.05	4"V&B
46+00					8.77	10.79	
+18							
+43					7.76	11.80	4'X4" Tee ✓
+43					7.75	11.81	4"V&B 4'rit
47+00					6.93	12.63	
+50					6.89	12.67	
+90					6.63	12.93	4"X4" Tee ✓
+90					6.72	12.84	4"V&B
48+00					6.48	13.08	
+50					6.90	12.66	
+91					6.62	12.94	4"X4" Tee ✓
+91					6.72	12.84	4"V&B
49+00					6.61	12.95	

Between E - F. sts

10th - 11th

Profile #59

Plotted

VALUABLE
 RETURN TO
 CARR & J. E.
 GREINER CO.
 JACKSONVILLE,
 N. C.

 SUBJECT Profile of 4" water line
between "E" & "F" st from 10th to 11th sta.

FIELD PARTY

 IN CHARGE O'Shea
 INSTRUMENT _____
 NOTES _____
 TAPE READ _____
 TAPE OR ROD _____
 TAPE OR ROD _____
 INSTRUMENT NO. _____
 TAPE NO. _____

WEATHER

 CLEAR _____ SNOW _____
 CLOUDY _____ HOT _____
 WINDY _____ MODERATE _____
 RAIN _____ COLD _____
 FAIR _____ FOG _____
 FIGURED BY _____
 NOTES CHECKED BY _____
 PLOTTED BY _____

FILE No. _____

FLDR. No. _____

SHEET 20 of 2DATE 1-8 1942

STATION	DIST.	ANGLE		+	H. I. <u>19.56</u>	—		ELEVATION	
		°	"			VER:	ANG. DIFF.		
49+50						7.05	12.51		
50+00						7.05	12.51		
+13						7.02	12.54		4"X4" Tee ✓
+13						6.99	12.57		4"V&B
+50						6.69	12.87		
51+00						6.57	12.99		
+15						6.44	13.12		4"X4" Tee ✓
+15						6.37	13.19		4"V&B
+55						5.73	13.83		4"V&B
+59						5.56	14.00		8"X4" Tee ✓

Between E-F Sts
10th - 11th

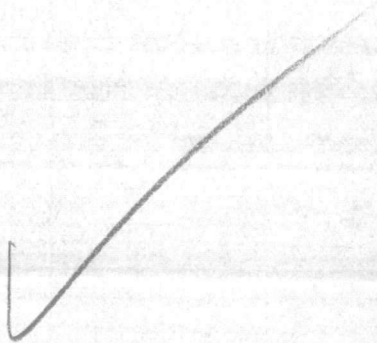

(93)
8/18/42

VALUABLE

SUBJECT Profile of 8" water line
43' RT @ 10th st

RETURN TO
 CARR & J. E.
 GREINER CO.
 JACKSONVILLE,
 N. C.

FIELD PARTY
D. Shea IN CHARGE
 _____ INSTRUMENT
 _____ NOTES
 _____ TAPE READ
 _____ TAPE OR ROD
 _____ TAPE OR ROD
 INSTRUMENT NO. _____
 TAPE NO. _____

WEATHER
 CLEAR _____
 CLOUDY _____
 WINDY _____
 RAIN _____
 FAIR _____
 SNOW _____
 HOT _____
 MODERATE _____
 COLD _____
 FOG _____
 FIGURED BY _____
 NOTES CHECKED BY _____
 PLOTTED BY JS

FILE No. 118
 FLDR. No. _____
 SHEET 1041
 DATE 1-2 1942

STATION	DIST.	ANGLE ° ' "	+	H. I.	— VER: ANG. DIFF.	ELEVATION		
BM#579			5.847	17.762		11.915		
16+47 = 45+66 "F" st.					7.19	10.58	8" X 8" cross	F" ST.
16+00					6.92	10.84		
15+50					6.68	11.08		
15+00					7.70	10.06	8" X 4" Tee	✓
14+37					8.10	9.66	8" Y 2 B	
14+40					8.20	9.56	8" X 8" Tee	✓
14+43					8.17	9.59	8" X 8" Tee	E" ST.
BM#579			5.847	17.762		11.915		

10th ST

F to E.

Profile #56
Plotted

S

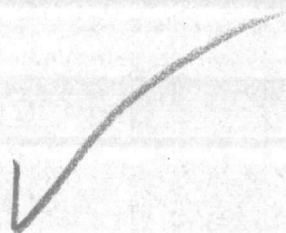

(97)
8/18/42

VALUABLE
 RETURN TO
 CARR & J. E.
 GREINER CO.
 JACKSONVILLE,
 N. C.

 SUBJECT Profile of 8" waterline
43' lot @ "E" st

FIELD PARTY

D Shea IN CHARGE
 _____ INSTRUMENT
 _____ NOTES
 _____ TAPE READ
 _____ TAPE OR ROD
 _____ TAPE OR ROD
 _____ INSTRUMENT NO.
 _____ TAPE NO.

WEATHER

 CLEAR _____ SNOW _____
 CLOUDY _____ HOT _____
 WINDY _____ MODERATE _____
 RAIN _____ COLD _____
 FAIR _____ FOG _____
 FIGURED BY _____
 NOTES CHECKED BY gww
 PLOTTED BY _____
FILE No. 118

FLDR. No. _____

SHEET 1 ofDATE 1-2 19 42

STATION	DIST.	ANGLE ° ' "	+	H. I.	— VER: ANG. DIFF.	ELEVATION	
BM 2579			5847	17.762		11.915	
45+66					817	9.59	8" X 8" Tee. 10' H' ST
45+00					1055	7.21	
44+50					1255	5.21	
44+28					1340	4.36 (390)	Drainage Ditch Elev. (5.42)
44+00					1365	4.11	
43+50					1308	4.68	
43+00					1182	5.94	
42+82					1097	6.79	8" X 6" Tee ✓
42+82					1114	6.62	6" VEB 4' H.
42+82					1032	7.44	FH lead 21 ft.
42+50					1145	6.31	
42+00					1172	6.04	
41+92					1150	6.26	8" X 6" Tee 6" H. reducer ✓

E 3T.

8th to 10th

#51

Plotted

VALUABLE

SUBJECT Profile of 8" water line
43' Lt & E. St.

RETURN TO
CARR & J. E.
GREINER CO.
JACKSONVILLE,
N. C.

FIELD PARTY
0 Shea IN CHARGE
INSTRUMENT
NOTES
TAPE READ
TAPE OR ROD
TAPE OR ROD
INSTRUMENT NO.
TAPE NO.

WEATHER
CLEAR
CLOUDY
WINDY
RAIN
FAIR
SNOW
HOT
MODERATE
COLD
FOG
FIGURED BY
NOTES CHECKED BY
PLOTTED BY

FILE No. 98
FLDR. No.
SHEET 2 of
DATE 1-2 1942

STATION	DIST.	ANGLE ° ' "	+	H. I. 17.762	VER: ANG. DIFF.	ELEVATION	
TP					9.72	8.042	
			10387	18.429			
41+50					10.91	7.52	
41+00					9.67	8.76	
40+50					8.20	10.23	
40+05					7.80	10.63	8" V&B
40+03					7.83	10.60	8" X 6" Tee ✓ 9TH ST.
40+03					7.81	10.62	6" V&B 4' rt
39+50					8.30	10.13	
39+00					9.13	10.30	
38+50					8.25	10.18	
38+19					8.37	10.06	8" X 6" Tee & 6" X 4" reducer
38+00					8.27	10.16	
37+56					8.56	9.97	8" X 6" Tee
37+56					8.67	9.76	6" V&B 4' rt ✓
37+56					8.82	9.61	4H/lead 21' rt

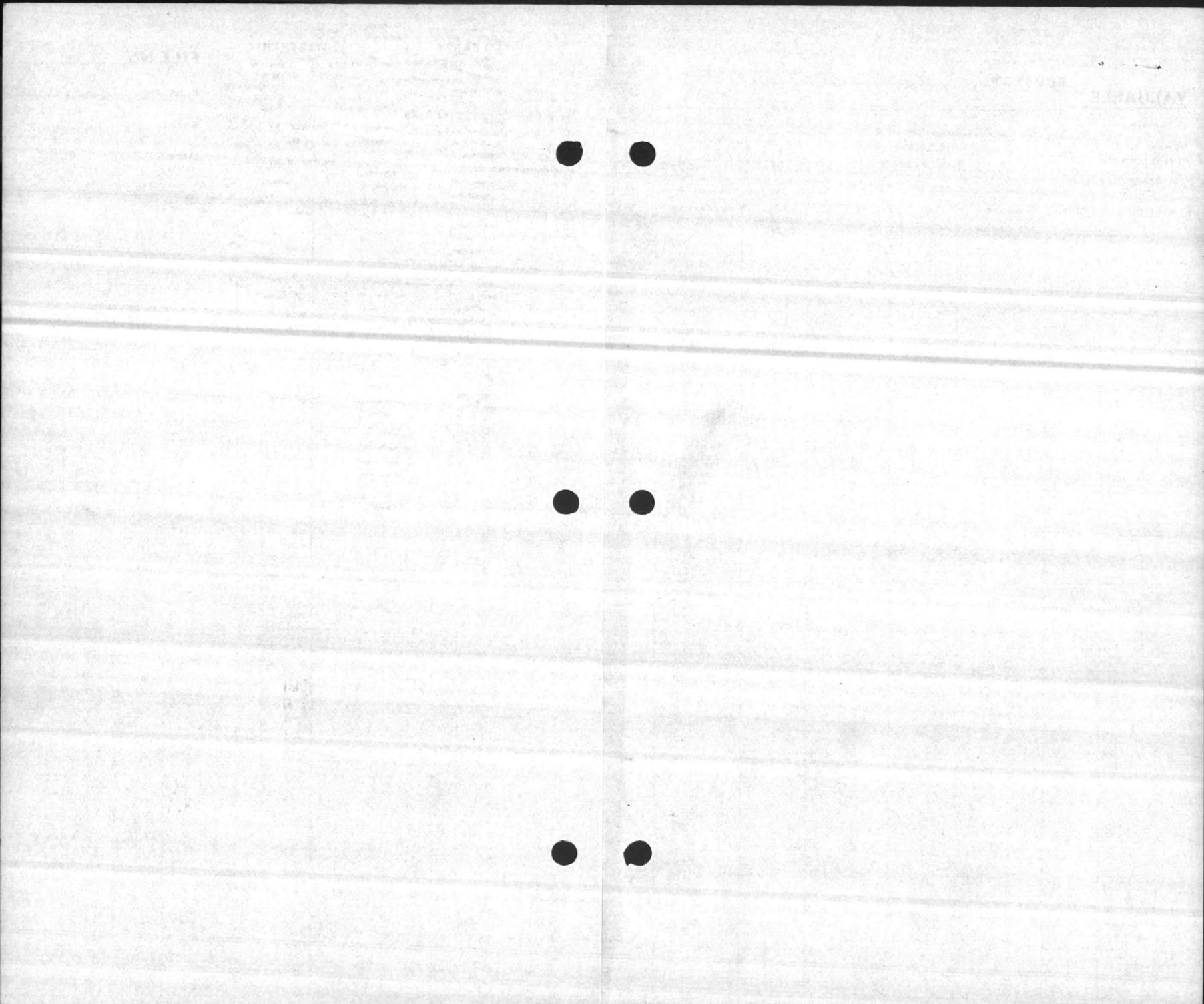

VALUABLE
 RETURN TO
 CARR & J. E.
 GREINER CO.
 JACKSONVILLE,
 N. C.

 SUBJECT Profile of 8" Water Line
43' Lt. E "E" ST.

FIELD PARTY

O Shea IN CHARGE
 _____ INSTRUMENT
 _____ NOTES
 _____ TAPE READ
 _____ TAPE OR ROD
 _____ TAPE OR ROD
 INSTRUMENT No. _____
 TAPE No. _____

WEATHER

 CLEAR _____ SNOW _____
 CLOUDY _____ HOT _____
 WINDY _____ MODERATE _____
 RAIN _____ COLD _____
 FAIR _____ FOG _____
 FIGURED BY _____
 NOTES CHECKED BY _____
 PLOTTED BY _____
FILE No. 98

FLDR. No. _____

SHEET 307DATE 1-2 19 42

X

STATION	DIST.	ANGLE ° ' "	+	H. I.	VER: ANG.	ELEVATION		
				<u>18.429</u>	DIFF.			
<u>37400</u>					<u>10.48</u>	<u>7.95</u>		
<u>36750</u>					<u>11.04</u>	<u>7.39</u>		
<u>36400</u>				<u>9</u>	<u>9.95</u>	<u>8.48</u>		
<u>35450</u>					<u>11.73</u>	<u>6.70</u>		
<u>35400</u>					<u>13.45</u>	<u>4.98</u>		
<u>34450</u>					<u>13.10</u>	<u>5.33</u>		
<u>34735</u>					<u>12.86</u>	<u>5.57</u>		<u>8" V&B</u>
<u>34430</u>					<u>12.80</u>	<u>5.63</u>		<u>8" x 8" tee 8' x 6" reducer 8" ST</u>
<u>T.P.</u>					<u>11.24</u>	<u>7.189</u>		

E ST

8th to 10th



(100)
5/18/42

VALUABLE

RETURN TO
CARR & J. E.
GREINER CO.
JACKSONVILLE,
N. C.

SUBJECT Profile of 2" Water Line
from Flounder Road to
Officers Quarters

FIELD PARTY

Osborn IN CHARGE
INSTRUMENT _____
NOTES _____
TAPE READ _____
TAPE OR ROD _____
TAPE OR ROD _____
INSTRUMENT NO. _____
TAPE NO. _____

WEATHER

CLEAR _____ SNOW _____
CLOUDY _____ HOT _____
WINDY _____ MODERATE _____
RAIN _____ COLD _____
FAIR _____ FOG _____

FIGURED BY _____
NOTES CHECKED BY _____
PLOTTED BY _____

FILE No. 219

FLDR. No. _____

SHEET 1 of 1DATE 2-23-1942

STATION	DIST.	ANGLE ° ' "	+	H. I.	— VER. ANG. DIFF.	ELEVATION	
BM # 636			4.80	11.16		6.36	
0+00 = 12+50 Flounder Road					8.93	2.23	4" x 7" Tpc - 2" P/og
0+04					9.14	2.02	2" x 1/2"
+50					8.25	2.91	
1+00					7.48	3.68	
+50					6.20	4.96	
2+00					5.72	5.44	
+28					5.83	5.33	2" x 2" Tpc
BM # 636			4.80			6.36	

Profile of 2" W. line from
Flounder Road to Officers Quarters.

PETERFIELD POINT

Sketch
N

See map for
Operations
Block

Plotted

10-1-42

(136)