

REVISIONS			
SYMBOL	DESCRIPTION	DATE	APPROVED

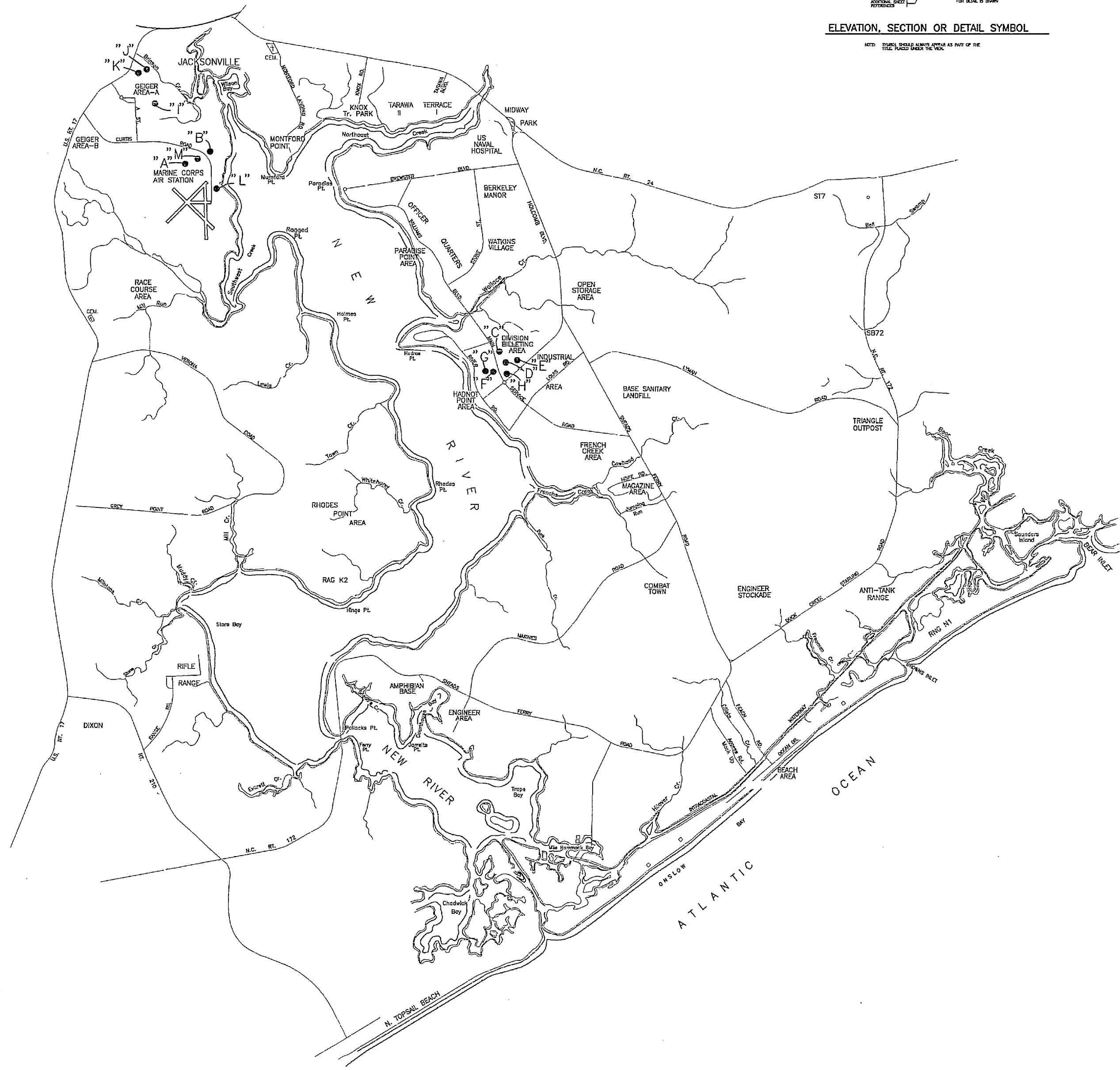
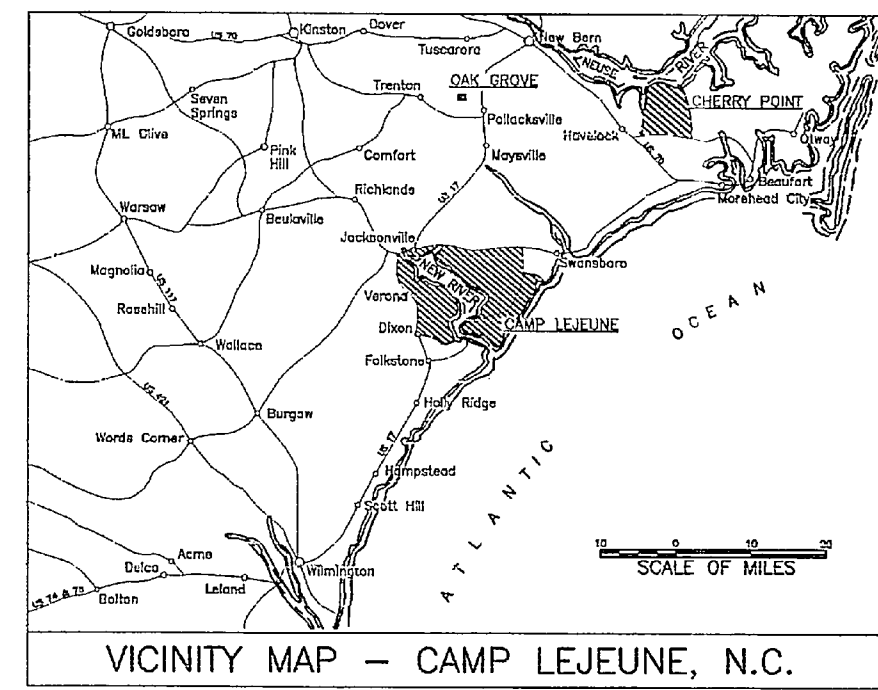
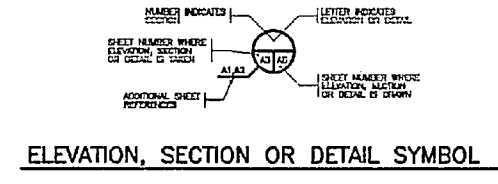

DRAWING INDEX

- C-1 LOCATION MAP AND DRAWING INDEX
- C-2 DETAILS
- C-3 PARKING LOT "A" AND "B"
- C-4 PARKING LOT "C", "D", "E" AND "F"
- C-5 PARKING LOT "G" AND "H"
- C-6 PARKING LOT "I", "J" AND "K"
- C-7 PARKING LOT "L" AND "M"

LOCATION MAP - U. S. MARINE CORPS BASE - CAMP LEJEUNE, N.C.
SCALE : NONE

HOBBS, UPCHURCH & ASSOCIATES, P.A. CONSULTING ENGINEERS SOUTHERN PINES, NORTH CAROLINA 28387		C-1	
DEPT OF NAVY MARINE CORPS BASE CAMP LEJEUNE, NORTH CAROLINA		NAVAL FACILITIES ENGINEERING COMMAND	
DEL: OKD DR: EV CHK: DTU SUBMITTED BY:		LOCATION MAP AND DRAWING INDEX REPAIR PARKING LOTS, BASEWIDE	
DESIGN DFL: APPROVED: PWO OR OICG DATE:		PROJECT ICD: NAVFAC DRAWING NO. 4360670	
DATE:		CONSTRUCTION NO. NS2470-47-D-2001	
BATTLEFACTORY TO DATE:		SCALE: AS SHOWN G.P.S.C. SHEET 1 OF 7	



REVISIONS		
BY	DESCRIPTION	DATE

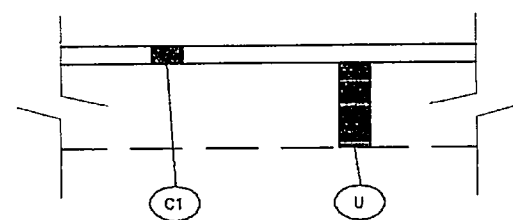

1 PAVEMENT SECTION

1	2
3	2
4	
5	
6	
7	

① CONTRACTOR SHALL INCLUDE IN THE BID, INCIDENTAL TO THE LUMP SUM BID ITEM, PROVIDING 17,000 LBS. OF CRACK SEALANT, PS/AR.

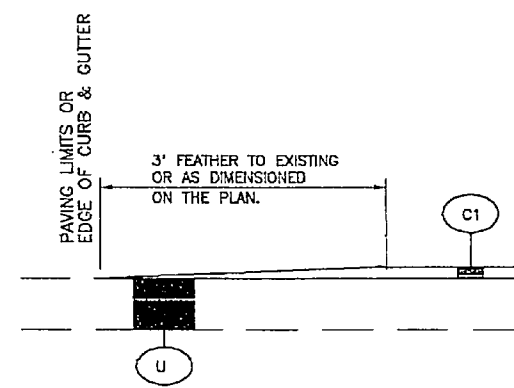

2 FEATHER JOINT

3	2
4	
5	
6	
7	

(INTERFACE EXISTING AND NEW)
NTS

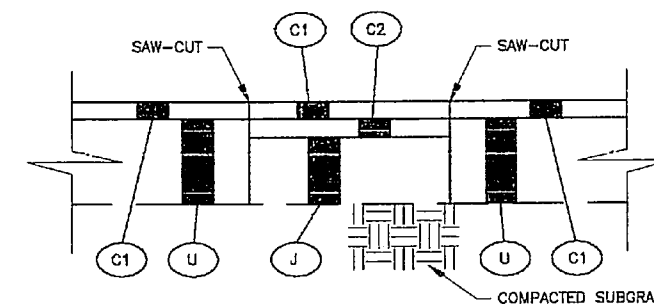

3 PAVEMENT REPAIR SECTION

3	2
4	
5	
6	
7	

NTS

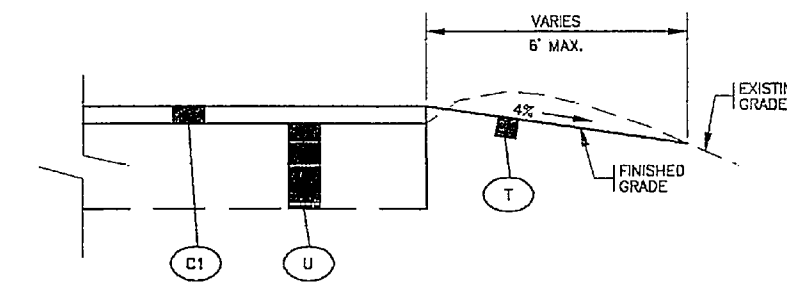

4 EDGE GRADING

6	2
7	

NTS

SCHEDULE OF QUANTITIES

SITE ID	OVERLAY AREA (SF)	CRACK SEALANT (LBS)	LEVELING COURSE 1" (TONS)	WEARING COURSE (TONS)	REPAIR AREA (SF)	BASE COURSE 8" ABC (TONS)
LOT "A"	99,088	3,802.5	666	605.5		
LOT "B"	23,361	849.5	157.3	143	805	69.6
LOT "C"	49,107	1,785.7	330.6	300.5		
LOT "D"	8,648	314.5	58.3	53	2200	109.5
LOT "E"	30,246	1,099.9	203.5	185	1350	67.5
LOT "F"	7,266	264.5	49	44.5	270	13.2
LOT "G"	103,335	3,757.6	694.7	631.5		
LOT "H"	58,288	2,119.6	392.2	356.5		
LOT "I"	36,711	1,334.9	247	224.5	975	30.3
LOT "J"	83,361	2,304.0	426.3	387.5	2500	125.1
LOT "K"	14,352	521.9	96.8	88		
LOT "L"	75,361	2,740.2	505.6	460.5		
LOT "M"	25,557	928.4	171.6	156	465	23.3
TOTALS	594,663	21,624	3,999.9	3,636	8,565	438.5

PAVEMENT SCHEDULE

C1	NEW APPROX. 2" BIT. CONC. SURFACING, TYPE I-1, AT AN AVERAGE RATE OF 110 LBS. PER SQ. YD. IN EACH OF TWO 1" COURSES, LEVELING AND WEARING.
C2	NEW APPROX. 2" BIT. CONC. COURSE, TYPE II AT AN AVERAGE RATE OF 220 LBS. PER SQ. YD.
J	NEW 6" AGGREGATE BASE COURSE
T	EARTH MATERIAL, SEED, MULCH AND TACK.
U	EXISTING PAVEMENT
①	LEVELING COURSE SHALL BE A MINIMUM OF 1". CONTRACTOR SHALL INCREASE BY 100% BID QUANTITY OF LEVELING COURSE BITUMINOUS CONCRETE. THE EXCESS SHALL BE USED FOR SURFACE POTHOLES, FILLING CRACKS GREATER THAN 1", AND LEVELING LOW SPOTS PONDING WATER.

	HOBBS, UPCHURCH & ASSOCIATES, P.A. CONSULTING ENGINEERS SOUTHERN PINES, NORTH CAROLINA 28387	C-2
	DEPT OF NAVY MARINE CORPS BASE CAMP LEJEUNE, NORTH CAROLINA	
DES. GKD DR. EV CHC. DTU SUBMITTED BY: DESIGN DR.	REPAIR PARKING LOTS DETAILS REPAIR PARKING LOTS, BASEWIDE PROJECT NO.	NAVFAC DRAWING NO. 4360671 <small>CONTRACT NO. NS2470-87-0-9301</small>
APPROVED PWO OR OIC DATE DATE	SCALE AS SHOWN	SHEET 2 OF 7



REVISIONS			
SYM	DESCRIPTION	DATE	APPROVED

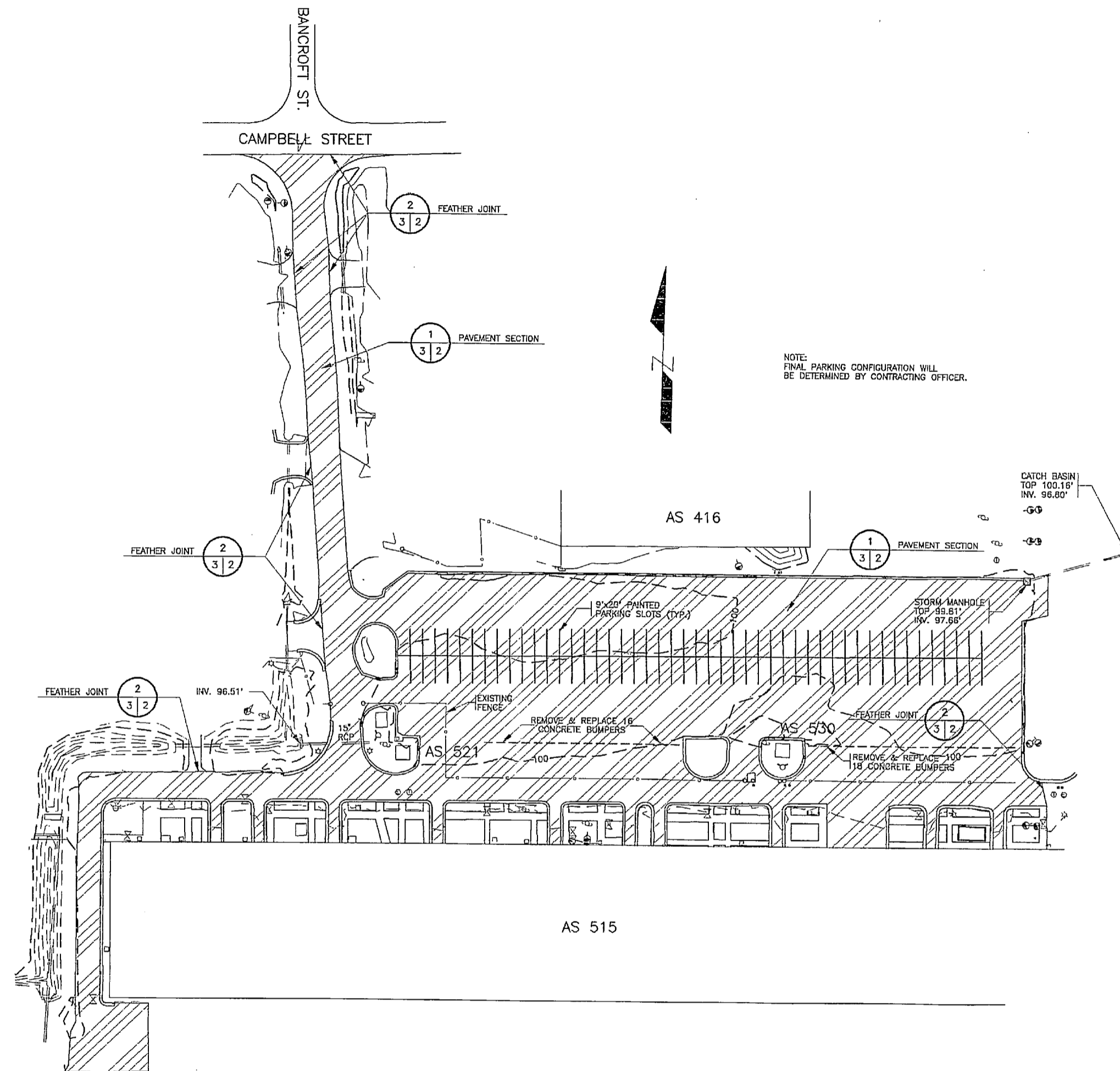

PARKING LOT "A"
1" = 40'

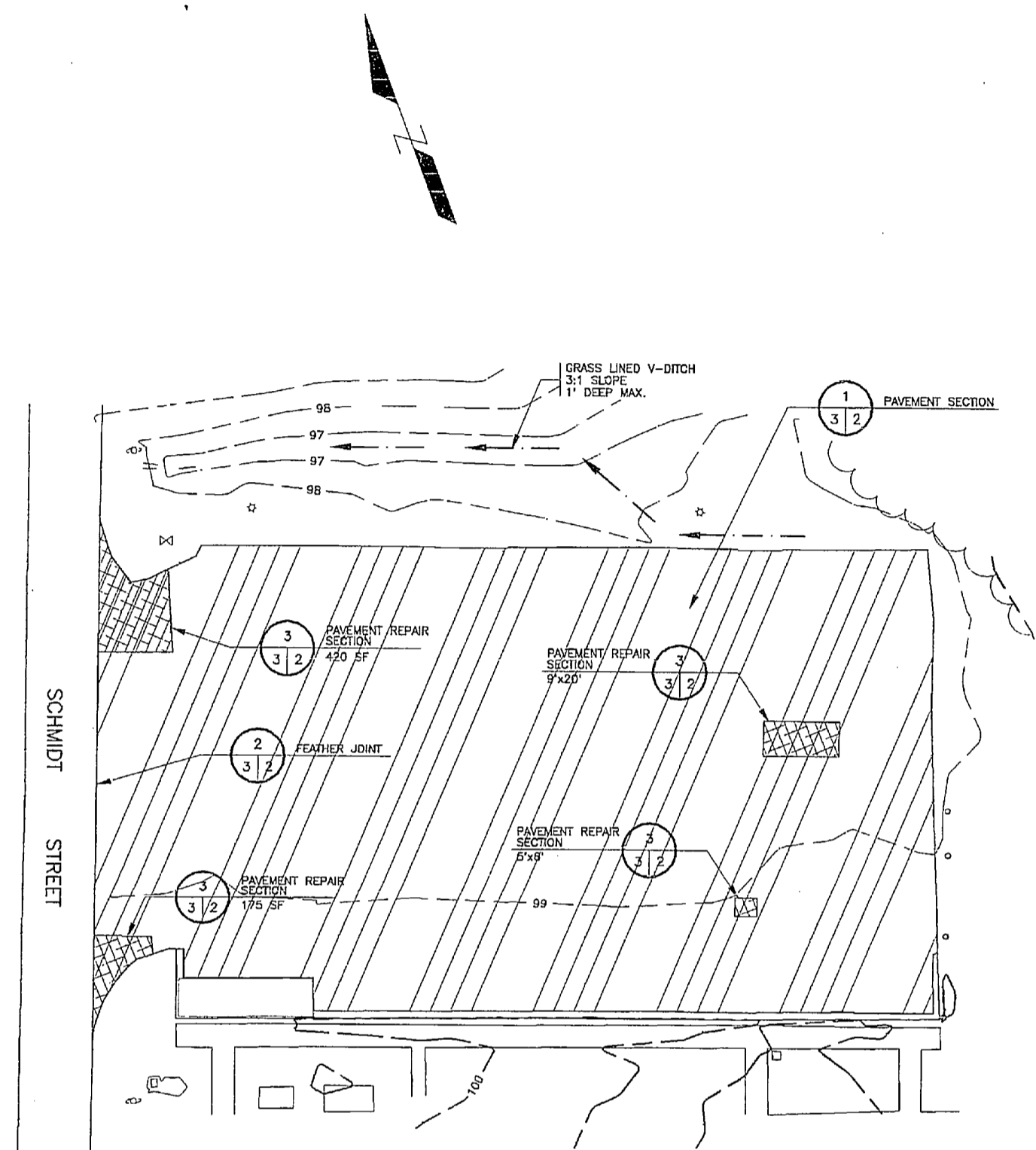
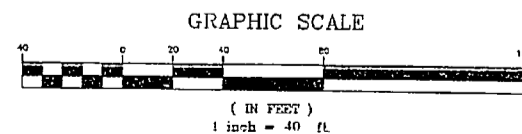

PARKING LOT "B"
1" = 20'

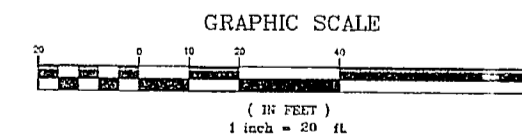

LEGEND

	EXISTING		NEW
	RESURFACING AREA		EXIST. CONTOURS
	EXIST. STORM SEWER		LIGHT POLE
	LIGHT POLE		UTILITY POLE
	UTILITY POLE		GUY WIRE
	GUY WIRE		TREE
	TREE		WOODS LINE
	WOODS LINE		WATER VALVE
	WATER VALVE		FIRE HYDRANT
	FIRE HYDRANT		SEWER MANHOLE
	SEWER MANHOLE		TELEPHONE MANHOLE
	TELEPHONE MANHOLE		ELECTICAL MANHOLE
	ELECTICAL MANHOLE		CATCH BASIN
	CATCH BASIN		SIGN
	SIGN		FENCE
	FENCE		PAVEMENT REPAIR
	PAVEMENT REPAIR		CONCRETE BUMPER
	CONCRETE BUMPER		

HOBBS, UPCHURCH & ASSOCIATES, P.A. CONSULTING ENGINEERS SOUTHERN PINES, NORTH CAROLINA 28387		C-3	
DEPT OF NAVY MARINE CORPS BASE CAMP LEJEUNE, NORTH CAROLINA		NAVAL FACILITIES ENGINEER-IN-CHARGE	
REPAIR PARKING LOTS "A" AND "B" REPAIR PARKING LOTS, BASEWIDE		PROJECT NO.	
DESIGN DR. APPROVED PWD OR OICC DATE	SIZE F	CODE IDENT NO. 4360672	NAVFAC DRAWING NO. 4360672
SUBMITTED BY	DATE	CONTR CONTN NO. N62476-B7-II-9301	SHEET 3 OF 7

1890

The first part of the document discusses the general principles of the proposed system. It is intended to provide a comprehensive overview of the various aspects involved in the implementation of the new regulations. The following sections will detail the specific measures to be taken, the responsibilities of the various departments, and the timeline for the completion of the project.

The second part of the document outlines the specific measures to be taken. These include the establishment of a new committee to oversee the implementation, the revision of existing regulations, and the introduction of new procedures. The committee will be responsible for ensuring that all measures are implemented in a timely and effective manner.

The third part of the document details the responsibilities of the various departments. Each department will be assigned specific tasks and responsibilities, and will be held accountable for the successful completion of these tasks. The following table provides a summary of the responsibilities of each department.

Department	Responsibilities
Department A	Responsible for the implementation of the new regulations and the revision of existing regulations.
Department B	Responsible for the introduction of new procedures and the establishment of a new committee.
Department C	Responsible for the oversight of the implementation process and the reporting of progress to the committee.

The fourth part of the document provides a timeline for the completion of the project. The project is expected to be completed within a period of six months. The following table provides a summary of the key milestones and their expected completion dates.

Milestone	Expected Completion Date
Establishment of the new committee	January 15, 1890
Revision of existing regulations	February 15, 1890
Introduction of new procedures	March 15, 1890
Implementation of the new regulations	April 15, 1890
Completion of the project	June 15, 1890

The fifth part of the document discusses the budget for the project. The total cost of the project is estimated to be \$10,000. The following table provides a summary of the estimated costs for each department.

Department	Estimated Cost
Department A	\$3,000
Department B	\$4,000
Department C	\$3,000

The sixth part of the document discusses the risks associated with the project. The most significant risks are the potential for delays in the implementation process and the possibility of budget overruns. The following table provides a summary of the risks and the measures to be taken to mitigate them.

Risk	Measures to Mitigate
Delays in the implementation process	Regular communication and reporting to the committee to ensure that the project is progressing as planned.
Budget overruns	Regular monitoring of the project's progress and costs to ensure that the project remains within budget.

The seventh part of the document discusses the conclusion of the project. The project is expected to be completed within a period of six months. The following table provides a summary of the key milestones and their expected completion dates.

Milestone	Expected Completion Date
Establishment of the new committee	January 15, 1890
Revision of existing regulations	February 15, 1890
Introduction of new procedures	March 15, 1890
Implementation of the new regulations	April 15, 1890
Completion of the project	June 15, 1890

REVISIONS		
BY	DESCRIPTION	DATE

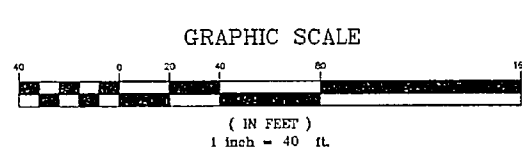
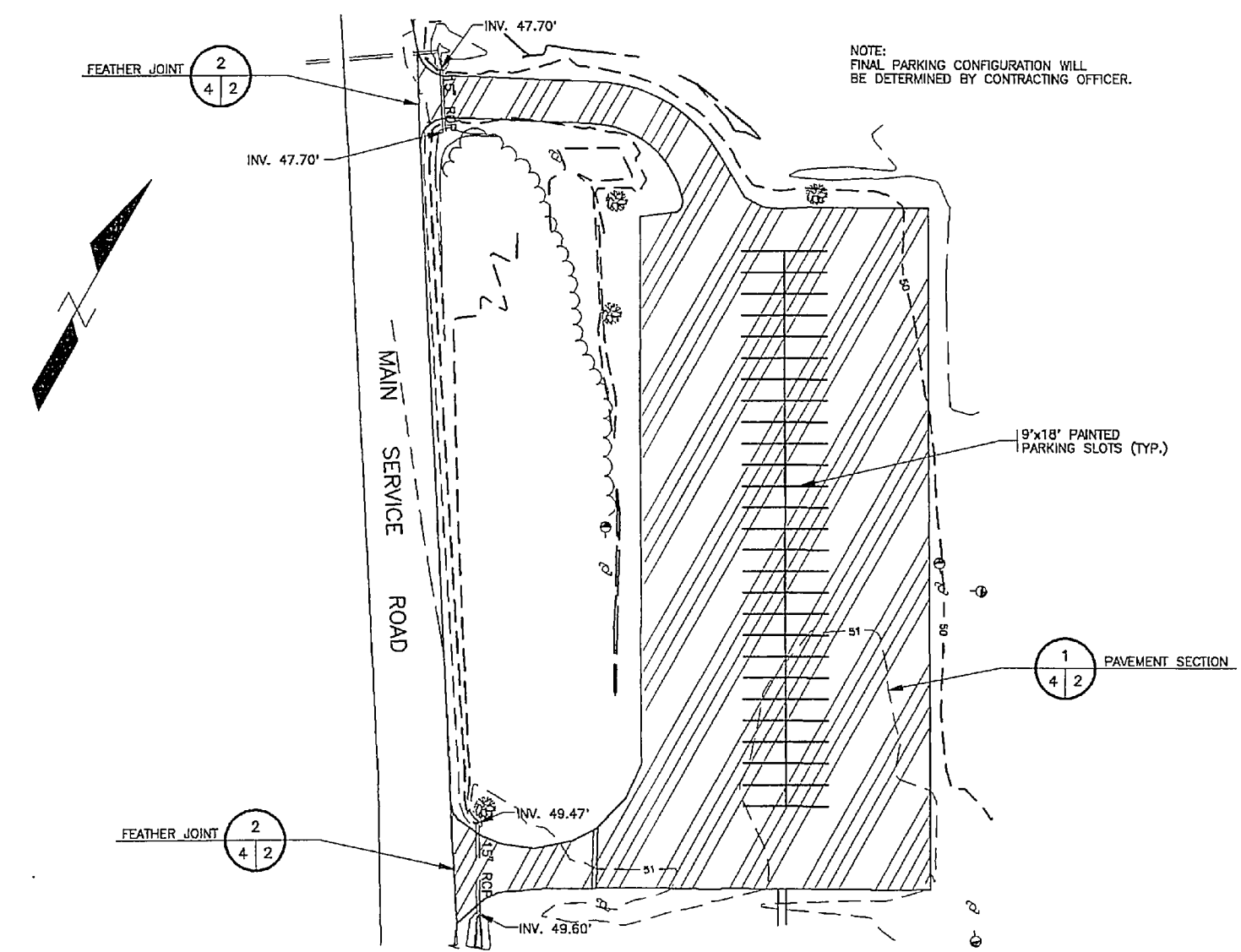

PARKING LOT "C"
1" = 40'

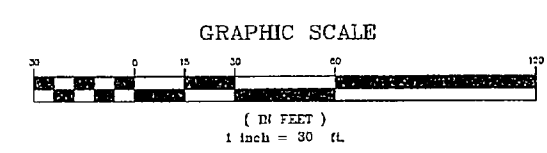
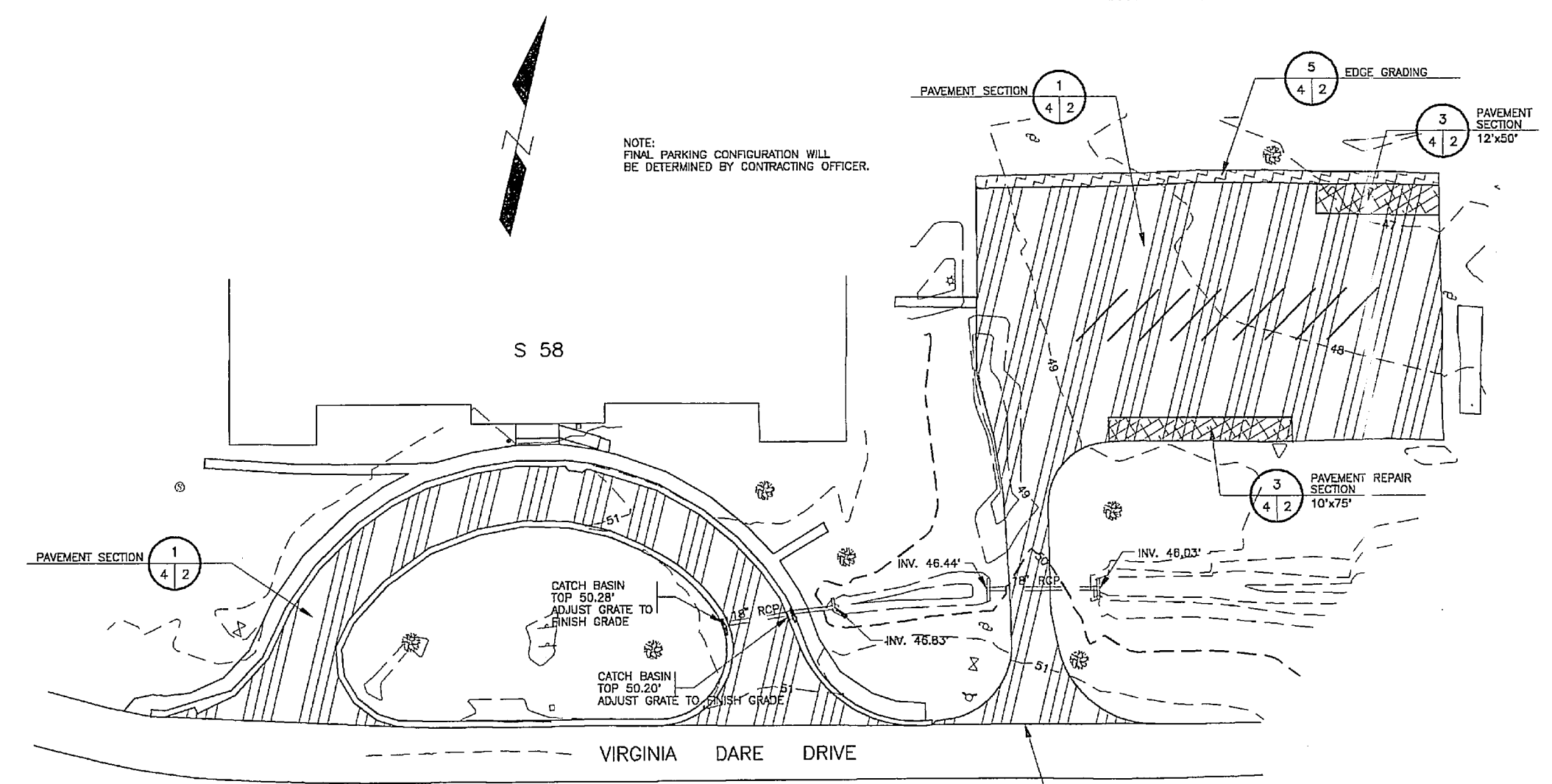

PARKING LOT "E"
1" = 30'

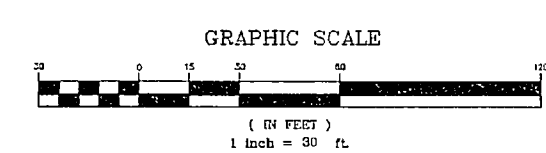
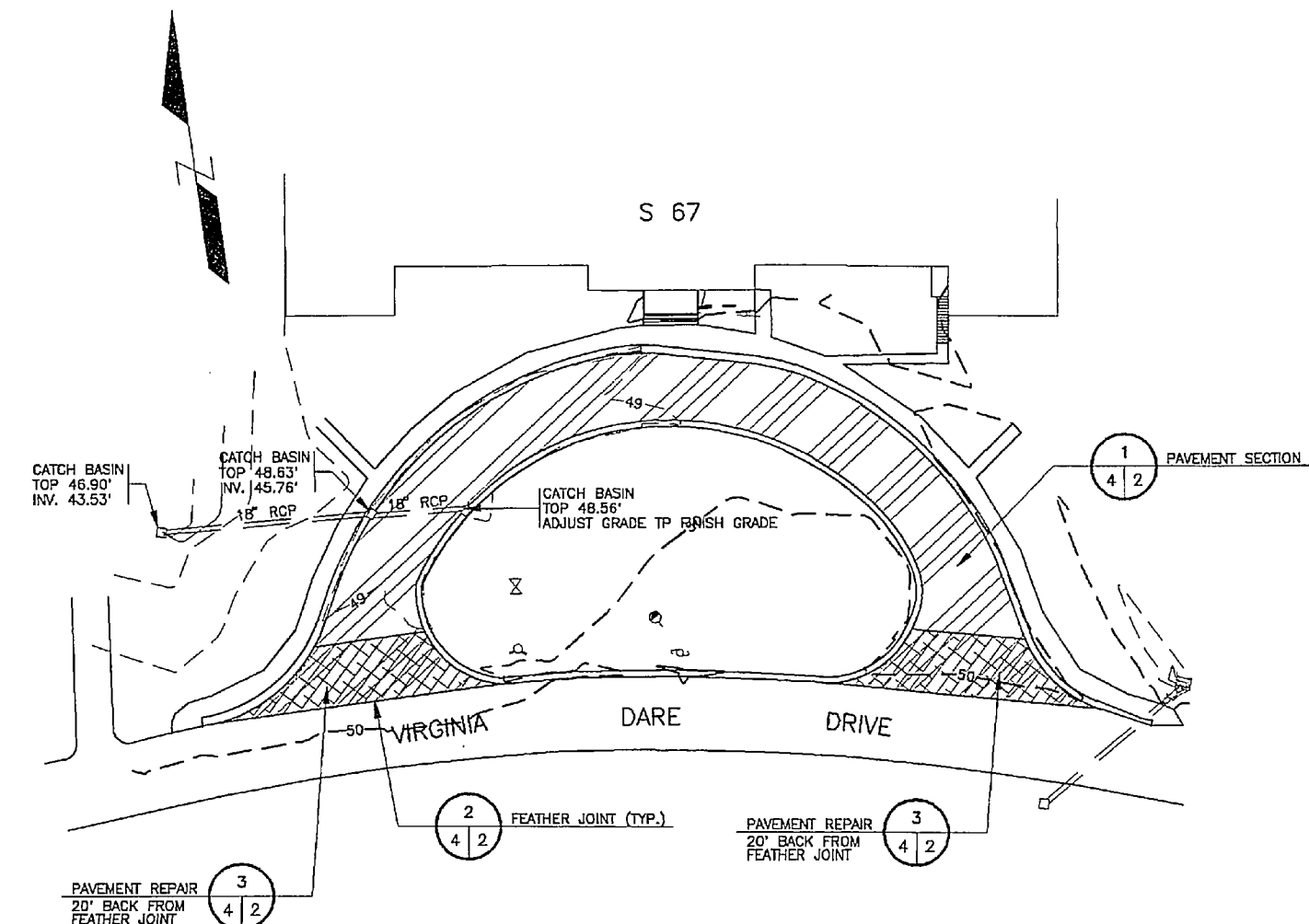

PARKING LOT "D"
1" = 30'

LEGEND

<u>EXISTING</u>		<u>NEW</u>	
— 20 —	RESURFACING AREA	[Hatched Box]	
--- ---	EXIST. CONTOURS		
— — — —	EXIST. STORM SEWER		
⊙	LIGHT POLE		
⊙	UTILITY POLE		
⊙	GUY WIRE		
⊙	TREE		
⊙	WOODS LINE		
⊙	WATER VALVE		
⊙	FIRE HYDRANT		
⊙	SEWER MANHOLE		
⊙	TELEPHONE MANHOLE		
⊙	CATCH BASIN		
⊙	SIGN		
⊙	CURB AND GUTTER		
		[Cross-hatched Box]	PAVEMENT REPAIR
		[Wavy Box]	EDGE GRADING

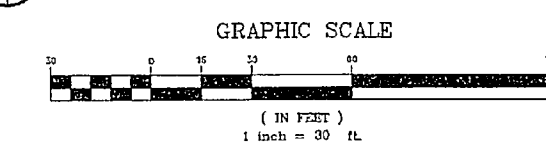
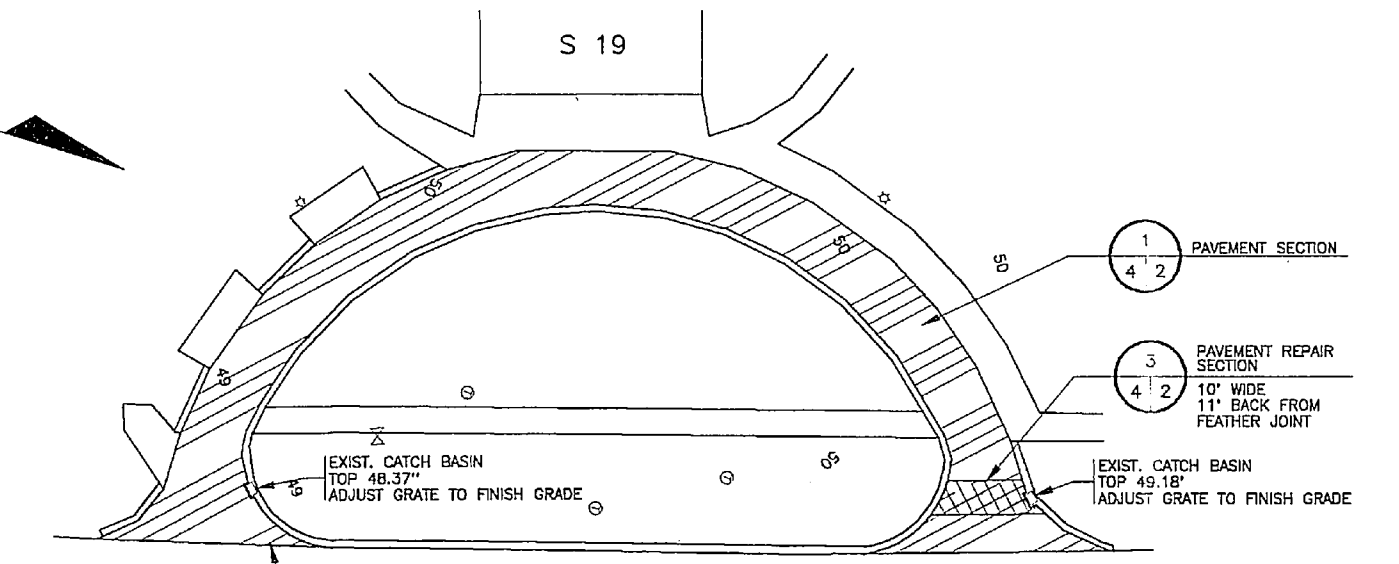

PARKING LOT "F"
1" = 30'

HOBBS, UPCHURCH & ASSOCIATES, P.A. CONSULTING ENGINEERS SOUTHERN PINES, NORTH CAROLINA 28387		C-4	
DEPT OF NAVY MARINE CORPS BASE CAMP LEJEUNE, NORTH CAROLINA		NAVAL FACILITIES ENGINEERING COMMAND	
REPAIR PARKING LOTS 'C', 'D', 'E' AND 'F' REPAIR PARKING LOTS, BASEWIDE			
PROJECT NO.			
DES. GKD	DATE	SIZE F	NAVFAC DRAWING NO. 4360673
DR. EV	DATE	SCALE AS SHOWN	CONSTR. CONTR. NO. N62470-87-D-9301
CHK. DTU	DATE		
SUBMITTED BY	DATE		
DESIGN DR.	DATE		
APPROVED PWO OR CIOCC	DATE		
SATISFACTORY TO	DATE		



REVISIONS			
NO.	DESCRIPTION	DATE	APPROVED

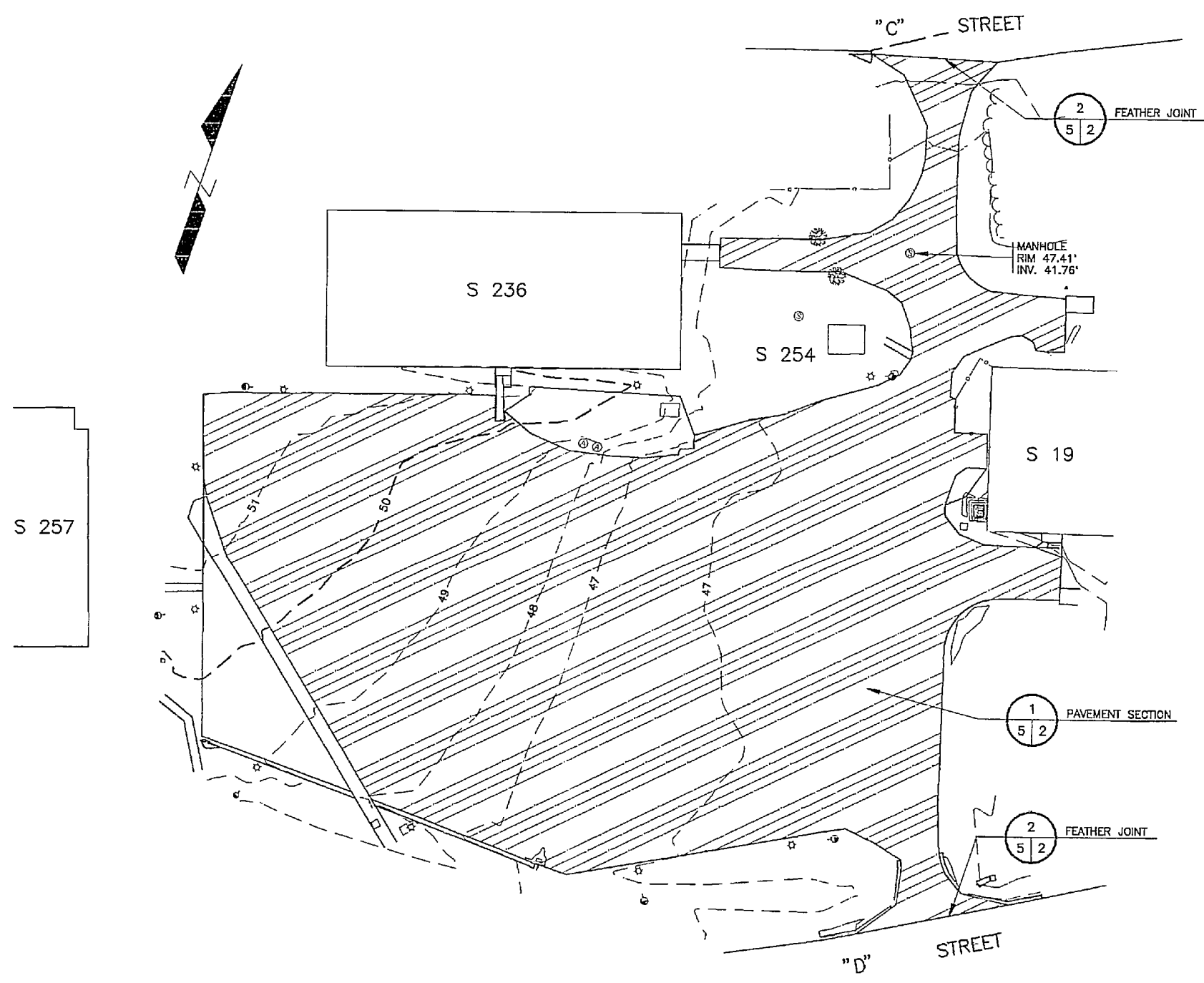

PARKING LOT "G"
1" = 40'

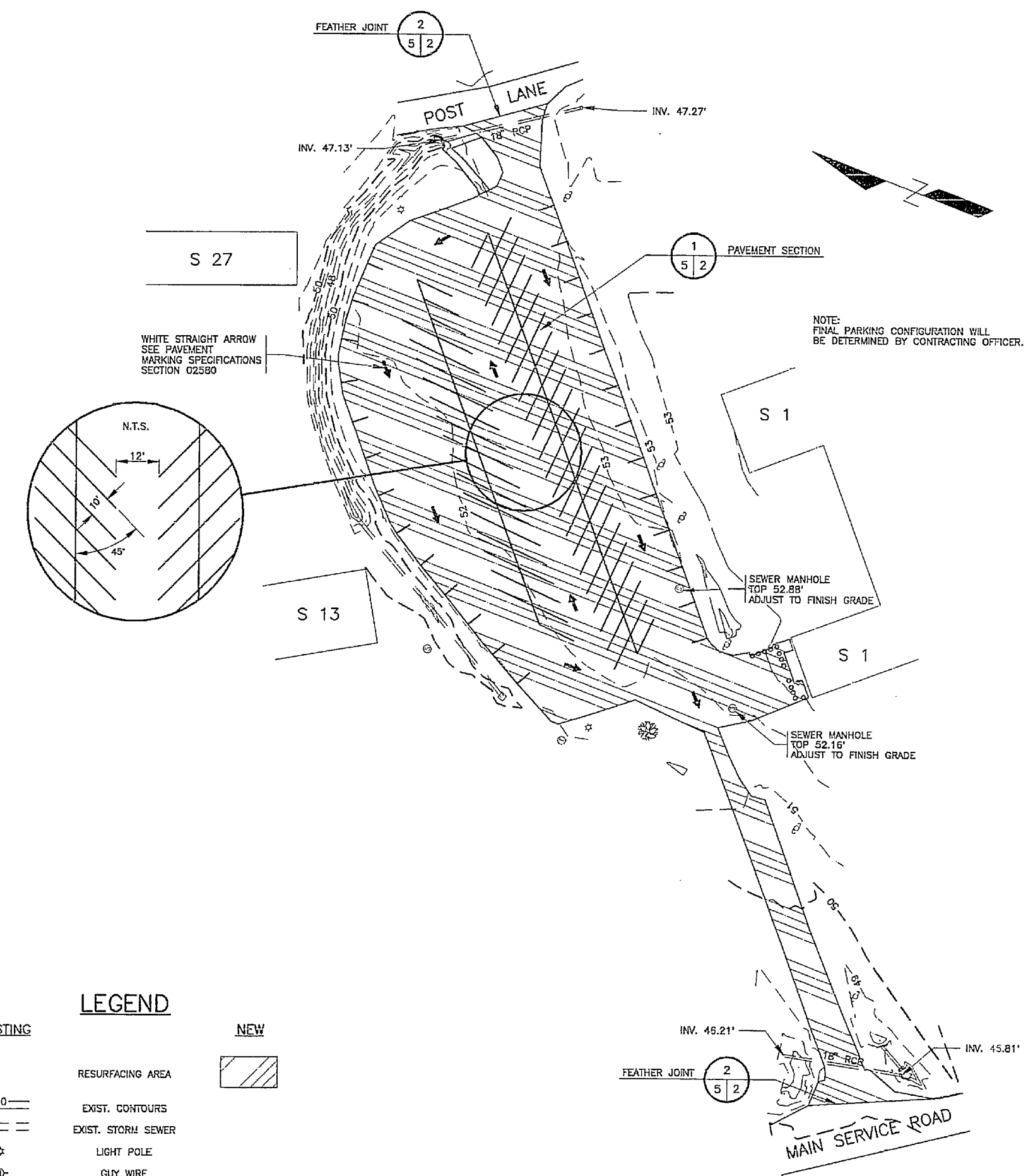
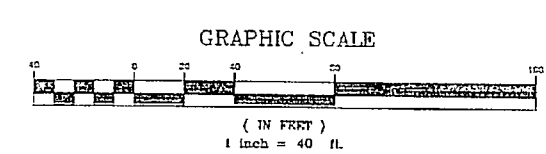

PARKING LOT "H"
1" = 40'

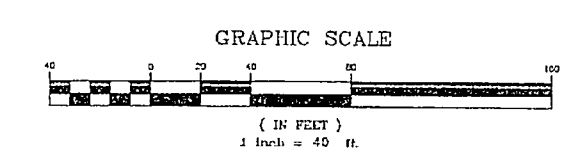

LEGEND

EXISTING		NEW	
—20—	RESURFACING AREA		
---	EXIST. CONTOURS		
---	EXIST. STORM SEWER		
*	LIGHT POLE		
⊕	GUY WIRE		
⊙	TREE		
⊖	WOODS LINE		
⊙	SEWER MANHOLE		
⊙	STEAM MANHOLE		
⊙	TELEPHONE MANHOLE		
○	CHAIN LINK FENCE		
•	BOLLARD		
→	TRAFFIC FLOW		

HOBBS, UPCHURCH & ASSOCIATES, P.A. CONSULTING ENGINEERS SOUTHERN PINES, NORTH CAROLINA 28387		C-5	
DEPT OF NAVY MARINE CORPS BASE CAMP LEJEUNE, NORTH CAROLINA		NAVAL FACILITIES ENGINEERING COMMAND	
REPAIR PARKING LOTS "G" AND "H" REPAIR PARKING LOTS, BASEWIDE			
DESG. GKD DRL. EV CHK. DTU SUBMITTED BY DESIGN DRL.	PROJECT NO.	NAVFAC DRAWING NO. 4360674	SCALE 1/4" = 1'
APPROVED: PWO OR OACC DATE	SIZE F	NAVFAC CONTR. NO. NS2470-87-E-9381	SHEET 5 OF 7
SATISFACTORY TO DATE	SPEC.		



REVISIONS			
SYM	DESCRIPTION	DATE	APPROVED

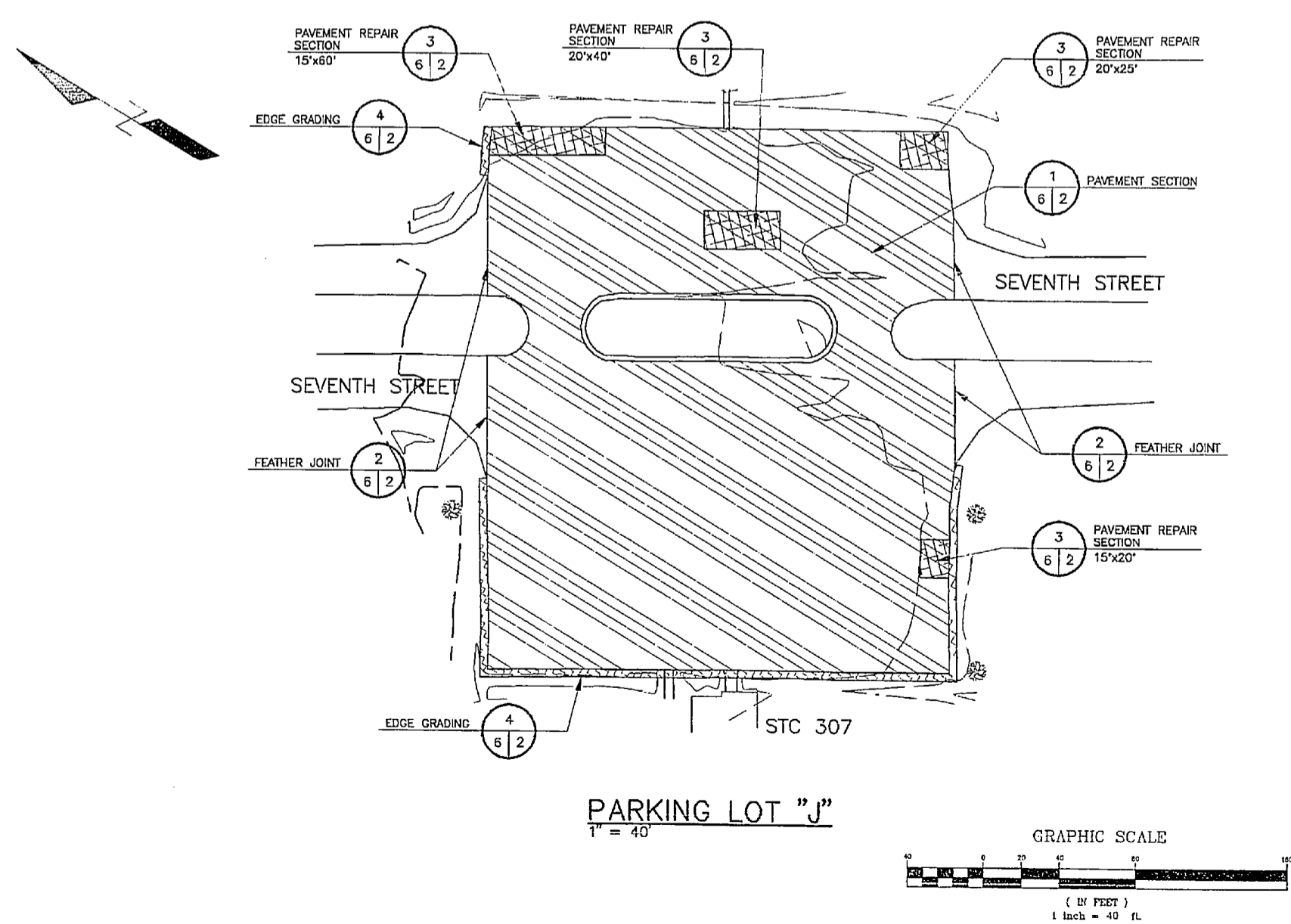
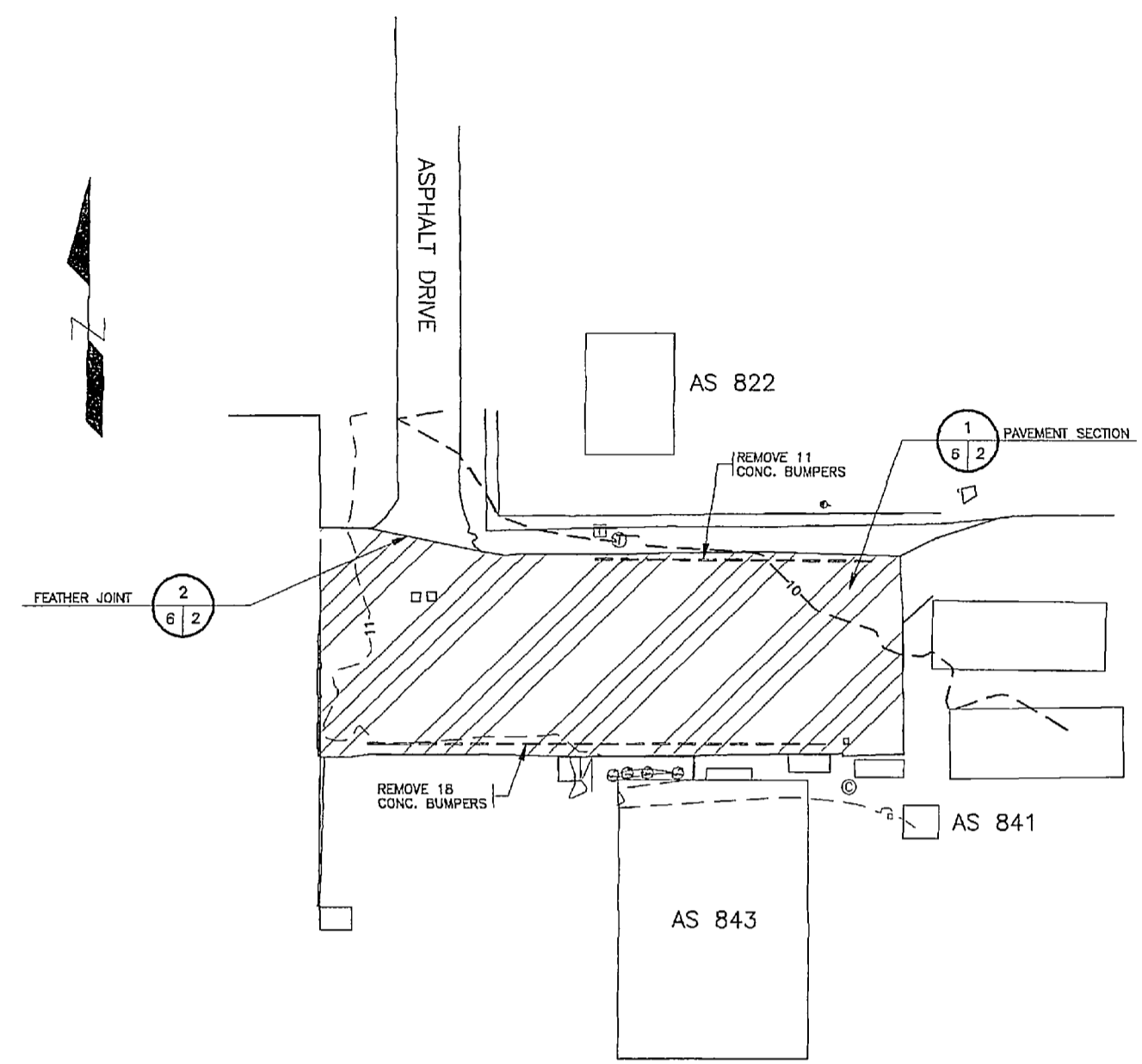
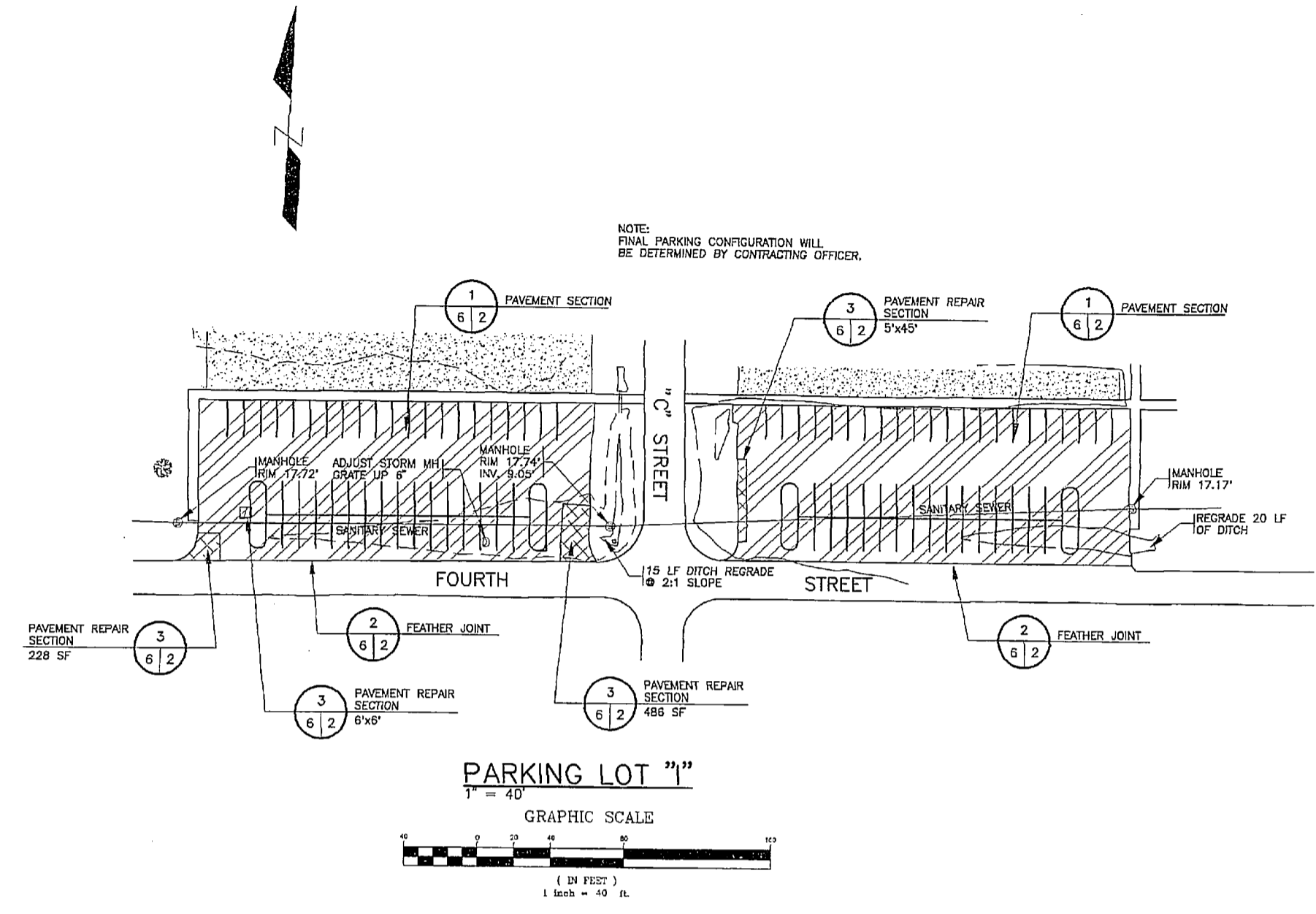

LEGEND

EXISTING	NEW
— 20 —	RESURFACING AREA
— — —	EXIST. CONTOURS
⊗	EXIST. STORM SEWER
⊙	TREE
⊕	SEWER MANHOLE
⊞	TELEPHONE PEDESTAL
⊚	TELEPHONE MANHOLE
▨	PAVEMENT REPAIR
▩	EDGE GRADING

HOBBS, UPCHURCH & ASSOCIATES, P.A. CONSULTING ENGINEERS SOUTHERN PINES, NORTH CAROLINA 28387		C-6	
DEPT OF NAVY MARINE CORPS BASE CAMP LEJEUNE, NORTH CAROLINA		NAVAL FACILITIES ENGINEERING COMMAND CAMP LEJEUNE, NORTH CAROLINA	
REPAIR PARKING LOTS 'I', 'J' AND 'K' REPAIR PARKING LOTS, BASEWIDE		PROJECT NO.	
DESIGNED BY: DRK DRAWN BY: EY CHECKED BY: DTU SUBMITTED BY:	APPROVED: PWD ON 0400 DATE:	SIZE: F CODE IDENT NO.:	NAVFAC DRAWING NO.: 4360675 CONSISTENT WITH NO.: N62470-87-D-9301
GATEFACTORY TO:		SCALE: 1"=40'	SHEET 6 OF 7



REVISIONS			
BY/DATE	DESCRIPTION	DATE	APPROVED

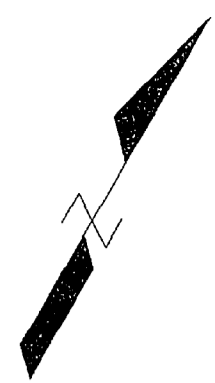

LEGEND

EXISTING	NEW
	RESURFACING AREA
	EXIST. CONTOURS
	EXIST. STORM SEWER
	LIGHT POLE
	UTILITY POLE
	TREE
	SHRUBS
	BOLLARD
	WATER VALVE
	SEWER MANHOLE
	CATCH BASIN
	PAVEMENT REPAIR
	EDGE GRADING
	CONCRETE BUMPERS

NOTE:
FINAL PARKING CONFIGURATION WILL
BE DETERMINED BY CONTRACTING OFFICER.

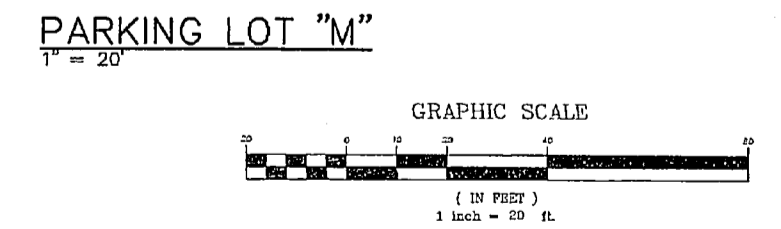
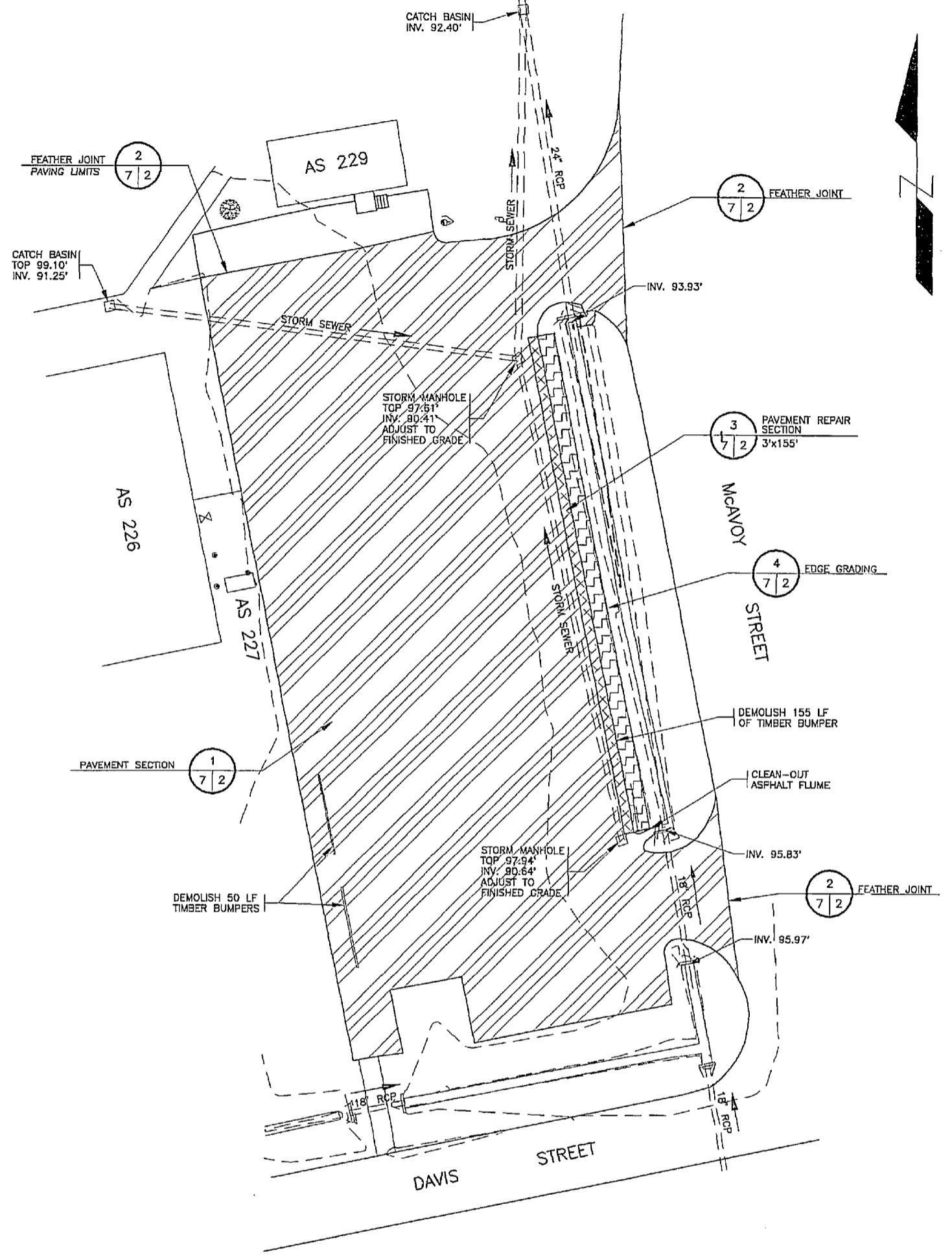
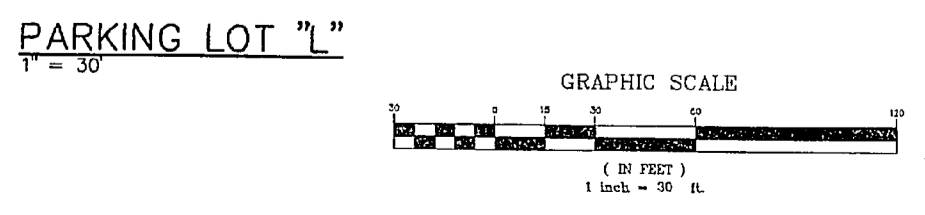
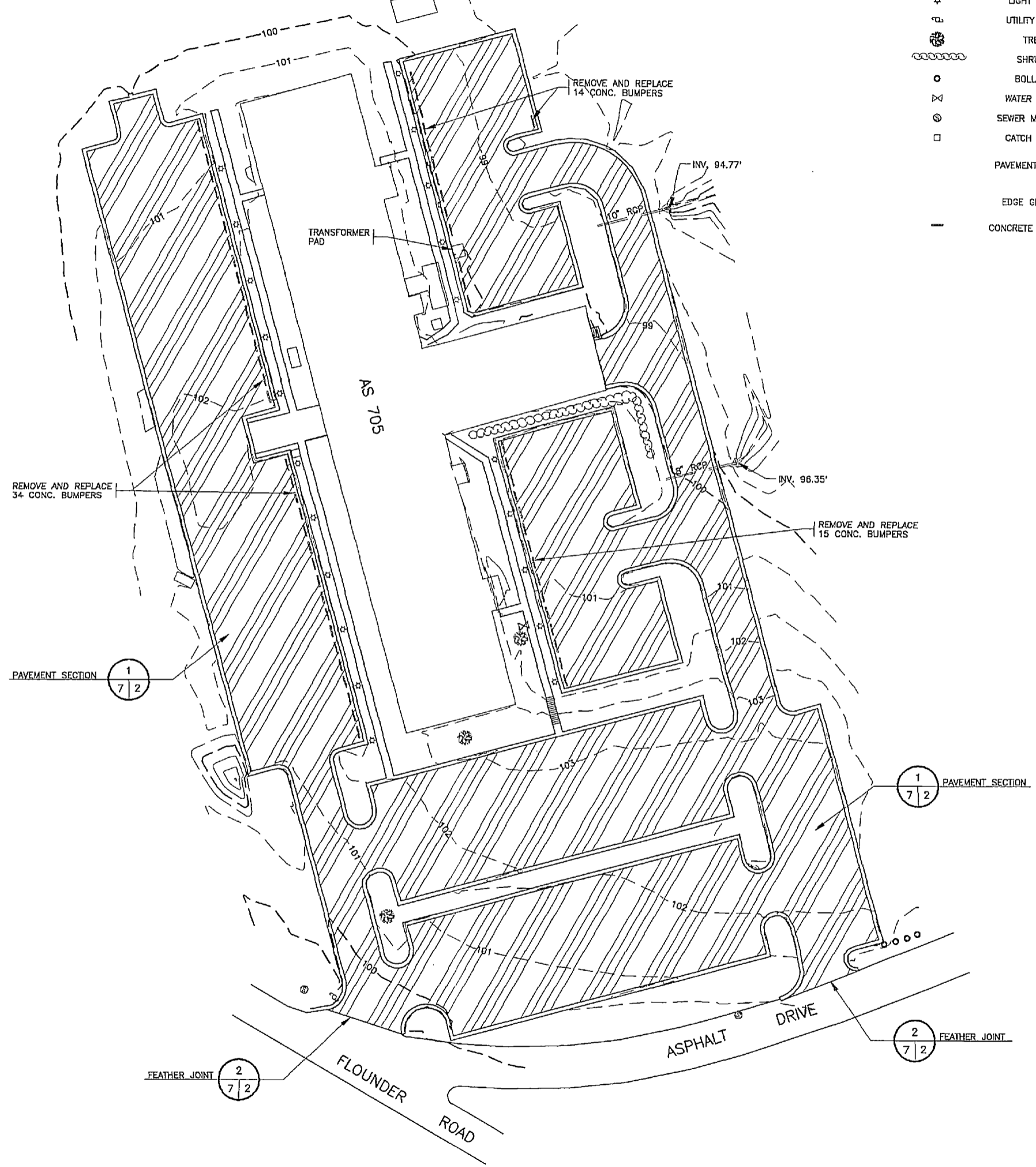

HOBBS, UPCHURCH & ASSOCIATES, P.A. CONSULTING ENGINEERS SOUTHERN PINES, NORTH CAROLINA 28387		C-7
DEPT OF NAVY MARINE CORPS BASE CAMP LEJEUNE, NORTH CAROLINA		NAVAL FACILITIES ENGINEERING COMMAND
REPAIR PARKING LOTS "L" AND "M"		REPAIR PARKING LOTS, BASEWIDE
DESIGNER: GND	DATE:	PROJECT NO.:
DR: EY	DATE:	NAVAC DRAWING NO.:
CHK: DTU	DATE:	4360676
SUBMITTED BY:	DATE:	CONTRACT NO.:
DESIGN DR:	DATE:	N62470-87-0-9301
APPROVED: PWO OR OACC	DATE:	SCALE: AS SHOWN
BATEFACTORY TO:	DATE:	SPEC:
SCALE: AS SHOWN		SHEET 7 OF 7

[The page contains extremely faint and illegible text, likely bleed-through from the reverse side of the document. The text is too light to transcribe accurately.]