

**VALUABLE**

RETURN TO  
PUBLIC WORKS  
OFFICE  
CAMP LEJEUNE  
NORTH CAROLINA

SUBJECT LOCATION FENCE  
SEWERAGE PLANT  
ON SLOW BEACH

FIELD PARTY  
DENNIS IN CHARGE  
\_\_\_\_\_  
INSTRUMENT  
\_\_\_\_\_  
NOTES  
\_\_\_\_\_  
TAPE READ  
\_\_\_\_\_  
TAPE OR ROD  
\_\_\_\_\_  
TAPE OR ROD  
\_\_\_\_\_  
INSTRUMENT NO. \_\_\_\_\_  
TAPE NO. \_\_\_\_\_

WEATHER  
CLEAR \_\_\_\_\_  
CLOUDY \_\_\_\_\_  
WINDY \_\_\_\_\_  
RAIN \_\_\_\_\_  
FAIR \_\_\_\_\_  
SNOW \_\_\_\_\_  
HOT \_\_\_\_\_  
MODERATE \_\_\_\_\_  
COLD \_\_\_\_\_  
FOG \_\_\_\_\_  
FIGURED BY \_\_\_\_\_  
NOTES CHECKED BY \_\_\_\_\_  
PLOTTED BY \_\_\_\_\_

FILE No. 221-5  
FLDR. No. \_\_\_\_\_  
SHEET 1 of 1  
DATE 12-12 1955

Quad. No. \_\_\_\_\_

STATION	DIST.	ANGLE ° ' "	+	H. I. BEARING	VER: ANG. DIFF.	ELEVATION
---------	-------	----------------	---	------------------	--------------------	-----------

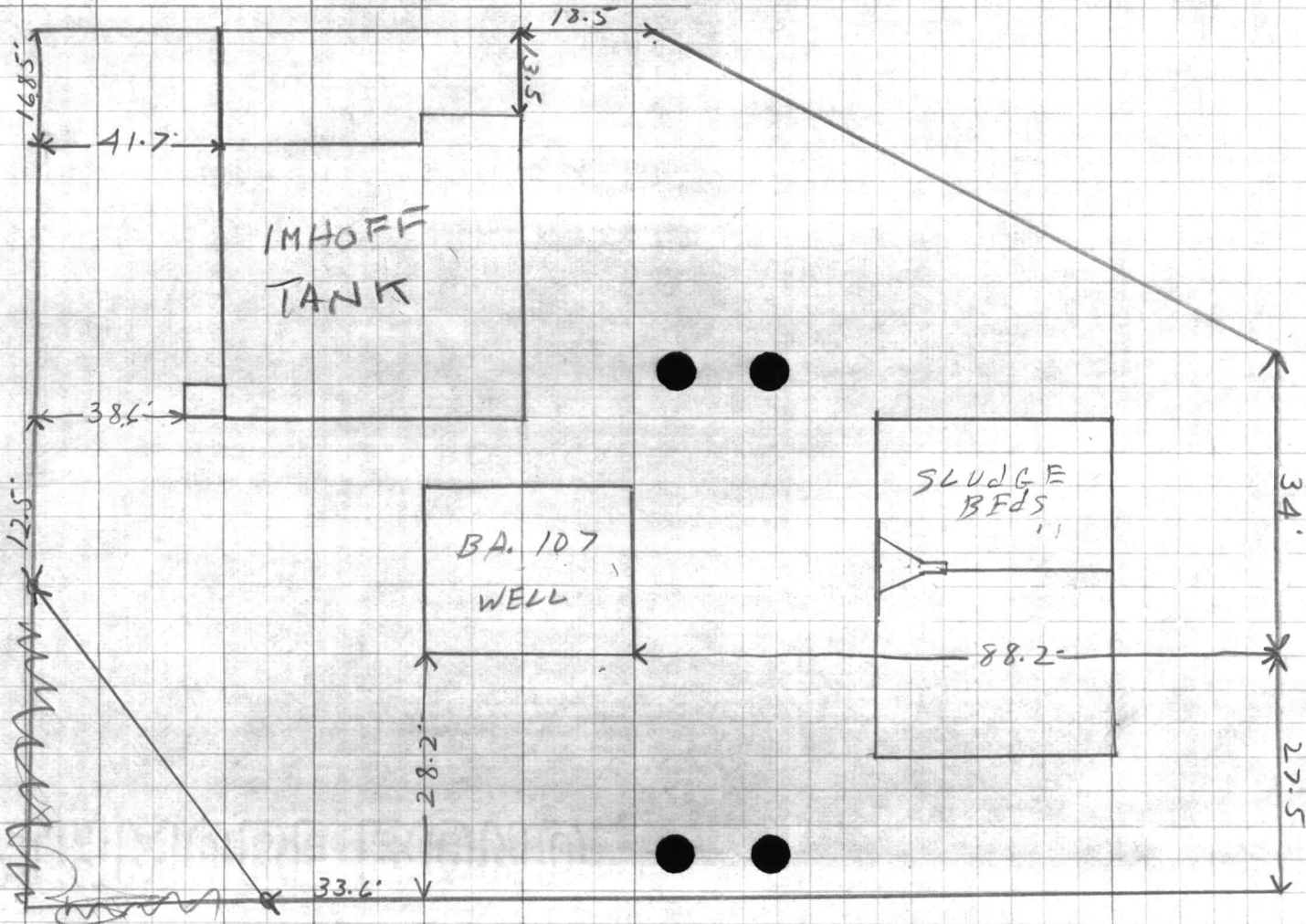

FACING ST

X

VALUABLE  
NO. 888 TO  
PUBLIC WORKS  
OFFICE  
CAMP LEWIS  
MOUNTAIN

STATION

SUBJECT

H. J. LEE AND  
DEPARTMENT

WEATHER  
WIND  
TEMPERATURE  
HUMIDITY  
MOON  
RAIN  
SNOW  
FOG  
MIST  
DUST  
SMOG  
HAZE  
MIST  
SMOG  
HAZE

WIND  
TEMPERATURE  
HUMIDITY  
MOON  
RAIN  
SNOW  
FOG  
MIST  
DUST  
SMOG  
HAZE  
MIST  
SMOG  
HAZE

567163

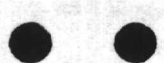

**VALUABLE**

RETURN TO  
PUBLIC WORKS  
OFFICE  
CAMP LEJEUNE  
NORTH CAROLINA

SUBJECT LOCATION FOR  
GARBAGE HOUSE MESS  
HALL ONSLOW BEACH

FIELD PARTY  
DEWINS IN CHARGE  
\_\_\_\_ INSTRUMENT  
\_\_\_\_ NOTES  
\_\_\_\_ TAPE READ  
\_\_\_\_ TAPE OR ROD  
\_\_\_\_ TAPE OR ROD  
\_\_\_\_ INSTRUMENT NO.  
\_\_\_\_ TAPE NO.

WEATHER  
CLEAR \_\_\_\_\_  
CLOUDY \_\_\_\_\_  
WINDY \_\_\_\_\_  
RAIN \_\_\_\_\_  
FAIR \_\_\_\_\_  
SNOW \_\_\_\_\_  
HOT \_\_\_\_\_  
MODERATE \_\_\_\_\_  
COLD \_\_\_\_\_  
FOG \_\_\_\_\_  
FIGURED BY \_\_\_\_\_  
NOTES CHECKED BY \_\_\_\_\_  
PLOTTED BY \_\_\_\_\_  
FILE No. 221-5  
FLDR. No. \_\_\_\_\_  
SHEET 10/1  
DATE 3-15 19\_\_\_\_  
Quad. No. \_\_\_\_\_

STATION	DIST.	ANGLE " "	+	H. I. BEARING	VER. ANG. DIFF.	ELEVATION
---------	-------	--------------	---	------------------	--------------------	-----------

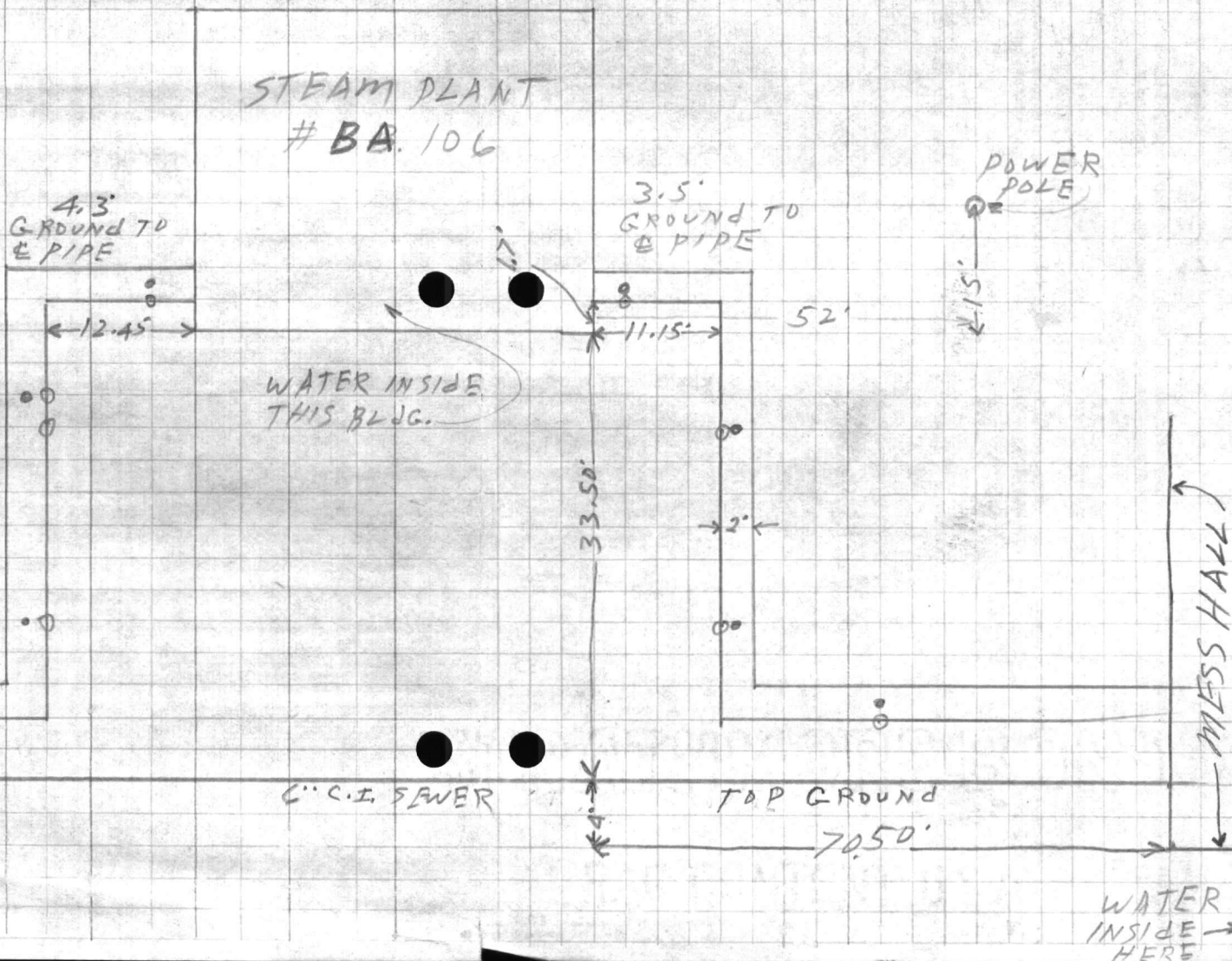

VALUABLE  
RETURN TO  
PUBLIC WORKS  
OFFICE  
CAMP LEVINE  
NORTH CAROLINA

SUBJECT

STATION DIST.

ANGLE

BEARING

H. L. V. H. AND ELEVATION  
DIP

FIELD PARTY  
IN CHARGE  
IM. NUMBER  
NOTES  
TAPES ROAD  
TYPE OF ROD  
TAPES OR P.C.  
INSTRUMENT NO.  
TAPES NO.

WEATHER  
CLEAR  
CLOUDY  
WINDY  
RAIN  
FOG  
MIST  
THUNDER  
NOTES CHECKED BY  
RECORDED BY  
DATE

DATE  
SHEET  
BOOK NO.

ORIGIN

5.12.2  
11.11.11  
11.11.11  
11.11.11  
11.11.11

**VALUABLE**

RETURN TO  
PUBLIC WORKS  
OFFICE  
CAMP LEJEUNE  
NORTH CAROLINA

SUBJECT

Test boring #1 between  
Bldg # BA 100 & Water tank  
Onslow Beach

FIELD PARTY

*Murphy* IN CHARGE  
INSTRUMENT  
NOTES  
TAPE READ  
TAPE OR ROD  
TAPE OR ROD  
INSTRUMENT NO.  
TAPE NO.

WEATHER

CLEAR  
CLOUDY  
WINDY  
RAIN  
FAIR  
SNOW  
HOT  
MODERATE  
COLD  
FOG

FILE No. 221-5

FLDR. No. \_\_\_\_\_

SHEET 2 of 2

DATE 10-13 1953

Quad. No. \_\_\_\_\_

STATION	DIST.	ANGLE ° ' "	+	H. I. BEARING	VER. ANG. DIFF.	ELEVATION
---------	-------	----------------	---	------------------	--------------------	-----------

*66.8 ft.*  
4.8 0 to 3.5' Coarse sand  
3.5 to 5.0' Rotted vegetation & sand  
5.0 to 10.2 Coarse sand  
-5.4 10.2' Shell rock

Water table - 2, 3'

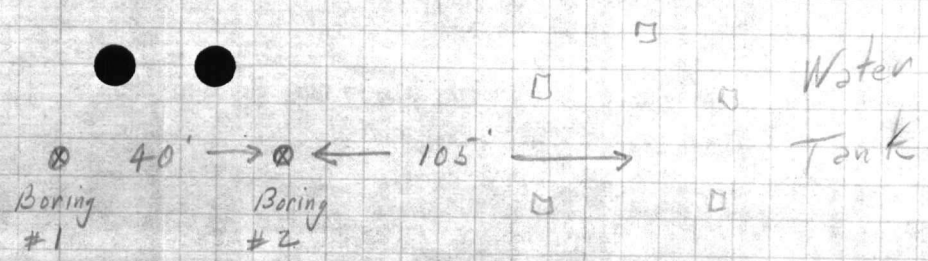
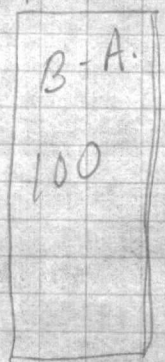

VALUABLE

FIELD NO. \_\_\_\_\_  
DATE \_\_\_\_\_  
LOCALITY \_\_\_\_\_

STATION DIR. \_\_\_\_\_

ANGLE \_\_\_\_\_

B.T. \_\_\_\_\_

DATE \_\_\_\_\_  
ELEVATION \_\_\_\_\_

TABULARY

INSTRUMENT NO. \_\_\_\_\_

TABLE OF FIGS. \_\_\_\_\_

TABLE OF DATA \_\_\_\_\_

NAME \_\_\_\_\_

NO. \_\_\_\_\_

IN CHARGE \_\_\_\_\_

FIELD PARTY

WEATHER

CLEAR \_\_\_\_\_  
CLOUDY \_\_\_\_\_  
HOT \_\_\_\_\_  
MODERATE \_\_\_\_\_  
WINDY \_\_\_\_\_  
RAIN \_\_\_\_\_  
DRY \_\_\_\_\_  
FOG \_\_\_\_\_  
MOON \_\_\_\_\_  
NO. OF STARS \_\_\_\_\_  
P. OF STARS \_\_\_\_\_

STUDY NO. \_\_\_\_\_

1

1

1

1

1

1

1

1

1

1

1

1

1

1

1

1

1

1

1

1

1

1

1

1

1

1

1

1

1

1

1

1

**VALUABLE**

SUBJECT

Test boring #2 between  
Bldg # BA-100 & Water  
Tank - Onslow Beach

RETURN TO  
PUBLIC WORKS  
OFFICE  
CAMP LEJEUNE  
NORTH CAROLINA

**FIELD PARTY**

*Murphy*  
IN CHARGE  
INSTRUMENT  
NOTES  
TAPE READ  
TAPE OR ROD  
TAPE OR ROD  
INSTRUMENT NO.  
TAPE NO.

**WEATHER**

CLEAR  
CLOUDY  
WINDY  
RAIN  
FAIR  
SNOW  
HOT  
MODERATE  
COLD  
FOG

FILE No. \_\_\_\_\_

FLDR. No. \_\_\_\_\_

FIGURED BY \_\_\_\_\_ SHEET 1082

NOTES CHECKED BY \_\_\_\_\_

PLOTTED BY \_\_\_\_\_ DATE 10-13-1953

Quad. No. \_\_\_\_\_

STATION	DIST.	ANGLE ° ' "	+	H. I. BEARING	VER: ANG. DIFF.	ELEVATION
---------	-------	----------------	---	------------------	--------------------	-----------

<i>old Defo 3.6</i>						Water table - 2.3'
0 to 3'						coarse sand
3 to 5'						rotted vegetation & sand
5 to 10.6'						Coarse sand
10.6						shell rock
-7.0						







**VALUABLE**SUBJECT Test borings - proposed  
storage Building - Onslow BeachRETURN TO  
PUBLIC WORKS  
OFFICE  
CAMP LEJEUNE  
NORTH CAROLINA

## FIELD PARTY

Murphy IN CHARGE  
INSTRUMENT \_\_\_\_\_  
NOTES \_\_\_\_\_  
TAPE READ \_\_\_\_\_  
TAPE OR ROD \_\_\_\_\_  
TAPE OR ROD \_\_\_\_\_  
INSTRUMENT NO. \_\_\_\_\_  
TAPE NO. \_\_\_\_\_

## WEATHER

CLEAR \_\_\_\_\_  
CLOUDY \_\_\_\_\_  
WINDY \_\_\_\_\_  
RAIN \_\_\_\_\_  
FAIR \_\_\_\_\_  
SNOW \_\_\_\_\_  
HOT \_\_\_\_\_  
MODERATE \_\_\_\_\_  
COLD \_\_\_\_\_  
FOG \_\_\_\_\_FILE No. 221-5

FLDR. No. \_\_\_\_\_

FIGURED BY \_\_\_\_\_ SHEET 105-1

NOTES CHECKED BY \_\_\_\_\_

PLOTTED BY \_\_\_\_\_ DATE 5-8 1952

Quad. No. \_\_\_\_\_

STATION	DIST.	ANGLE ° ' "	+	H. I. BEARING	VER: ANG. DIFF.	ELEVATION
---------	-------	----------------	---	------------------	--------------------	-----------

Test Boring "A" From 0 to 1' shell rock, from 1' to 7' coarse sand - (water table at 3')

Test Boring "B" From 0 to 6" top soil from 6" to 5' coarse sand, from 5' to 6' fine sand and rotted vegetation. (water table = 4')

Test Boring "C" From 0 to 4' coarse sand, from 4' to 5' fine sand, from 5' to 7' fine sand and rotted vegetation (water table = 5')

Test Boring "D" From 0 to 5' coarse sand, from 5' to 6' fine sand. (water table = 4')  
(Test Boring A = 0+00)Test Boring "A<sup>1</sup>" From 0 to 6" top soil, 6" to 6' coarse sand. (water table 4') = 0+70Test Boring "A<sup>2</sup>" From 0 to 6" top soil, from 6" to 4' coarse sand. (water table 4') = 0+78Test Boring "A<sup>3</sup>" from 0 to 4' coarse sand, from 4' to 5' fine sand, from 5' to 7' fine sand & rotted vegetation (water table 4') = 0+92Test Boring "A<sup>4</sup>" from 0 to 5.5' coarse sand, from 5.5' to 6' coarse sand with traces of rotted vegetation - indicative of edge of marsh. (water table 4') 0+85'

RECEIVED  
FBI  
NOV 10 1964

RECEIVED  
FBI  
NOV 10 1964

STATION - DIST. - OFFICE

NOV 10 1964

RECEIVED  
FBI  
NOV 10 1964

NOV 10 1964

FIELD PARTY

RECEIVED

NOV 10 1964

NOV 10 1964

NOV 10 1964

NOV 10 1964

NOV 10 1964

NOV 10 1964

NOV 10 1964

NOV 10 1964

NOV 10 1964

NOV 10 1964

NOV 10 1964

NOV 10 1964

NOV 10 1964

NOV 10 1964

NOV 10 1964

NOV 10 1964

NOV 10 1964

NOV 10 1964

NOV 10 1964

NOV 10 1964

NOV 10 1964

NOV 10 1964

NOV 10 1964

NOV 10 1964

NOV 10 1964

NOV 10 1964

NOV 10 1964

NOV 10 1964

NOV 10 1964

NOV 10 1964

NOV 10 1964

NOV 10 1964

NOV 10 1964

NOV 10 1964

NOV 10 1964

NOV 10 1964

NOV 10 1964

NOV 10 1964

NOV 10 1964

NOV 10 1964

NOV 10 1964

NOV 10 1964

NOV 10 1964

NOV 10 1964

NOV 10 1964

NOV 10 1964

NOV 10 1964

NOV 10 1964

NOV 10 1964

NOV 10 1964

NOV 10 1964

NOV 10 1964

NOV 10 1964

NOV 10 1964

NOV 10 1964

NOV 10 1964

NOV 10 1964

NOV 10 1964

NOV 10 1964

NOV 10 1964

**VALUABLE**

SUBJECT TEST Boreing site  
Elev.<sup>s</sup> AND description of  
EXISTING B.M. AT onslow  
Beach proposed TREATMENT  
PLANT Site  
on Beach

RETURN TO  
 PUBLIC WORKS  
 OFFICE  
 CAMP LEJEUNE  
 NORTH CAROLINA

## FIELD PARTY

KELLY IN CHARGE  
 \_\_\_\_\_ INSTRUMENT  
 \_\_\_\_\_ NOTES  
 \_\_\_\_\_ TAPE READ  
 \_\_\_\_\_ TAPE OR ROD  
 \_\_\_\_\_ TAPE OR ROD  
 \_\_\_\_\_ INSTRUMENT NO.  
 \_\_\_\_\_ TAPE NO.

## WEATHER

CLEAR  
 CLOUDY  
 WINDY  
 RAIN  
 FAIR

SNOW  
 HOT  
 MODERATE  
 COLD  
 FOG

FILE No. 2215

FLDR. No. \_\_\_\_\_

FIGURED BY \_\_\_\_\_ SHEET 1-0 of 5NOTES CHECKED BY \_\_\_\_\_ DATE 8-19 1954

PLOTTED BY \_\_\_\_\_

Quad. No. \_\_\_\_\_

STATION	DIST.	ANGLE		H. I. BEARING	VER. ANG. DIFF.	ELEVATION
		'	"			
B.M.						8.49
		1.52	10.01			
			10.0			
TEST "A"				4.6		5.4
TEST "B"				4.5		5.5
TEST "C"				5.5		4.5
TEST "D"				4.8		5.2
TEST "E"				5.0		5.0
TEST "F"				5.3		4.7
TEST "G"				5.3		4.7
TEST "H"				5.6		4.4
B.M.				1.52		8.49

Top of Bolt in Base of Water Tank.  
 Bolt being nearest to Entrance  
 to Steps but NOT under steps.

VALUABLE  
RETURN TO  
POST OFFICE  
SAN FRANCISCO  
CALIFORNIA

U.S. No. \_\_\_\_\_  
POSTAGE PAID BY ADDRESSEE  
NO. \_\_\_\_\_  
POST OFFICE \_\_\_\_\_  
CITY \_\_\_\_\_  
STATE \_\_\_\_\_  
ZIP \_\_\_\_\_  
NAME \_\_\_\_\_  
ADDRESS \_\_\_\_\_  
CITY \_\_\_\_\_  
STATE \_\_\_\_\_  
ZIP \_\_\_\_\_  
NAME \_\_\_\_\_  
ADDRESS \_\_\_\_\_  
CITY \_\_\_\_\_  
STATE \_\_\_\_\_  
ZIP \_\_\_\_\_



**VALUABLE**

SUBJECT TEST BORINGS AT  
ONSLOW BEACH proposed water  
TREATMENT PLANT site.

RETURN TO  
PUBLIC WORKS  
OFFICE  
CAMP LEJEUNE  
NORTH CAROLINA

FIELD PARTY

Kellum IN CHARGE  
\_\_\_\_ INSTRUMENT  
\_\_\_\_ NOTES  
\_\_\_\_ TAPE READ  
\_\_\_\_ TAPE OR ROD  
\_\_\_\_ TAPE OR ROD  
\_\_\_\_ INSTRUMENT NO.  
\_\_\_\_ TAPE NO.

WEATHER

CLEAR  
CLOUDY  
WINDY  
RAIN  
FAIR

SNOW  
HOT  
MODERATE  
COLD  
FOG

FILE No. \_\_\_\_\_

FLDR. No. \_\_\_\_\_

FIGURED BY \_\_\_\_\_ SHEET 2 of 5  
NOTES CHECKED BY \_\_\_\_\_  
PLOTTED BY \_\_\_\_\_ DATE 8-19 1954

Quad. No. \_\_\_\_\_

STATION	DIST.	ANGLE ° ' "	+	H. I. BEARING	VER. ANG. DIFF.	ELEVATION
---------	-------	----------------	---	------------------	--------------------	-----------

TEST HOLE "A"

5.4

Ground Elev.

3.9

Area of sand overlay

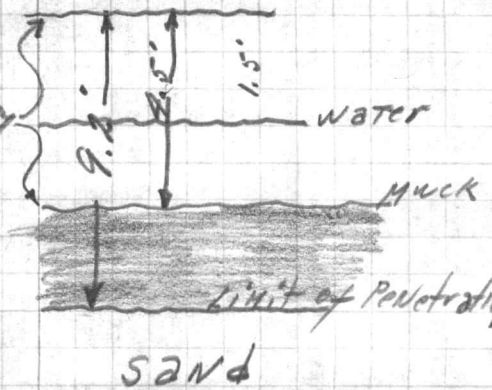

TEST HOLE "B"

5.5

Ground Elev.

3.6

Area of sand overlay

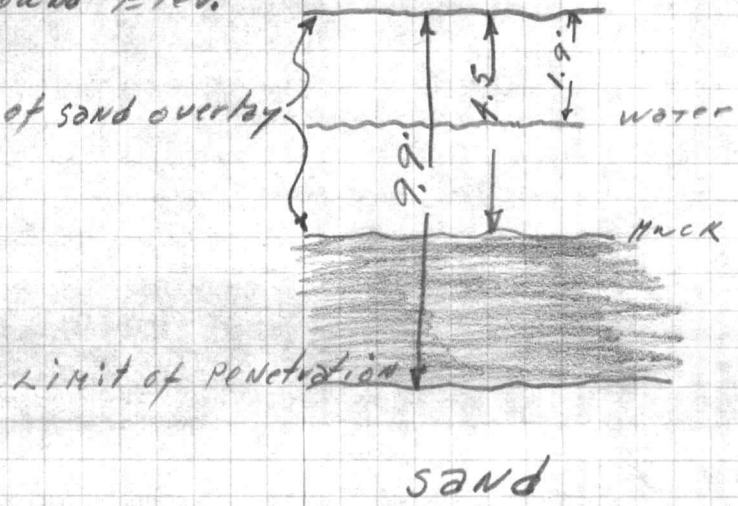

UNITED STATES  
NORTH DAKOTA

WEATHER  
STATION  
NO. 1111  
ELEVATION  
1000  
LATITUDE  
46 30 N  
LONGITUDE  
100 30 W

DATE  
TIME  
WIND  
TEMP  
REL. HUM.

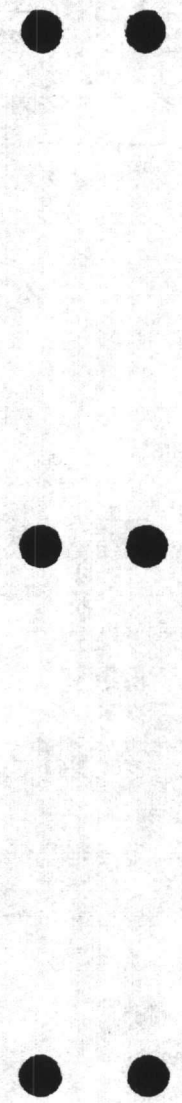

**VALUABLE**

SUBJECT TEST BORINGS AT  
BEACH CONTD.

RETURN TO  
PUBLIC WORKS  
OFFICE  
CAMP LEJEUNE  
NORTH CAROLINA

**FIELD PARTY**

\_\_\_\_\_  
IN CHARGE  
\_\_\_\_\_  
INSTRUMENT  
\_\_\_\_\_  
NOTES  
\_\_\_\_\_  
TAPE READ  
\_\_\_\_\_  
TAPE OR ROD  
\_\_\_\_\_  
TAPE OR ROD  
\_\_\_\_\_  
INSTRUMENT NO.  
\_\_\_\_\_  
TAPE NO.

**WEATHER**

CLEAR  
CLOUDY  
WINDY  
RAIN  
FAIR

SNOW  
HOT  
MODERATE  
COLD  
FOG

FILE No. \_\_\_\_\_

FLDR. No. \_\_\_\_\_

SHEET 3-0 of 5

DATE 8-19 1954

FIGURED BY \_\_\_\_\_  
NOTES CHECKED BY \_\_\_\_\_  
PLOTTED BY \_\_\_\_\_  
Quad. No. \_\_\_\_\_

STATION	DIST.	ANGLE ° ' "	+	H. I. BEARING	VER. ANG. DIFF.	ELEVATION
TEST Hole "C"						4.5
					3.2	
TEST Hole "D"						5.2
					2.7	

Ground Elev.

Area of sand  
overlay

Water

MUCK

Limit of Penetration

sand

Ground Elev.

Area of sand overlay

Water

MUCK

Limit of Penetration

sand

VALLEY  
MOUNTAIN  
MOUNTAIN

WIND WEATHER  
DIRECTION  
SPEED  
TEMPERATURE  
HUMIDITY  
PRESSURE  
WIND WEATHER  
DIRECTION  
SPEED  
TEMPERATURE  
HUMIDITY  
PRESSURE

STATION  
ELEVATION  
MOUNTAIN

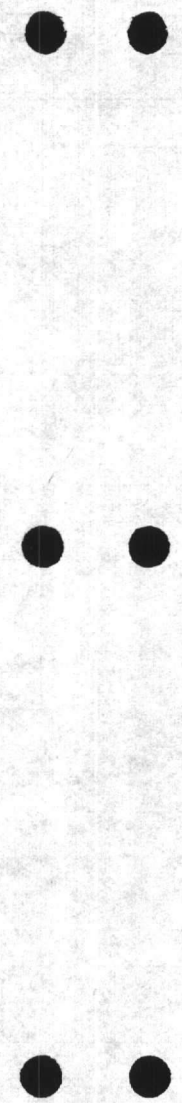



**VALUABLE**

SUBJECT Test Borings  
contd.

RETURN TO  
PUBLIC WORKS  
OFFICE  
CAMP LEJEUNE  
NORTH CAROLINA

**FIELD PARTY**

\_\_\_\_\_  
IN CHARGE  
\_\_\_\_\_  
INSTRUMENT  
\_\_\_\_\_  
NOTES  
\_\_\_\_\_  
TAPE READ  
\_\_\_\_\_  
TAPE OR ROD  
\_\_\_\_\_  
TAPE OR ROD  
\_\_\_\_\_  
STRUMENT NO.  
\_\_\_\_\_  
TAPE NO.

**WEATHER**

CLEAR  
CLOUDY  
WINDY  
RAIN  
FAIR  
SNOW  
HOT  
MODERATE  
COLD  
FOG

FILE No. \_\_\_\_\_  
FLDR. No. \_\_\_\_\_  
SHEET 4-0 of 5  
DATE 8-12-1954

FIGURED BY \_\_\_\_\_  
NOTES CHECKED BY \_\_\_\_\_  
PLOTTED BY \_\_\_\_\_  
Quad. No. \_\_\_\_\_

STATION	DIST.	ANGLE " "	+	H. I. BEARING	VER: ANG. DIFF.	ELEVATION
TEST Hole "E"						5.0
					2.5	
TEST Hole "F"						4.7
					1.2	

Ground Elev.

Area of sand overlay

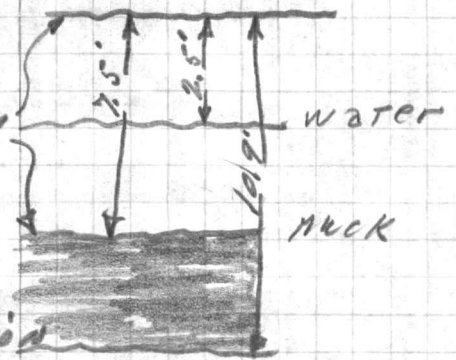

Limit of Penetration

Ground Elev.

Area of sand overlay

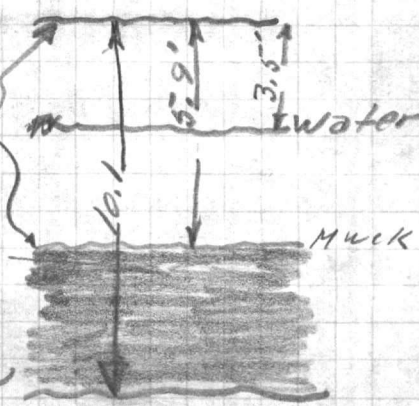

Limit of Penetration

sand



**VALUABLE**

SUBJECT TEST BORINGS  
CONTD.

RETURN TO  
PUBLIC WORKS  
OFFICE  
CAMP LEJEUNE  
NORTH CAROLINA

**FIELD PARTY**

\_\_\_\_\_  
IN CHARGE  
\_\_\_\_\_  
INSTRUMENT  
\_\_\_\_\_  
NOTES  
\_\_\_\_\_  
TAPE READ  
\_\_\_\_\_  
TAPE OR ROD  
\_\_\_\_\_  
TAPE OR ROD  
\_\_\_\_\_  
INSTRUMENT NO.  
\_\_\_\_\_  
TAPE NO.

**WEATHER**

CLEAR  
CLOUDY  
WINDY  
RAIN  
FAIR  
SNOW  
HOT  
MODERATE  
COLD  
FOG

FILE No. \_\_\_\_\_  
FLDR. No. \_\_\_\_\_  
SHEET 5-045  
DATE 8-19 1959

FIGURED BY \_\_\_\_\_  
NOTES CHECKED BY \_\_\_\_\_  
PLOTTED BY \_\_\_\_\_  
Quad. No. \_\_\_\_\_

STATION DIST. ANGLE " + H. I. BEARING VER. ANG. DIFF. ELEVATION  
TEST HOLE "G" 4.7

Ground Elev.

Area of sand overlay

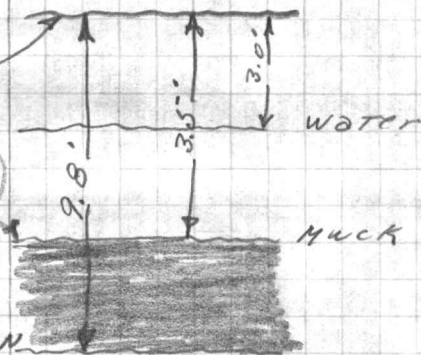

Limit of Penetration

SAND

TEST HOLE "H" 4.4

Ground Elev.

Area of sand overlay

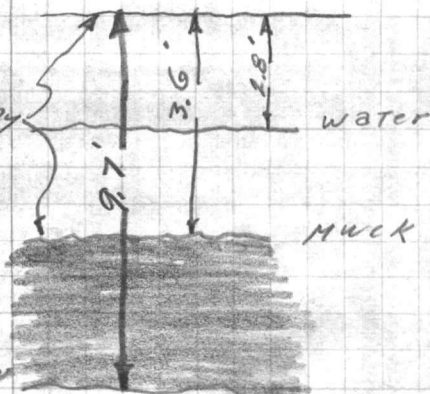

Limit of Penetration

SAND

VALUABLE SUBJECT

STATION  
DATE  
TIME  
OFFICE  
CITY

MON. #40 EL. 6.47

STATION DATE TIME

TYPE OF  
INSTRUMENT  
SERIAL NO.  
MAGNETIC  
CORRECTION  
TYPE OF  
CORRECTION

NAME  
ADDRESS  
CITY  
STATE  
ZIP

WILSON

**VALUABLE**

RETURN TO  
PUBLIC WORKS  
OFFICE  
CAMP LEJEUNE  
NORTH CAROLINA

SUBJECT

*X-Sections after Hurricane  
Erosion on Onslow Beach*

FIELD PARTY  
*Dillon* IN CHARGE  
INSTRUMENT  
NOTES  
TAPE READ  
TAPE OR ROD  
TAPE OR ROD  
INSTRUMENT NO.  
TAPE NO.

WEATHER  
CLEAR  
CLOUDY  
WINDY  
RAIN  
FAIR  
SNOW  
HOT  
MODERATE  
COLD  
FOG  
FIGURED BY  
NOTES CHECKED BY  
PLOTTED BY

FILE No. *221-5*  
FLDR. No.  
SHEET *#1 of*  
DATE *8/22/55*

Quad. No.

STATION	DIST.	ANGLE " "	+	H. I. BEARING	VER. ANG. DIFF.	ELEVATION	Diagram												
							<p><i>Enlisted Beach House</i></p> <p><i>Base Line</i></p> <p><i>Mon. #141</i></p> <p><i>Water Treatment Plant Site</i></p>												
							<p><i>Mon. #141</i></p> <p><i>T.B.M.</i></p> <p><i>T.B.M.</i></p> <p><i>12.90 18.60</i></p> <p><i>10.09 18.58</i></p> <p><i>5.57</i></p> <p><i>7.05</i></p> <p><i>5.70</i></p> <p><i>8.49</i></p> <p><i>280'</i></p> <p><i>0+00</i></p> <p><i>7+0</i></p> <p><i>8+0</i></p> <p><i>9+0</i></p> <p><i>Mon. #141</i></p> <p><i>Water Treatment Plant Site</i></p> <p><i>Op. Pole #5D 62 - Opposite Road from Water Tank</i></p> <p><i>Bolt on Water Tank, Lt. Side, Left of Door.</i></p>												
							<p><i>Edge Beach</i></p> <p><i>Top Dune</i></p> <p><i>E.R.</i></p>												
<i>Sta 7+00</i>							<i>243</i>	<i>207</i>	<i>181</i>	<i>152</i>	<i>138</i>	<i>118</i>	<i>100</i>	<i>87</i>	<i>65</i>	<i>20</i>	<i>10</i>	<i>±</i>	
							<i>16.4</i>	<i>14.7</i>	<i>13.3</i>	<i>10.3</i>	<i>34</i>	<i>7.0</i>	<i>11.0</i>	<i>12.3</i>	<i>13.7</i>	<i>14.1</i>	<i>13.5</i>	<i>13.1</i>	
							<i>2.2</i>	<i>3.9</i>	<i>5.3</i>	<i>8.3</i>	<i>15.2</i>	<i>11.6</i>	<i>7.6</i>	<i>6.3</i>	<i>4.9</i>	<i>4.5</i>	<i>5.1</i>	<i>5.5</i>	
<i>8+00</i>		<i>335°</i>					<i>252</i>	<i>198</i>	<i>175</i>	<i>152</i>	<i>142</i>	<i>120</i>	<i>110</i>	<i>100</i>	<i>76</i>	<i>48</i>	<i>23</i>	<i>10</i>	<i>±</i>
		<i>-0.8</i>					<i>16.6</i>	<i>14.3</i>	<i>12.7</i>	<i>9.5</i>	<i>1.6</i>	<i>3.6</i>	<i>7.6</i>	<i>9.9</i>	<i>11.3</i>	<i>13.1</i>	<i>13.5</i>	<i>13.3</i>	<i>13.1</i>
							<i>2.0</i>	<i>4.3</i>	<i>5.9</i>	<i>9.1</i>	<i>12.0</i>	<i>15.0</i>	<i>11.0</i>	<i>8.7</i>	<i>2.3</i>	<i>5.5</i>	<i>5.1</i>	<i>5.3</i>	<i>5.5</i>
<i>9+00</i>							<i>233</i>	<i>193</i>	<i>165</i>	<i>148</i>	<i>137</i>	<i>123</i>	<i>117</i>	<i>87</i>	<i>68</i>	<i>33</i>	<i>12</i>	<i>±</i>	
							<i>16.9</i>	<i>14.6</i>	<i>12.6</i>	<i>10.5</i>	<i>40.6</i>	<i>6.1</i>	<i>11.0</i>	<i>11.1</i>	<i>7.2</i>	<i>12.8</i>	<i>13.1</i>	<i>13.0</i>	
							<i>1.7</i>	<i>4.0</i>	<i>4.0</i>	<i>8.1</i>	<i>19.2</i>	<i>12.5</i>	<i>7.6</i>	<i>7.5</i>	<i>11.4</i>	<i>5.8</i>	<i>5.5</i>	<i>5.6</i>	

VALUABLE

ESTABLISHED  
FEDERAL WORKS  
SERVICE  
CARPENTERS  
NORTH CAROLINA

STATION

AND

BRANCH

DUPLICATE

REVISION

TABLED

TABLE NO.

TABLE OR BOX

TABLE ROAD

NOYES

WINDY

IN CHANGE

LD PARTY

NOTICE CHECKED BY

PREPARED BY

DATE

COLD

WINDY

WINDY

WINDY

TABLE NO.

TABLE NO.



TABLE NO.

VALUABLE

Return To  
Public Works  
Office  
Camp Lejeune  
North Carolina

SUBJECT Elevation & Overflow of  
100,000 Gal. Water Tank  
Onslow Beach  
S-B A-108

FIELD PARTY  
Turlington In Charge  
Instrument \_\_\_\_\_  
Notes \_\_\_\_\_  
Tape Read \_\_\_\_\_  
Tape or Rod \_\_\_\_\_  
Tape or Rod \_\_\_\_\_  
Instrument No. \_\_\_\_\_  
Tape No. \_\_\_\_\_

WEATHER  
Clear \_\_\_\_\_  
Cloudy \_\_\_\_\_  
Windy \_\_\_\_\_  
Rain \_\_\_\_\_  
Fair \_\_\_\_\_  
Snow \_\_\_\_\_  
Hot \_\_\_\_\_  
Moderate \_\_\_\_\_  
Cold \_\_\_\_\_  
Fog \_\_\_\_\_  
Figured By \_\_\_\_\_  
Notes Checked By \_\_\_\_\_  
Plotted By \_\_\_\_\_

FILE No. 221-5  
Fldr. No. \_\_\_\_\_  
Sheet 41 of 2  
Date 11/25 1946  
Quad. No. \_\_\_\_\_

Station	Dist.	Angle	H. I. Bearing	Ver. Ang. Diff.	Elevation
					Barrel + 45" Down
BM	1.05		9.64 Mean <del>9.59</del>		8.54
Top Tank		24° 14'	133.54 Height 135.11	134.32 Mean + 9.64 = 143.96	Elev. at Top of Tank
Top Over Flo Pipe 6"		22° 07'	122.00 - 0.50 (Bottom of Pipe)	121.50	Overflow + 9.64 = 131.14 Elevation of Overflow Pipe
Bottom Tank		17° 17'	93.42 92.75	93.04 + 9.64 =	102.73 Elev. Top of Riser Pipe
BM	1.15		9.64 Mean <del>9.69</del>		8.54
Top Tank		23° 59'	133.54 Height 135.11	134.32 Mean + 9.64 = 143.96	Elevation at Top of Tank
Top over Flo Pipe 6"		22° 07'	122.00 - 0.50	121.50	Overflow
Bottom		17° 10'	93.75 93.42	93.04 + 9.64 =	102.73 Elev. Top of Riser Pipe



VALUABLE  
Return to  
Public Works  
Office  
State College  
North Carolina

SUBJECT

Section  
Date  
Name  
Bedding  
H. H. Working  
D.M. Elevation

FIELD PARTY

In Charge  
Assistant  
Notes  
Type Road  
Type of Road  
Type of Road  
Number of  
Type No.

WEATHER

Clear  
Cloudy  
Wind  
Moderate  
Rain  
Fog  
Light  
Type of Road  
Notes Checked by  
Notes by

FILE NO.

Field No.

Sheet

Date

Quad No.

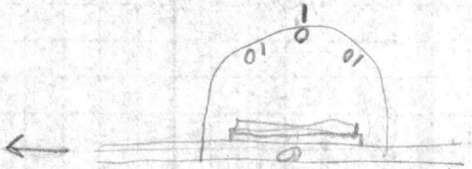



**VALUABLE**

SUBJECT Onslow Beach Water Tank

Return To  
Public Works  
Office  
Camp Lejeune  
North Carolina

FIELD PARTY  
Turlington In Charge  
Instrument \_\_\_\_\_  
Notes \_\_\_\_\_  
Tape Read \_\_\_\_\_  
Tape or Rod \_\_\_\_\_  
Tape or Rod \_\_\_\_\_  
Instrument No. \_\_\_\_\_  
Tape No. \_\_\_\_\_

WEATHER  
Clear \_\_\_\_\_  
Cloudy \_\_\_\_\_  
Windy \_\_\_\_\_  
Rain \_\_\_\_\_  
Fair \_\_\_\_\_  
Snow \_\_\_\_\_  
Hot \_\_\_\_\_  
Moderate \_\_\_\_\_  
Cold \_\_\_\_\_  
Fog \_\_\_\_\_  
Figured By \_\_\_\_\_  
Notes Checked By \_\_\_\_\_  
Plotted By \_\_\_\_\_

FILE No. \_\_\_\_\_  
Fldr. No. \_\_\_\_\_  
Sheet # 242  
Date 11/25 1946

Quad. No. \_\_\_\_\_

Station	Dist.	Angle " "	+	H. I. Bearing	Ver: Ang. Diff.	Elevation	
BM						7.05	Mon #141
	2.08	9	13		5.35	3.78	
BM	5.32	9	10		0.50	8.54	Head of bot 2A. Side of Water Tank First Bolt Left Door Top Bolt
					2.09	7.01	concrete base
	0.58	9	12		3.1	6.0	Ground
					5.37	3.75	
	5.35	9	10				
BM					2.04	7.06	Mon #141

Return To  
Public Works  
Office  
Camp Lejeune  
North Carolina

SUBJECT

Station Dist. Angle H. of Bench  
Var. And. elevation

FIELD PARTY

In Charge  
Instruments  
Notes  
Type Read  
Type of Rod  
Type of Rod  
Station No.  
Type No.

WEATHER

Clear  
Cloudy  
Moderate  
Cold  
Fog  
Rain  
Snow  
Hot  
Windy

FILE No.

File No.

Sheet

Date

Plotted By

Notes Checked By

Plotted By

Quadr. No.

**VALUABLE**

SUBJECT NEW BENCH MARK  
AT WATER TREATMENT PLANT  
Site - on slough beach

RETURN TO  
PUBLIC WORKS  
OFFICE  
CAMP LEJEUNE  
NORTH CAROLINA

FIELD PARTY

KEPNEY IN CHARGE  
\_\_\_\_ INSTRUMENT  
\_\_\_\_ NOTES  
\_\_\_\_ TAPE READ  
\_\_\_\_ TAPE OR ROD  
\_\_\_\_ TAPE OR ROD  
\_\_\_\_ INSTRUMENT NO.  
\_\_\_\_ TAPE NO.

WEATHER

CLEAR  
CLOUDY  
WINDY  
RAIN  
FAIR  
SNOW  
HOT  
MODERATE  
COLD  
FOG

FILE No. \_\_\_\_\_  
FLDR. No. \_\_\_\_\_  
SHEET 1-0f  
DATE 8-20 1959

FIGURED BY \_\_\_\_\_  
NOTES CHECKED BY \_\_\_\_\_  
PLOTTED BY \_\_\_\_\_  
Quad. No. \_\_\_\_\_

STATION	DIST.	ANGLE ° ' "	+	H. I. BEARING	VER. ANG. DIFF.	ELEVATION
B.M.						6.47
			5.28	11.75		
T.P.					4.61	7.14
			4.05	11.19		
T.P.					4.06	7.13
			2.54	10.67		
NEW B.M.					4.97	5.70
			3.40	9.10		
original B.M. ON BOLT of WATER TANK					0.60	8.50
						8.49

NOV. #40

No. 5 D 62  
#20 Nail in Power Pole directly across  
Road from Water Tank.

BOLT is 2.5' South from Edge of  
BOTTOM STEP

VALUABLE

RETURN TO  
POST OFFICE  
OFFICE  
DAMASCUS  
SYRIA

STATION

NO.

DATE

TIME

RELAY

FIELD PARTY

NAME

NUMBER

GRADE

POST OFFICE

OR RFD

NUMBER

NO.

WEIGHT

OF

PACKAGE

NO.

POSTAGE

PAID BY

NO.

NO.

FILE NO.

FILE NO.

FILE NO.

FILE NO.

FILE NO.



PUBLIC WORKS DEPARTMENT  
Camp Lejeune, North Carolina  
Survey Department

221-5

File ~~221-5~~  
Quadrangle 221-5  
Date 1/12/48  
Sheet      of     

Traverse Computation  
Description

North  
R/W of Inland Waterway at Sta. 298+73  $\frac{1}{2}$  Mi. SW. of Mock-up \*

Station	Distance	Bearing	Cosine	Sine	Latitude	Departure	Y Coordinate North	X Coordinate East
<i>Passet</i>							293,173.64	2,509,046.21
	186'	S86°10'E	06685	99776	12.43	185.58	293,161.21	2,509,231.79
	2558'	N51°30'E	62251	78261	1592.38	2001.92	294,753.59	2,511,233.71
	1530'	N40°W	76604	64279	1172.04	983.47	295,925.63	2,510,250.24
	8526'	N59°42'E	50453	8634	4301.62	7361.35	300,227.25	2,517,611.59
P.I. on North R/W	1000'	N30°18'W	8634	50453	863.40	504.53	301,090.65	2,517,107.06
						*	301,092.52	2,517,008.56
							1.87	38.50
							5.21	44.37

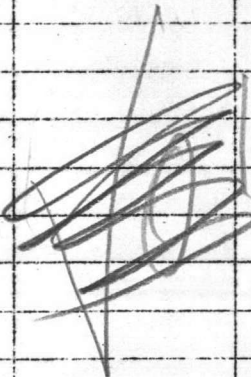

\* Computed from Boney + Broadfoot R/W Tie Magnetic Bearings & Approximate Distances.  
\* Computed from Corps of Engineers Datum as interpreted from print furnished by Wilmington District Office





