

VALUABLE

RETURN TO
PUBLIC WORKS
OFFICE
CAMP LEJEUNE
NORTH CAROLINA

SUBJECT Shore Line Location
AT Mouth of Stone Creek
CONTINUED

FIELD PARTY

IN CHARGE _____
INSTRUMENT _____
NOTES _____
TAPE READ _____
TAPE OR ROD _____
TAPE OR ROD _____
INSTRUMENT NO. _____
TAPE NO. _____

WEATHER

CLEAR _____ SNOW _____
CLOUDY _____ HOT _____
WINDY _____ MODERATE _____
RAIN _____ COLD _____
FAIR _____ FOG _____
FIGURED BY _____
NOTES CHECKED BY _____
PLOTTED BY _____

FILE No. _____
FLDR. No. _____
SHEET 2-62
DATE 2-13-59

Quad. No. _____

STATION	DIST.	ANGLE ° ' "	+	H. I. BEARING	VER: ANG. DIFF.	ELEVATION	
	35'	141° 53'					Location of south end of net as designated by D.B. Capt. Townsend, U.S. Marine Corps Depot at 1300
	81'	115° 05'					Point that net was hung on snag as designated D.B. By Capt. Townsend water 1.8' deep at 1300 o'clock North shore of creek
		LINE "13"					
	226'	176° 10'					Location of north end of net as designated by Capt. Townsend no water at this point at 1310 o'clock shore line at H.H.V.
	200'	169° 30'	✓				"
	222'	173° 17'	✓				"
	165'	152° 20'	✓				"
	238'	172° 41'	✓				"
	215'	146° 34'	✓				"
	310'	183° 53'	✓				"
	262'	144° 46'	✓				"
	400'	191° 16'	✓				"
	335'	147° 34'	✓				"
465	505'	195° 23'	✓				"
	547'	199° 16'	✓				"
	525'	140° 20'	✓				" 50' towards T S.L. 15' East
	663'	204° 36'	✓				"
	780'	208° 37'	✓				"
	570'	136° 06'	✓				
					-4.2 -5.4		Depth of water in creek between north & south shores

STATION
DATE
TIME
TEMPERATURE
WIND
HUMIDITY
PRESSURE
SEA LEVEL
STATE
COUNTY

Location Mouth Stone Creek

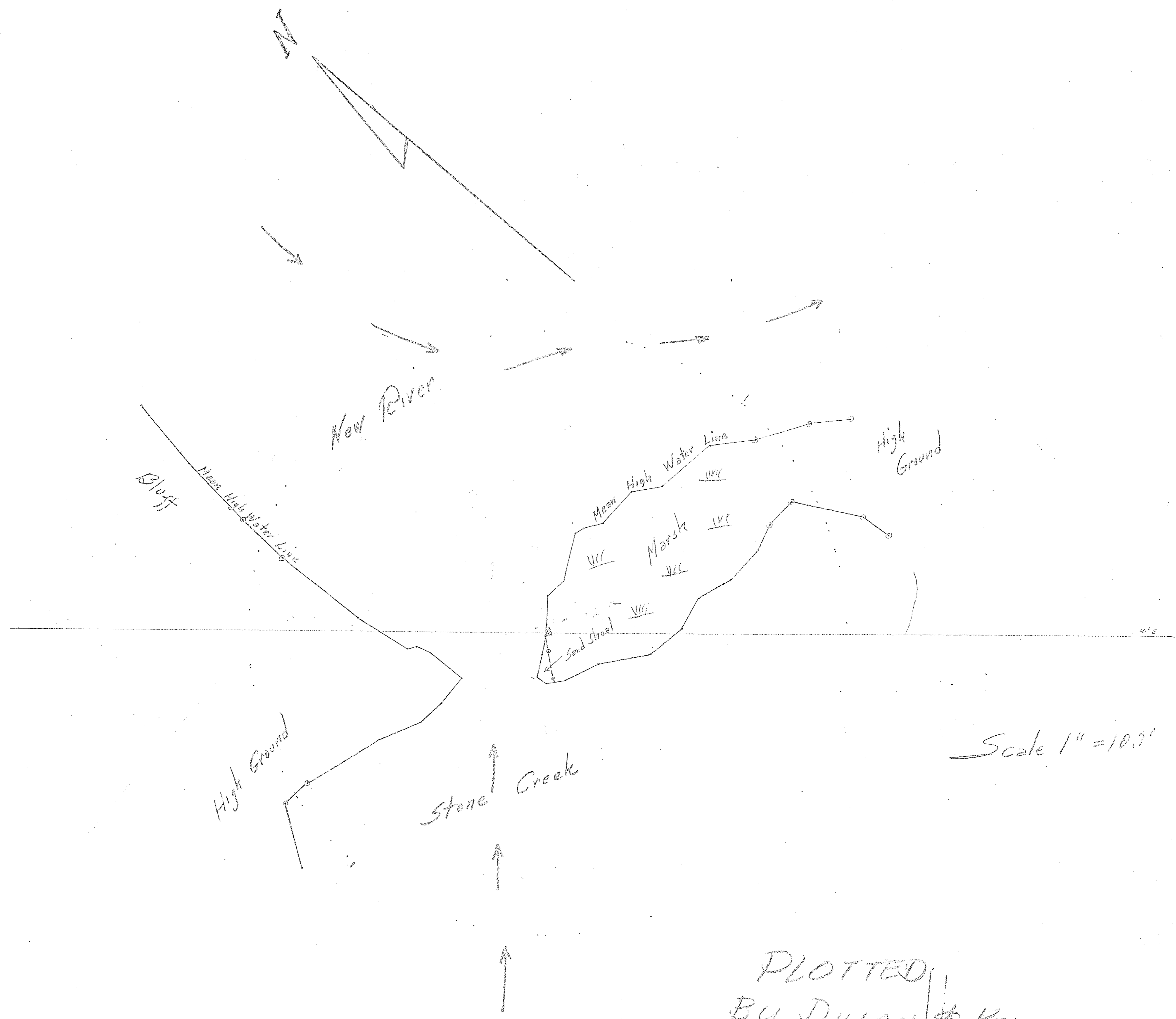

PLOTTED
By DILLON & KELLUM
5-13-58

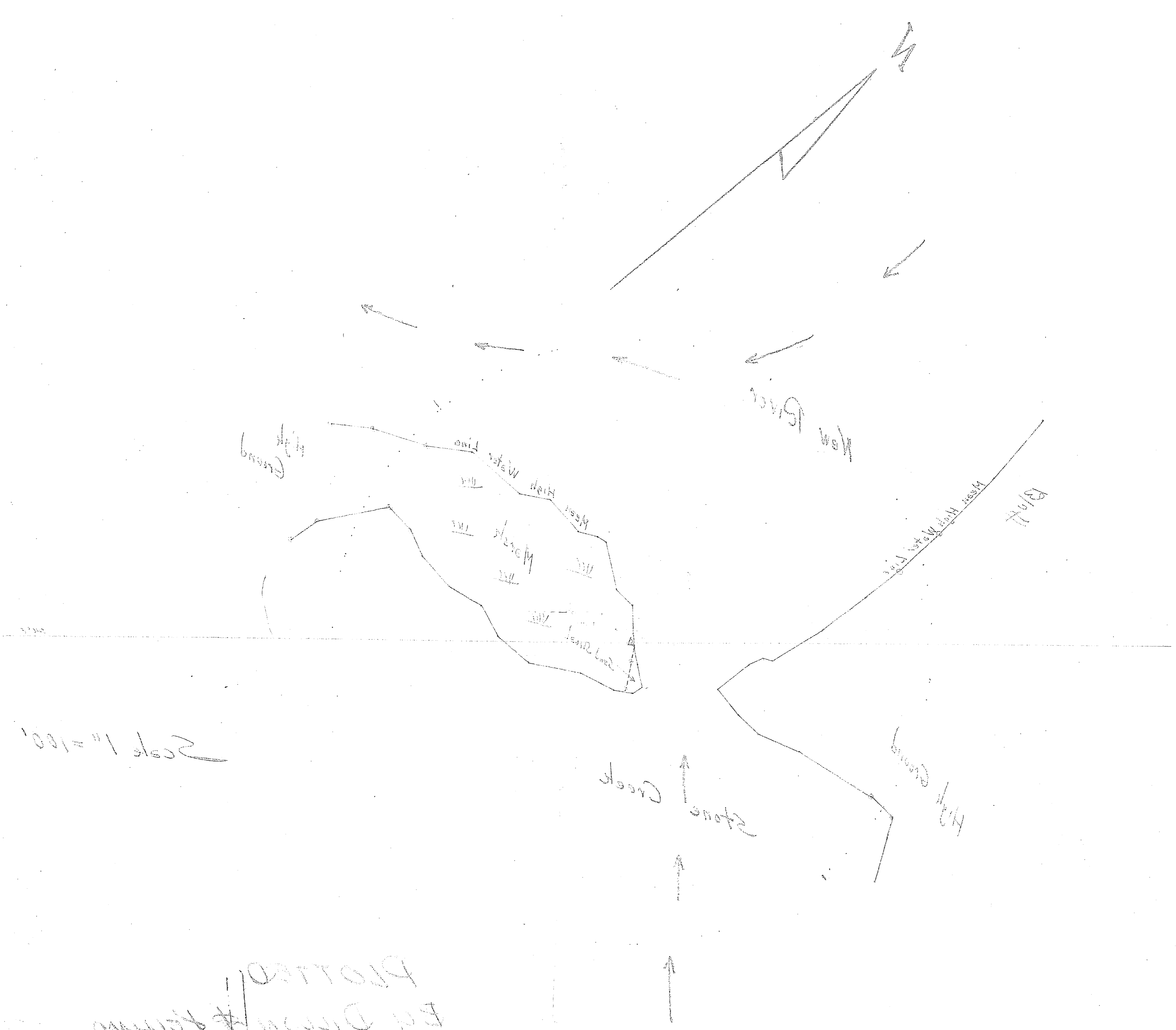

Scale 1" = 100'

2-13-28
 Ed Dixon
 PLOTTED