

LEGEND

- BUILDINGS AND STRUCTURES
- ROADS AND HIGHWAYS
- ROADS (Unpaved)
- FENCE
- RESERVATION BOUNDARY
- 5' CONTOUR (Source-USGS Maps)
- SANITARY SEWER
- MANHOLE
- SEWAGE PUMPING STATION
- SERVICE LINE

NOTES:
 ALL GRAVITY SEWERS ARE TERRA COTTA UNLESS NOTED OTHERWISE.
 PUMPING STATION NOT IN SERVICE.

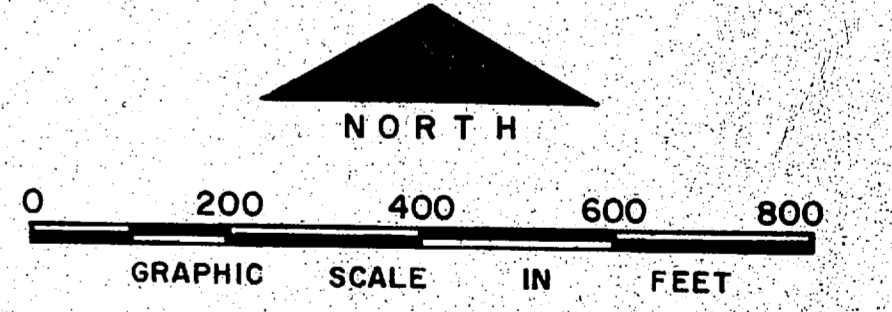

NO.	DESCRIPTION OF REVISION	DATE	INT.
DEPARTMENT OF THE NAVY MARINE CORPS BASE CAMP LEJEUNE, NORTH CAROLINA			
WASTEWATER COLLECTION SYSTEM EXISTING CONDITIONS			
DATE 31 JULY 84	SCALE: GRAPHIC	SHEET B-1 OF 73	
APPROVED / DATE	0000043		



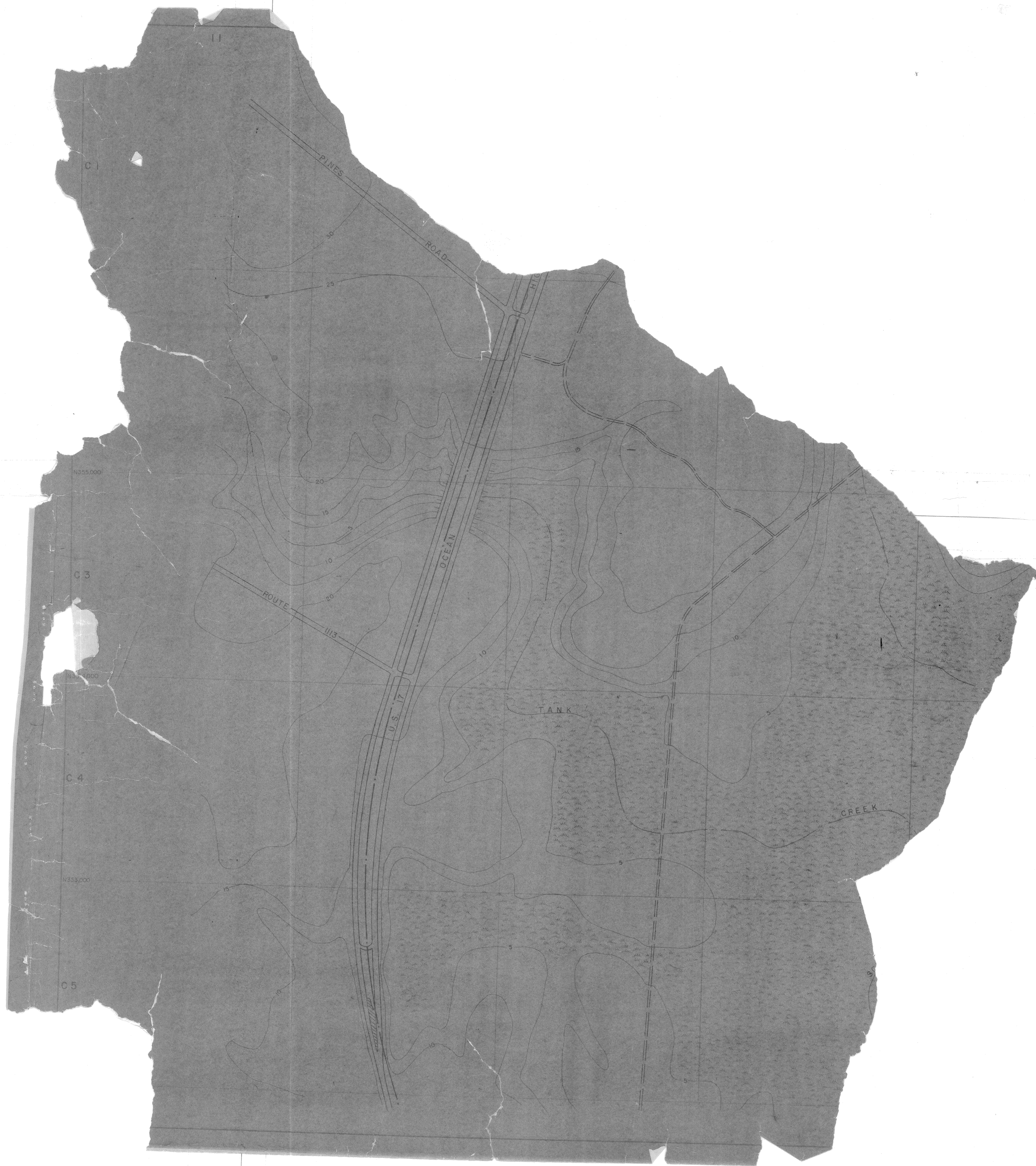



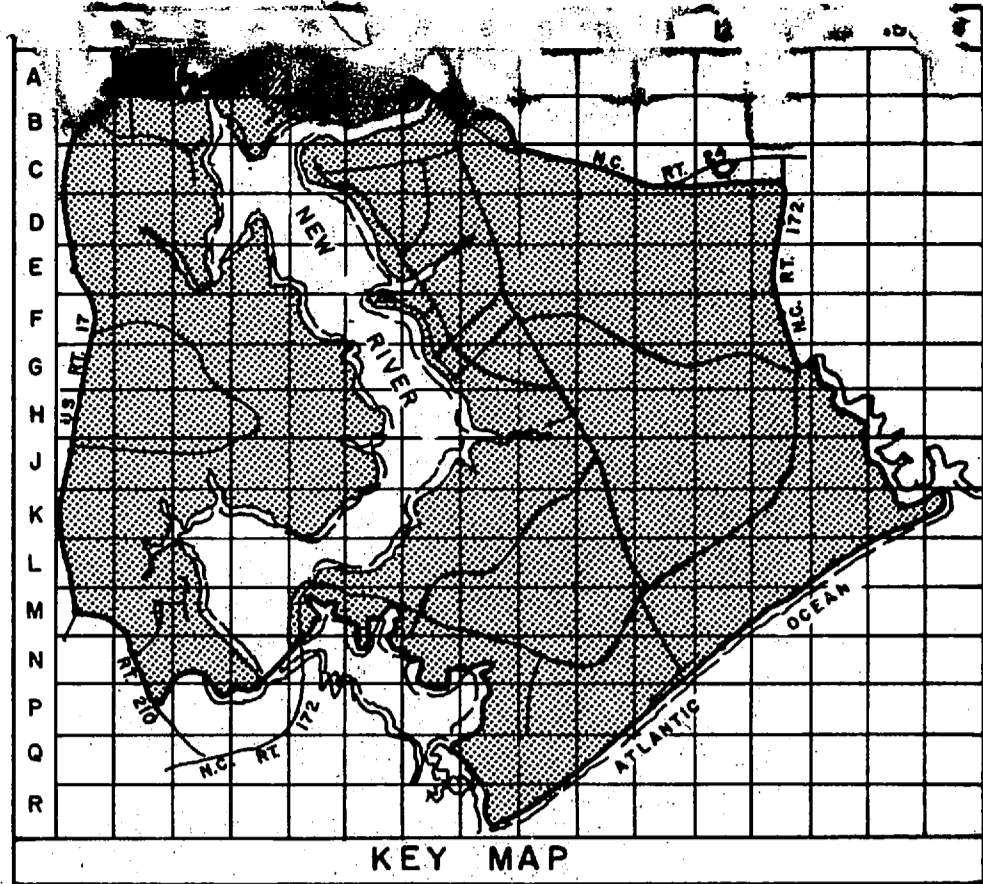
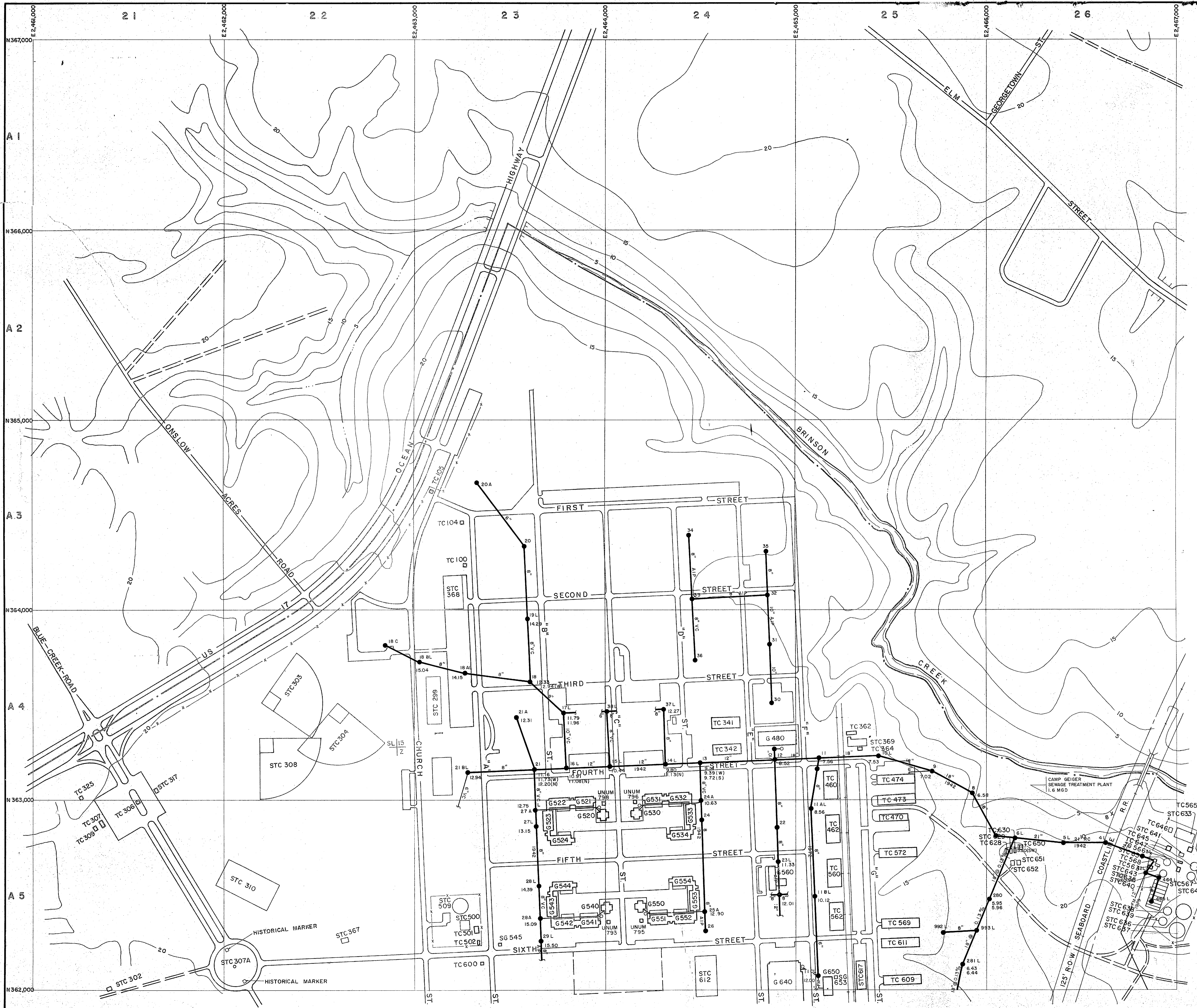

LEGEND

- BUILDINGS AND STRUCTURES
- ROADS AND HIGHWAYS
- ROADS (Unpaved)
- FENCE
- 5' CONTOUR (Source-USGS Maps)
- HELICOPTER LANDING ZONE
- RESERVATION BOUNDARY
- SANITARY SEWER
- MANHOLE
- FORCE MAIN
- ABANDONED IN PLACE
- SERVICE LINE

MATERIAL OF CONSTRUCTION
 RC - REINFORCED CONCRETE
 VC - VITRIFIED CLAY

NOTES:
 ALL GRAVITY SEWERS ARE TERRA COTTA UNLESS NOTED OTHERWISE.

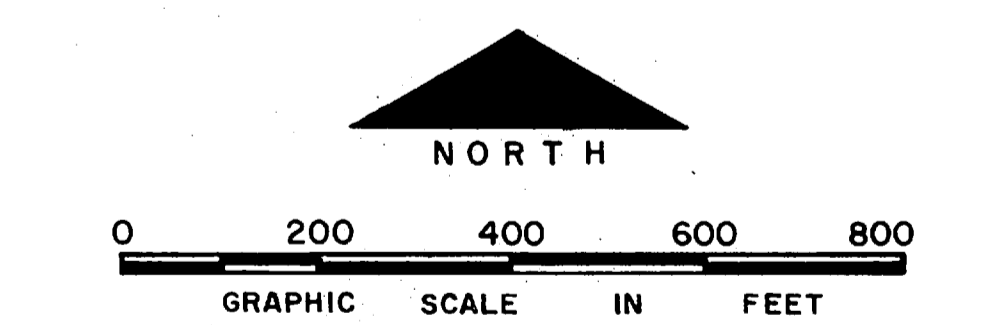

NO.	DESCRIPTION OF REVISION	DATE	INT.
DEPARTMENT OF THE NAVY MARINE CORPS BASE CAMP LEJEUNE, NORTH CAROLINA			
WASTEWATER COLLECTION SYSTEM EXISTING CONDITIONS			
DATE 31 JULY 84	SCALE: GRAPHIC	SHEET A-2 OF 73	
APPROVED / DATE			



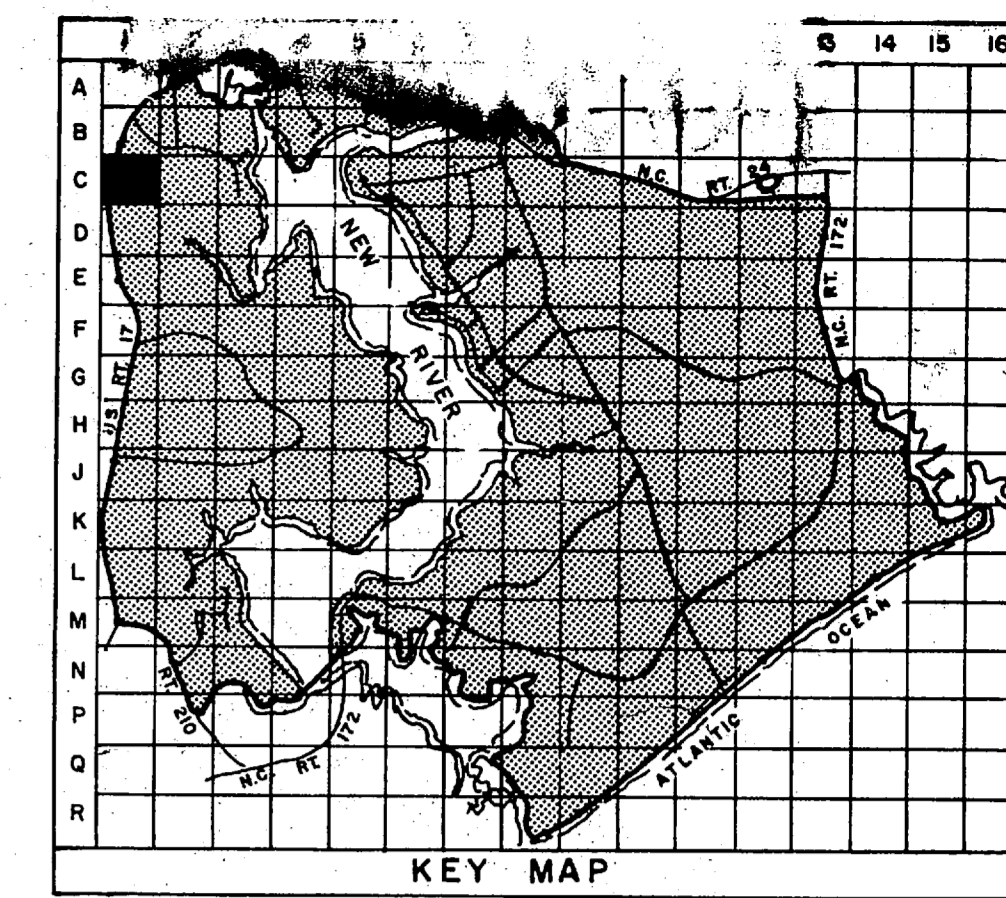
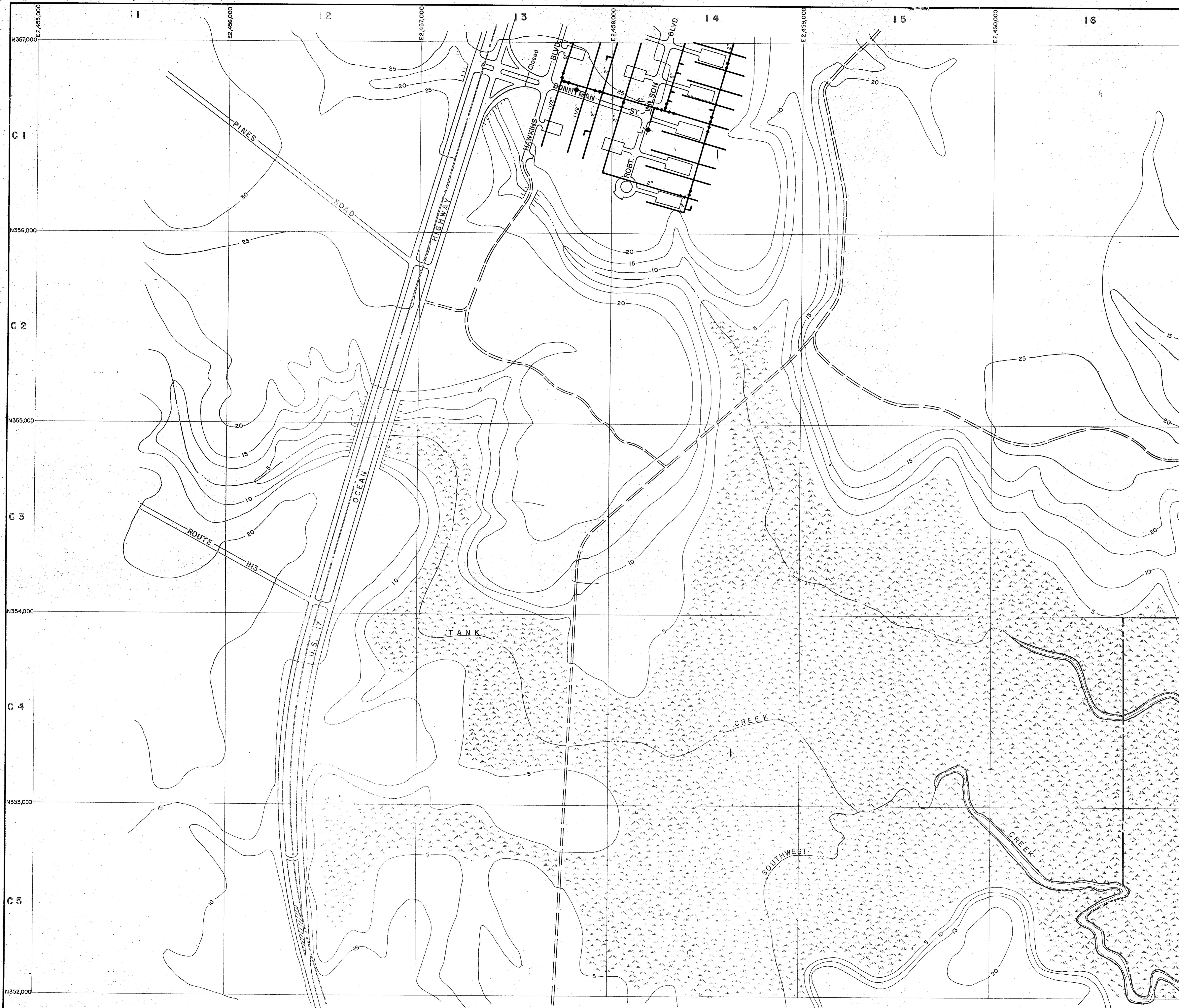

- LEGEND**
- BUILDINGS AND STRUCTURES
 - ROADS AND HIGHWAYS
 - ROADS (Unpaved)
 - FENCE
 - 5' CONTOUR (Source-USGS Maps)
 - AIR STATION BOUNDARY
 - RESERVATION BOUNDARY
 - SWAMP OR MARSH
-
- 6" MATERIAL POTABLE WATER MAIN
 - VALVE FIELD LOCATED
 - FIRE HYDRANT FIELD LOCATED

NOTES:
ALL WATER MAINS ARE CAST IRON UNLESS NOTED OTHERWISE.

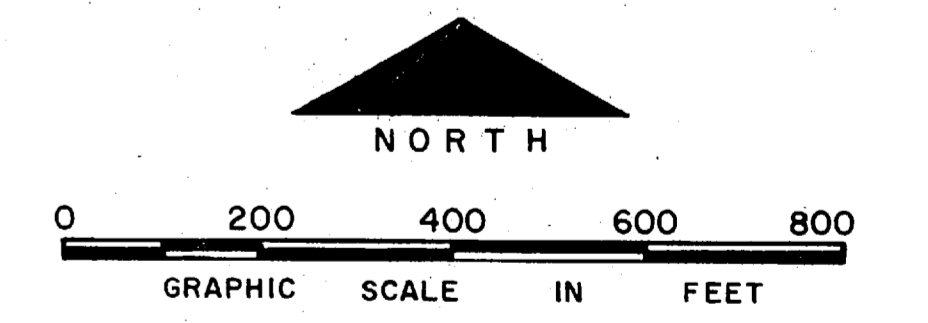

NO.	DESCRIPTION OF REVISION	DATE	INT.
DEPARTMENT OF THE NAVY MARINE CORPS BASE CAMP LEJEUNE, NORTH CAROLINA			
WATER DISTRIBUTION SYSTEM EXISTING CONDITIONS			
DATE	31 JULY 84	SCALE:	GRAPHIC
		SHEET	C-1 OF 73
APPROVED / DATE	0000140		

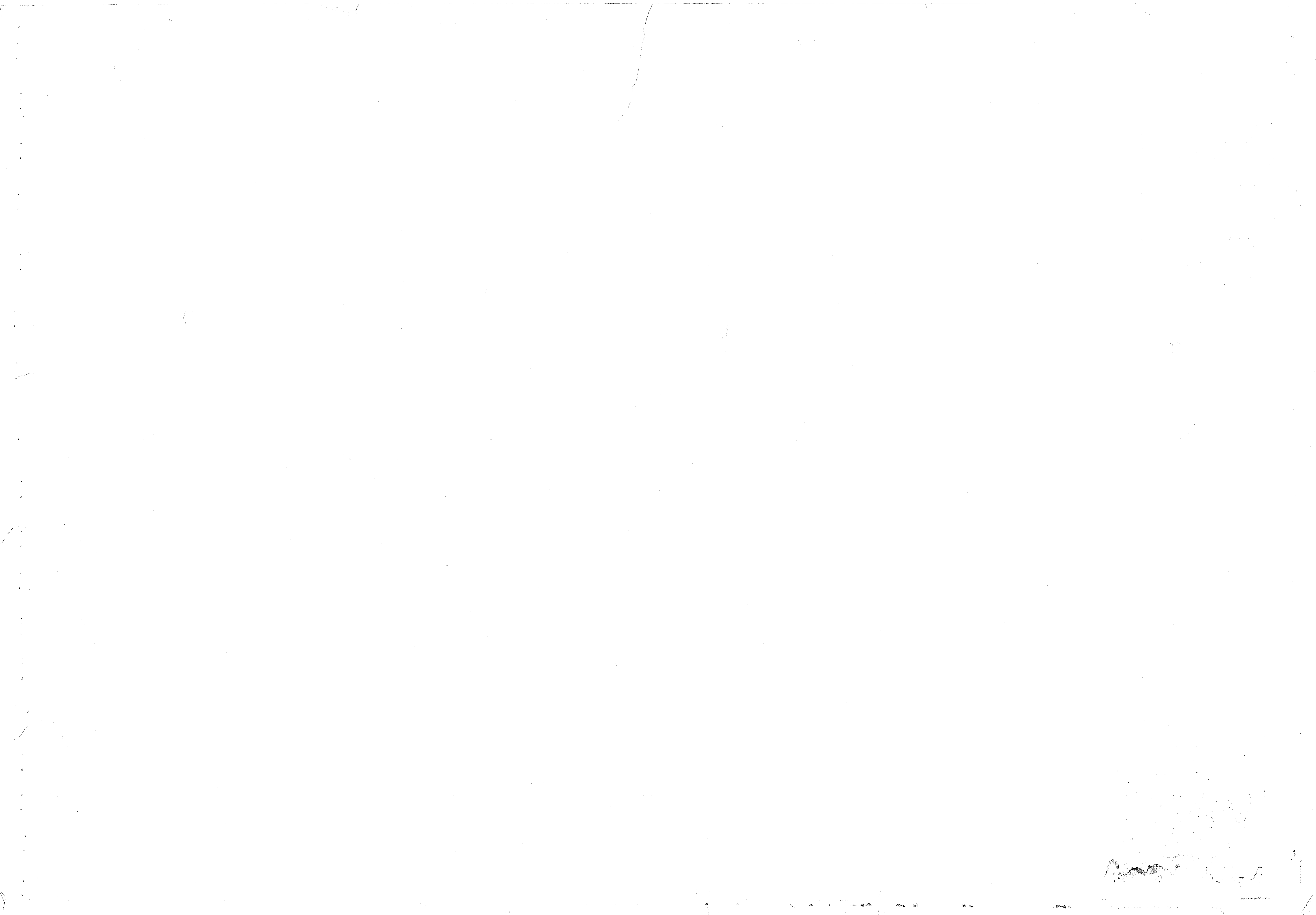

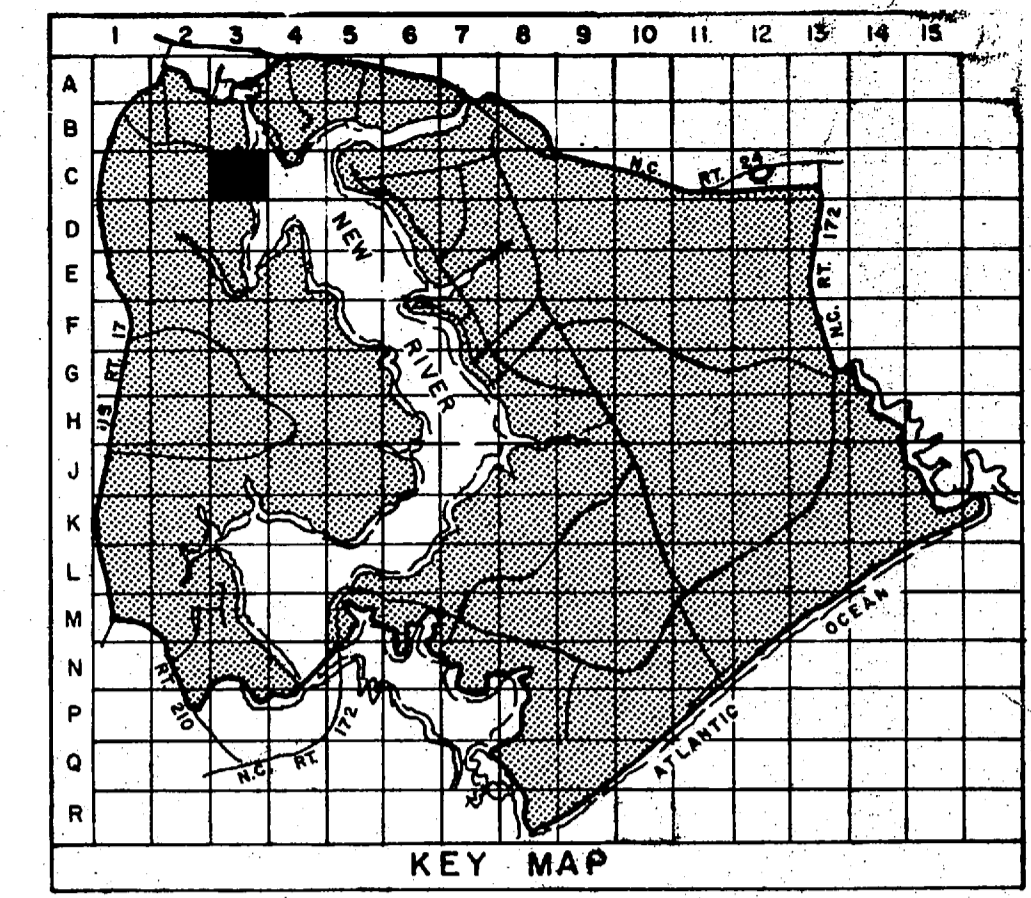
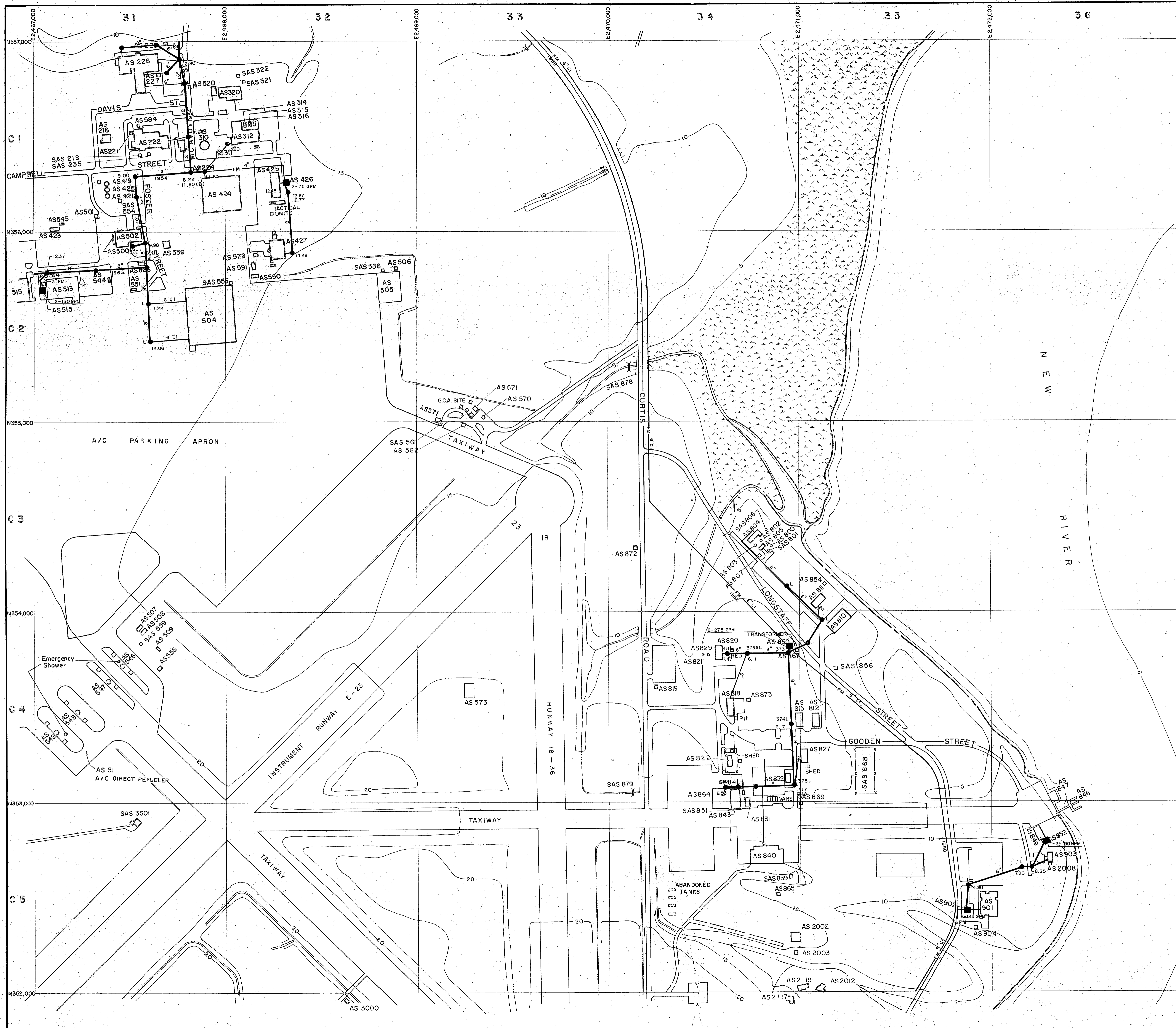

- LEGEND**
- BUILDINGS AND STRUCTURES
 - ROADS AND HIGHWAYS
 - ROADS (Unpaved)
 - FENCE
 - 5' CONTOUR (Source-USGS Maps)
 - AIR STATION BOUNDARY
 - SWAMP OR MARSH
 - SANITARY SEWER
 - MANHOLE
 - SERVICE LINE
 - FORCE MAIN
 - SEWAGE PUMPING STATION
 - SEPTIC TANK AND DRAIN FIELD

MATERIAL OF CONSTRUCTION
 CI - CAST IRON

NOTES:
 ALL GRAVITY SEWERS ARE TERRA COTTA UNLESS NOTED OTHERWISE.

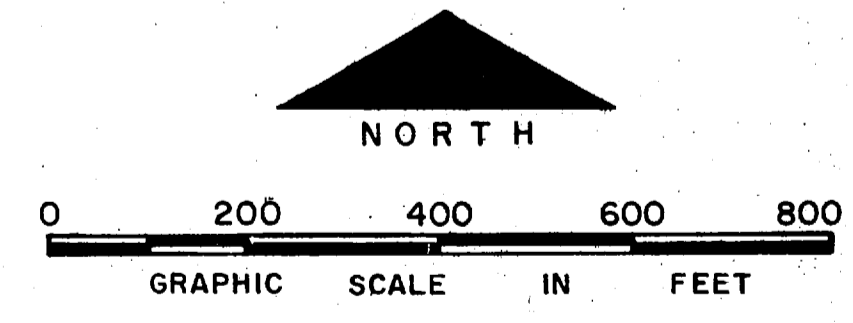

NO.	DESCRIPTION OF REVISION	DATE	INT.

**DEPARTMENT OF THE NAVY
MARINE CORPS BASE
CAMP LEJEUNE, NORTH CAROLINA**

**WASTEWATER COLLECTION SYSTEM
EXISTING CONDITIONS**

DATE 31 JULY 84	SCALE: GRAPHIC	SHEET C-3 OF 73
APPROVED / DATE	0000053	



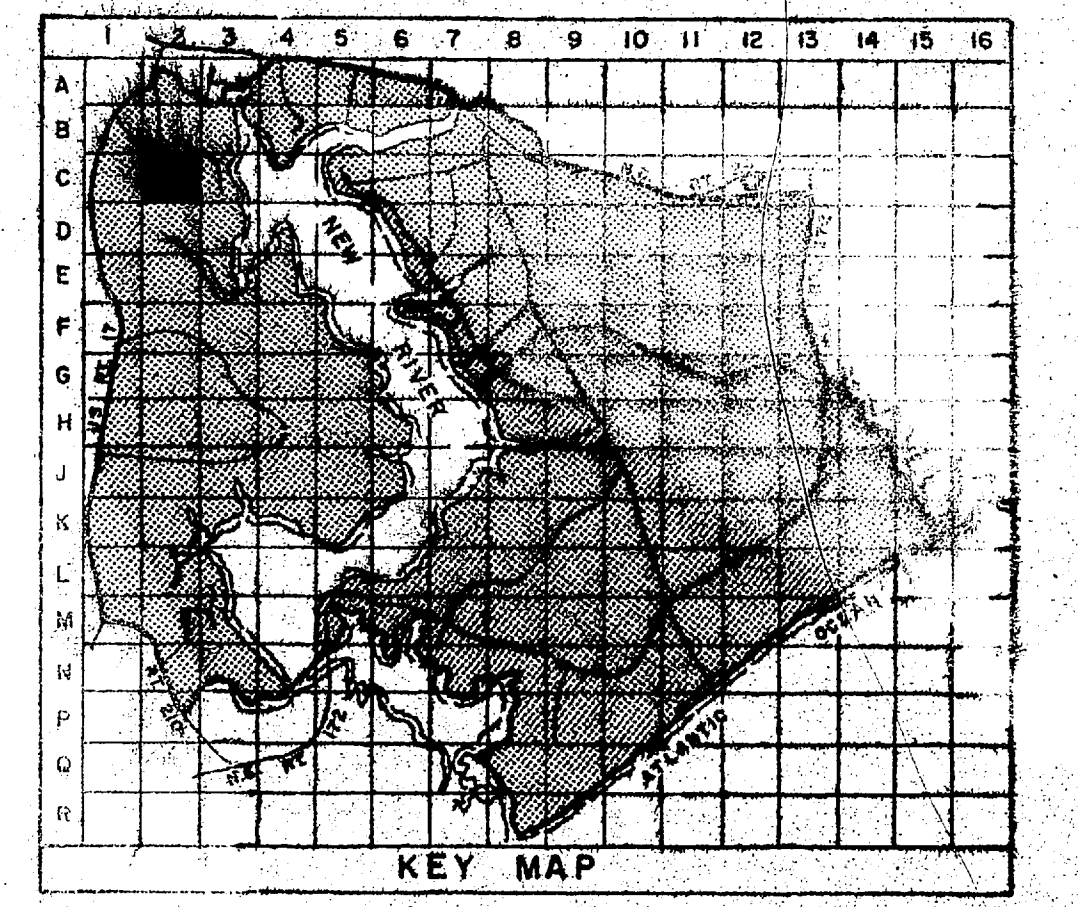
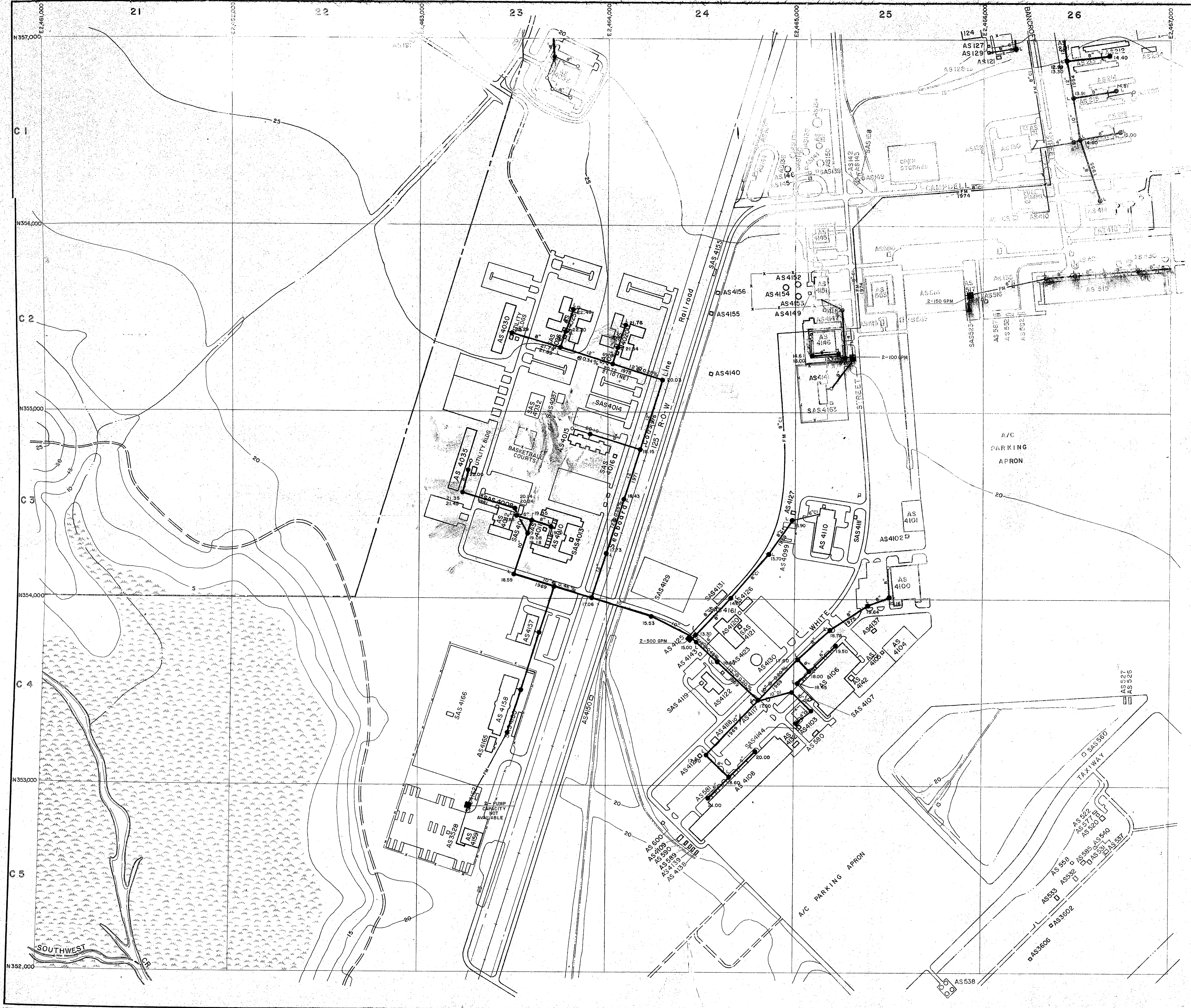

- LEGEND**
- [Symbol] BUILDINGS AND STRUCTURES
 - [Symbol] ROADS AND HIGHWAYS
 - [Symbol] ROADS (Unpaved)
 - [Symbol] FENCE
 - [Symbol] 5' CONTOUR (Source - USGS Maps)
 - [Symbol] AIR STATION BOUNDARY
 - [Symbol] SWAMP OR MARSH
 - [Symbol] SANITARY SEWER
 - [Symbol] MANHOLE
 - [Symbol] SERVICE LINE
 - [Symbol] FORCE MAIN
 - [Symbol] SEWAGE PUMPING STATION
 - [Symbol] OIL/WATER SEPARATOR

MATERIAL OF CONSTRUCTION
 C1 - CAST IRON
 D1 - DUCTILE IRON

NOTES:
 ALL GRAVITY SEWERS ARE TERRA COTTA UNLESS NOTED OTHERWISE.

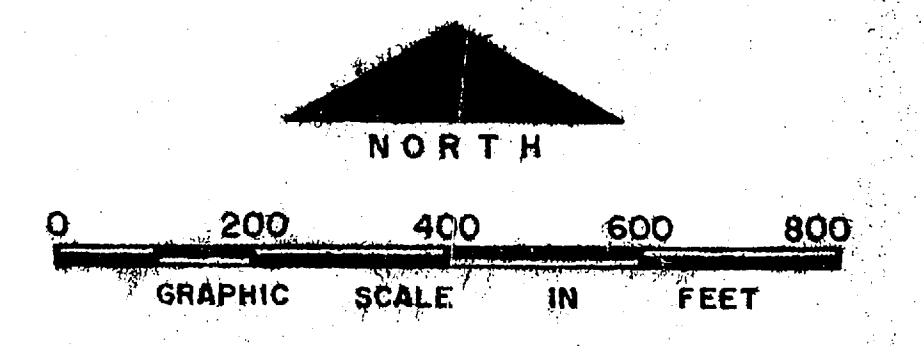

NO.	DESCRIPTION OF REVISION	DATE	INT.
DEPARTMENT OF THE NAVY MARINE CORPS BASE CAMP LEJEUNE, NORTH CAROLINA			
WASTEWATER COLLECTION SYSTEM EXISTING CONDITIONS			
DATE 31 JULY 84	SCALE: GRAPHIC	SHEET C-2 OF 73	
APPROVED / DATE	[Signature]		



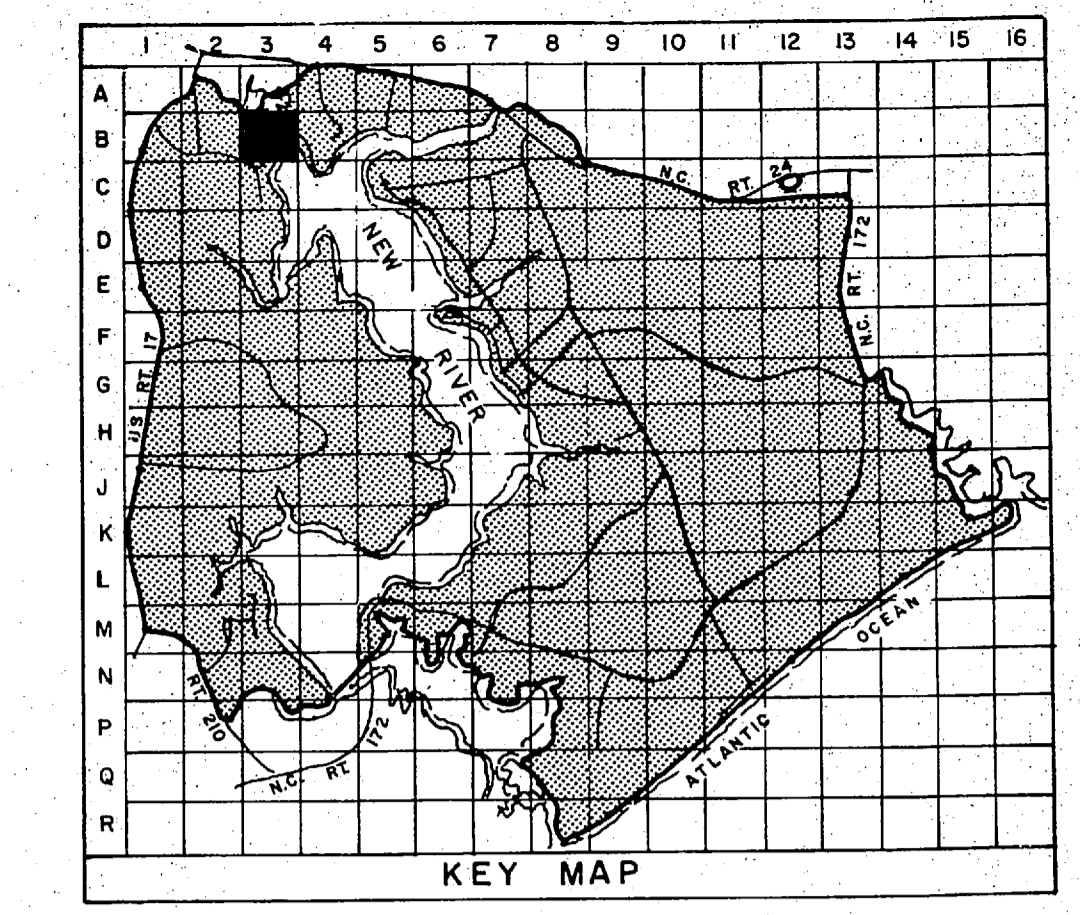

- LEGEND**
- BUILDINGS AND STRUCTURES
 - ROADS AND HIGHWAYS
 - ROADS (Unpaved)
 - FENCE
 - HELICOPTER LANDING ZONE
 - 5' CONTOUR (Source - USGS Maps)
 - RESERVATION BOUNDARY
 - AIR STATION BOUNDARY
 - SWAMP OR MARSH
 - SANITARY SEWER
 - MANHOLE
 - SERVICE LINE
 - FORCE MAIN
 - SEWAGE PUMPING STATION
 - AIR RELEASE VALVE

MATERIAL OF CONSTRUCTION

CI - CAST IRON

NOTES:

ALL GRAVITY SEWERS ARE TERRA COTTA UNLESS NOTED OTHERWISE.

ALL SERVICE LINES IN 1100 & 1200 AREAS ARE 4" UNLESS NOTED OTHERWISE.

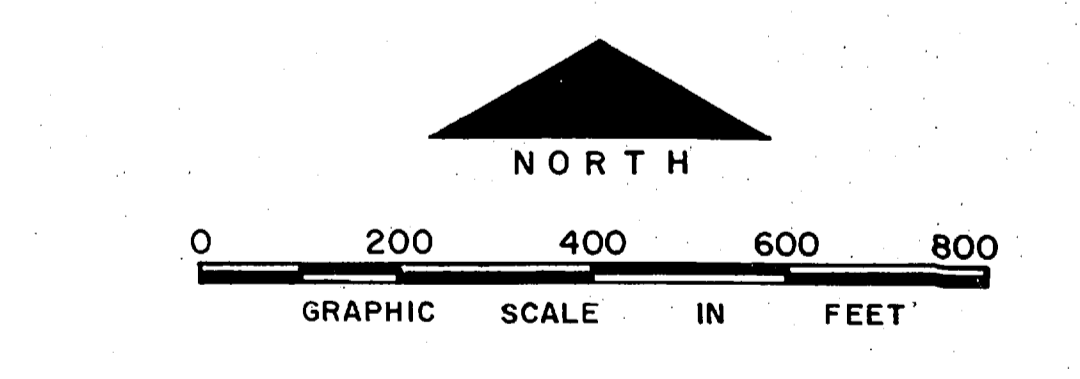

NO.	DESCRIPTION OF REVISION	DATE	INT.
DEPARTMENT OF THE NAVY MARINE CORPS BASE CAMP LEJEUNE, NORTH CAROLINA			
WASTEWATER COLLECTION SYSTEM EXISTING CONDITIONS			
DATE 31 JULY 84	SCALE: GRAPHIC	SHEET B-3 OF 73	
APPROVED / DATE	000000 45		



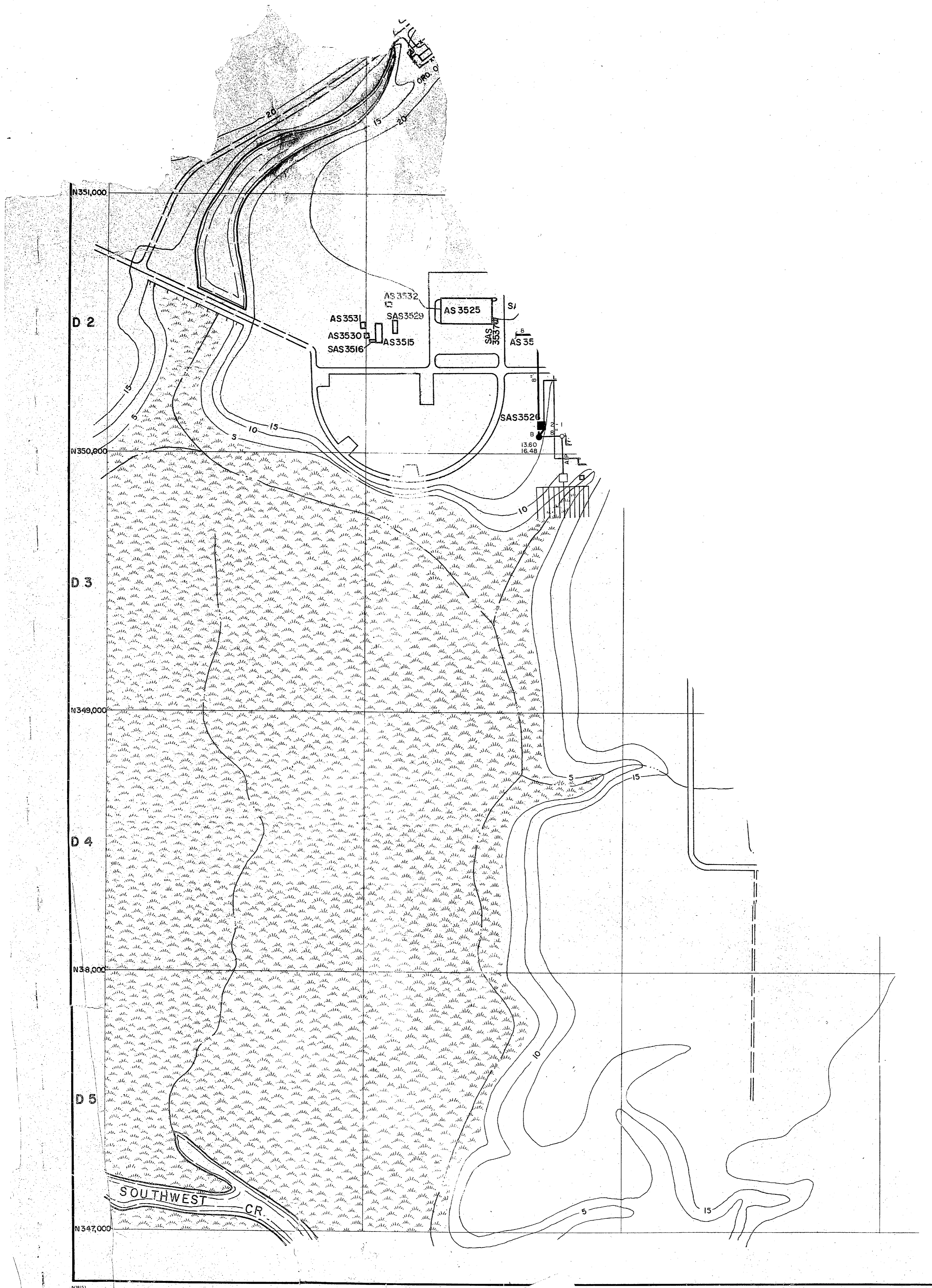

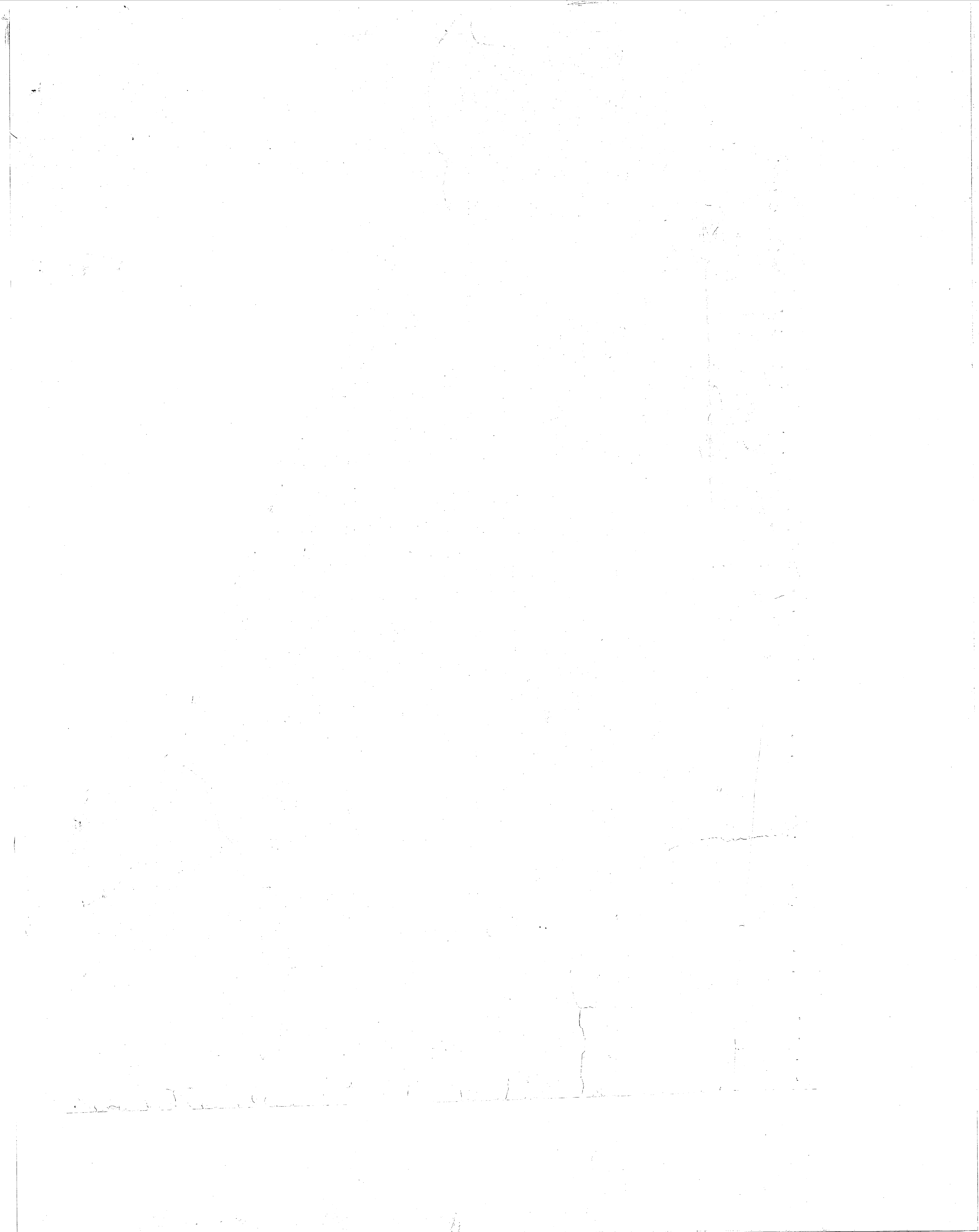





REVISIONS		DATE	APPROVED
SYM	DESCRIPTION		

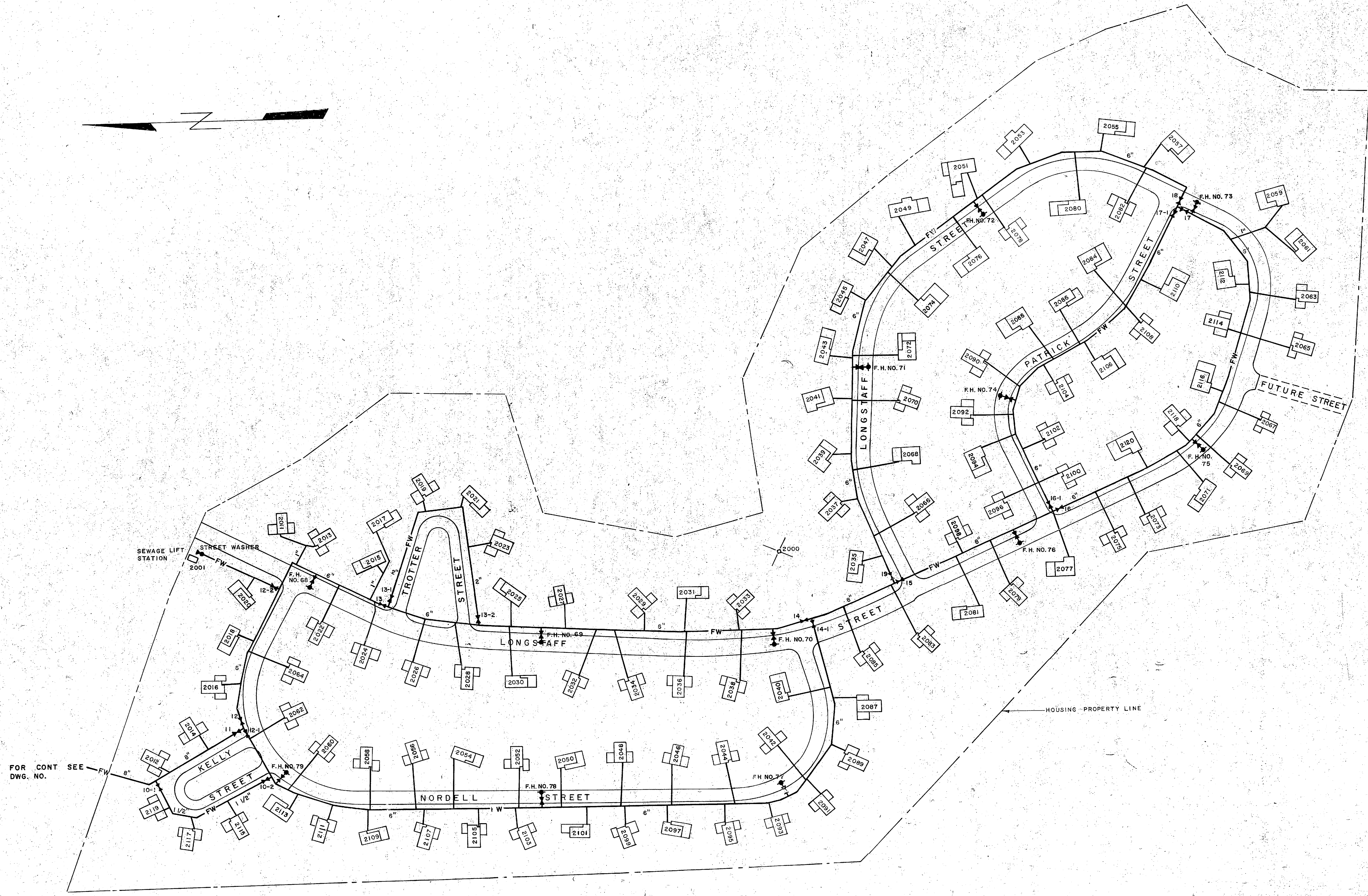
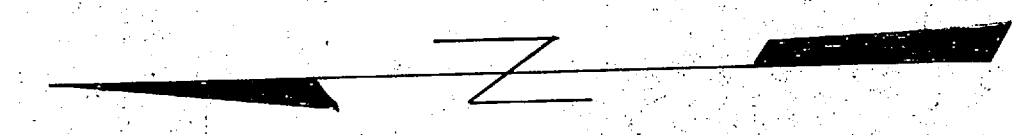

M.O.Q. HOUSING AREA

GENERAL NOTES
 1 ALL HOUSE LATERALS ARE 3/4" EXCEPT 4" NOTED.

LEGEND

— FW	EXISTING FRESH WATER MAIN
— I-2-7	GATE VALVE & NO.
— F.H. NO. 1	FIRE HYDRANT NO. & VALVE
—	STREET WASHER
—	EXISTING STRUCTURE

FOR CONT SEE DWG. NO.

5 OF 7

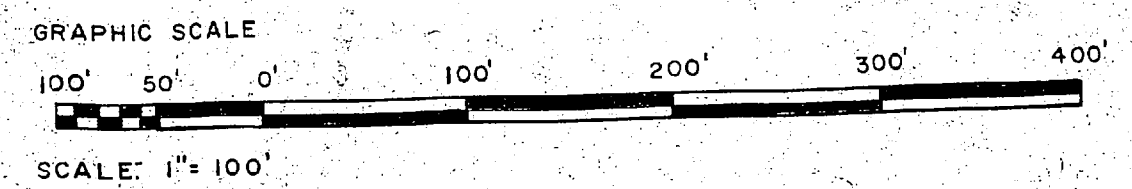

PUBLIC WORKS DEPT. MARINE CORPS BASE CAMP LEJEUNE, N.C.		DEPARTMENT OF THE NAVY NAVAL FACILITIES ENGINEERING COMMAND ATLANTIC DIVISION NORFOLK, VIRGINIA	
DESIGNED BY: DR		NAVAL STATION: MARINE CORPS BASE, CAMP LEJEUNE, N.C.	
APPROVED BY: [Signature]		DATE: _____	
PUBLIC WORKS OFFICER		PROJECT: WATER SYSTEM	
SATSFACTORY TO: _____		MOQ	
COMMANDING GENERAL		MCAS(H)	
EFD: _____		SIZE: F	
APPROVED BY: [Signature]		CODE IDENT NO: 80091	
DATE: _____		PW DWG. 13300	
FOR COMMANDER, NAVFAC		CONSTR CONTR NO: _____	
SCALE: _____		SPEC: _____	



REVISIONS		
DESCRIPTION	DATE	APPROVED

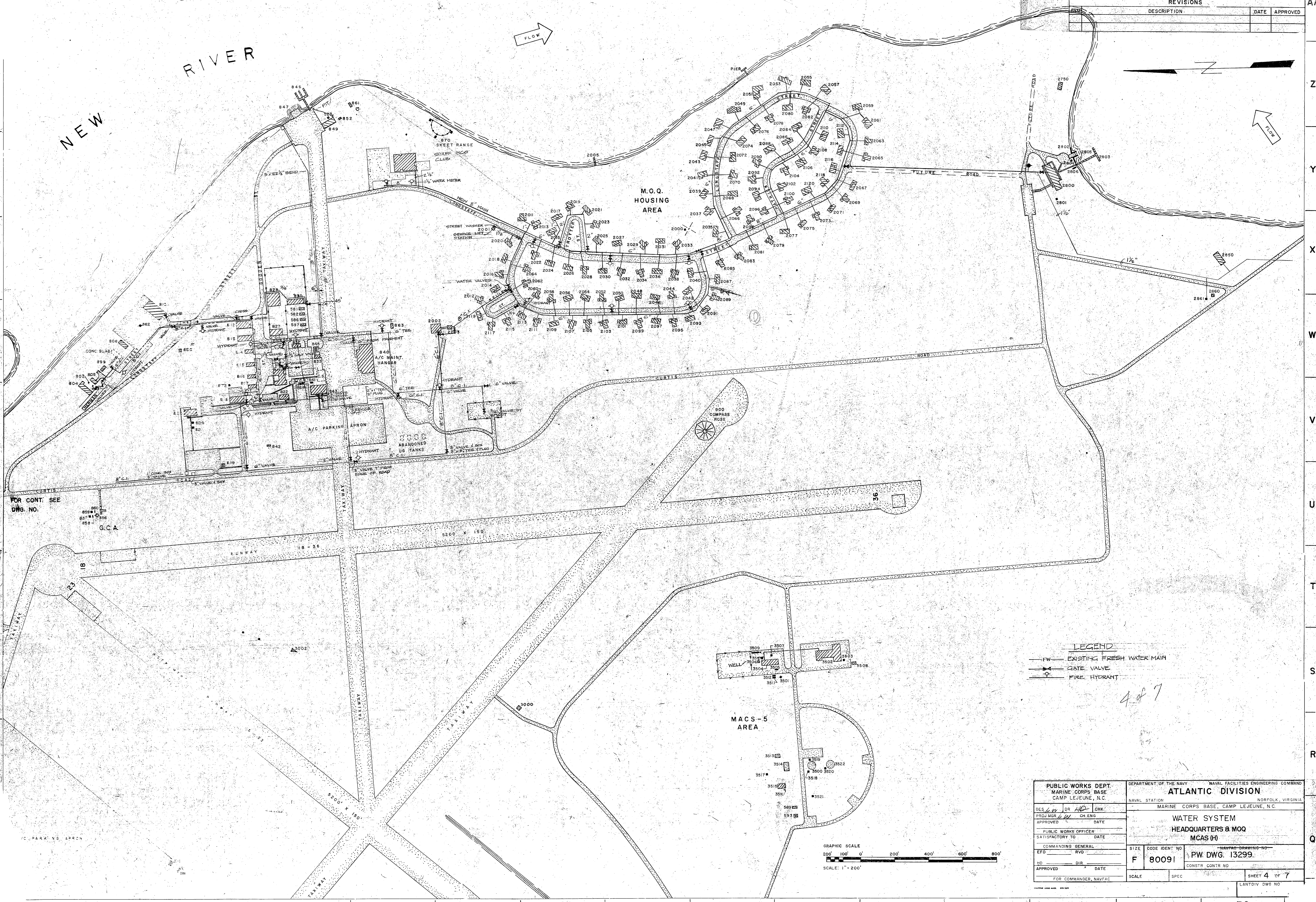

FOR CONT. SEE
DWG. NO. G.C.A.

427

LEGEND	
	EXISTING FRESH WATER MAIN
	GATE VALVE
	FIRE HYDRANT

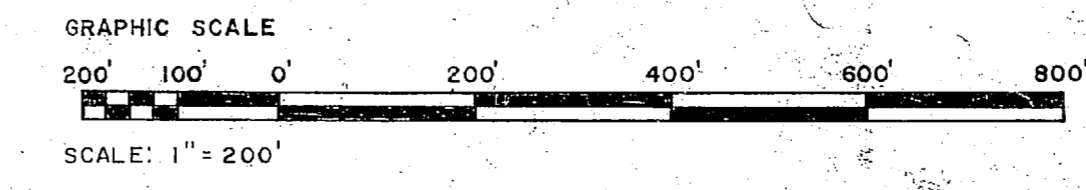

PUBLIC WORKS DEPT. MARINE CORPS BASE CAMP LEJEUNE, N.C.		DEPARTMENT OF THE NAVY NAVAL FACILITIES ENGINEERING COMMAND ATLANTIC DIVISION NAVAL STATION NORFOLK, VIRGINIA	
DESIGNED BY: [Signature]		MARINE CORPS BASE, CAMP LEJEUNE, N.C.	
APPROVED: [Signature]		WATER SYSTEM HEADQUARTERS & MOQ MCAS (H)	
COMMANDING GENERAL		SIZE CODE IDENT NO. NAVFAC DRAWING NO.	
EFD: [Signature]		F 80091 PW DWG. 13299	
APPROVED: [Signature]		CONSTR CONTR NO.	
FOR COMMANDER, NAVFAC		SCALE SPEC SHEET 4 OF 7	
		LANTDIV DWG NO.	

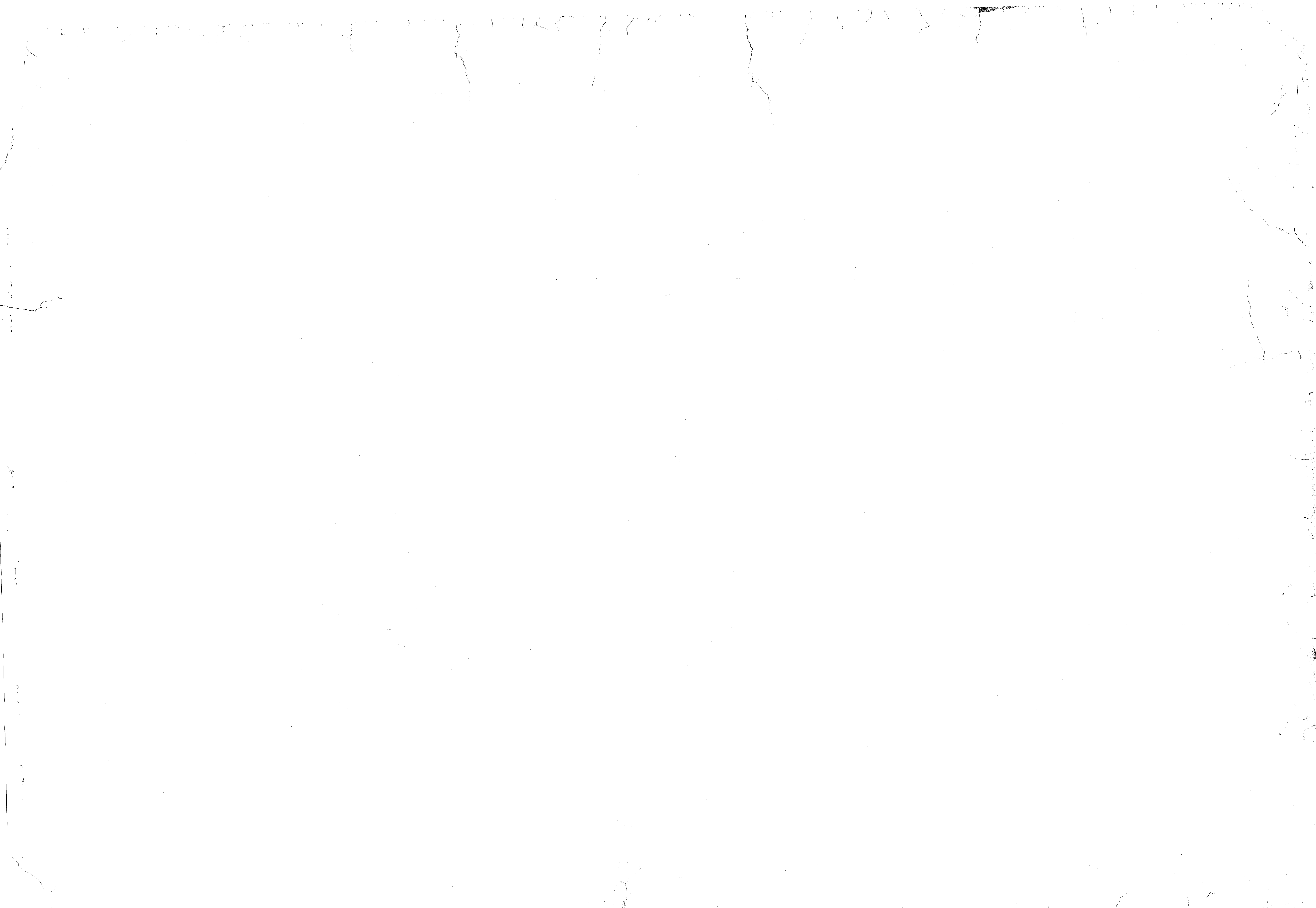

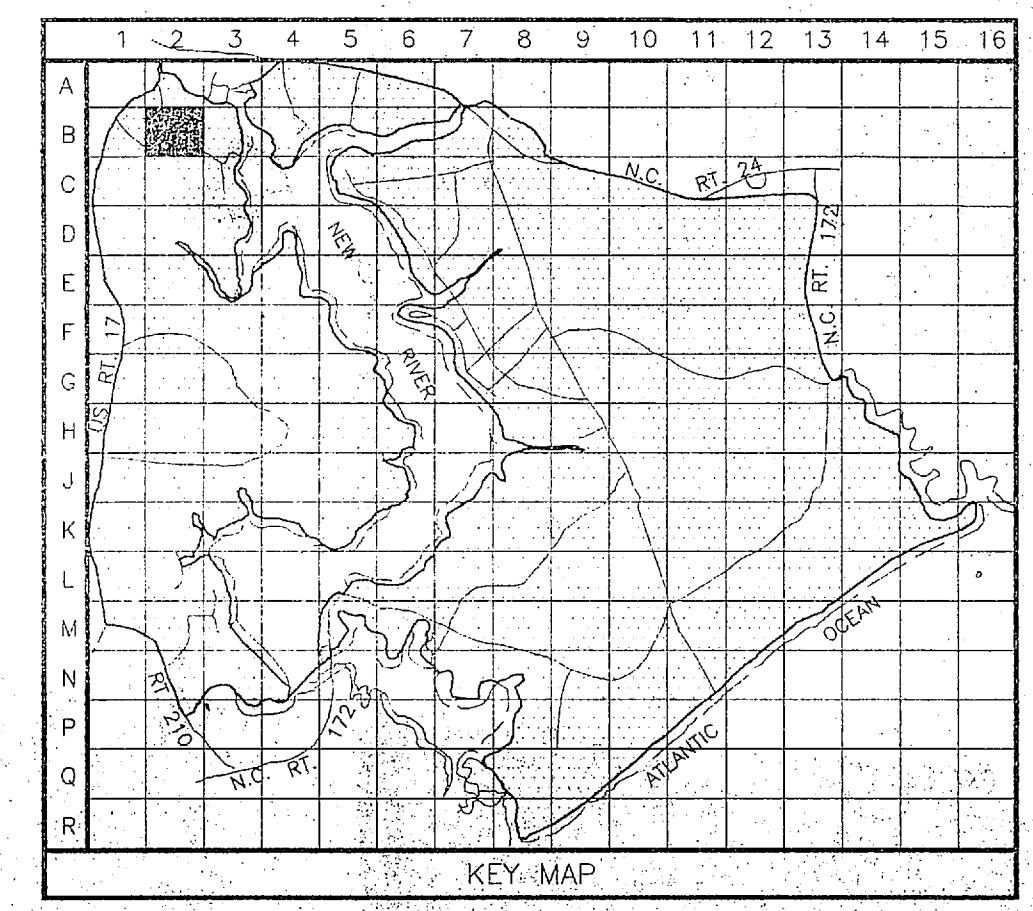
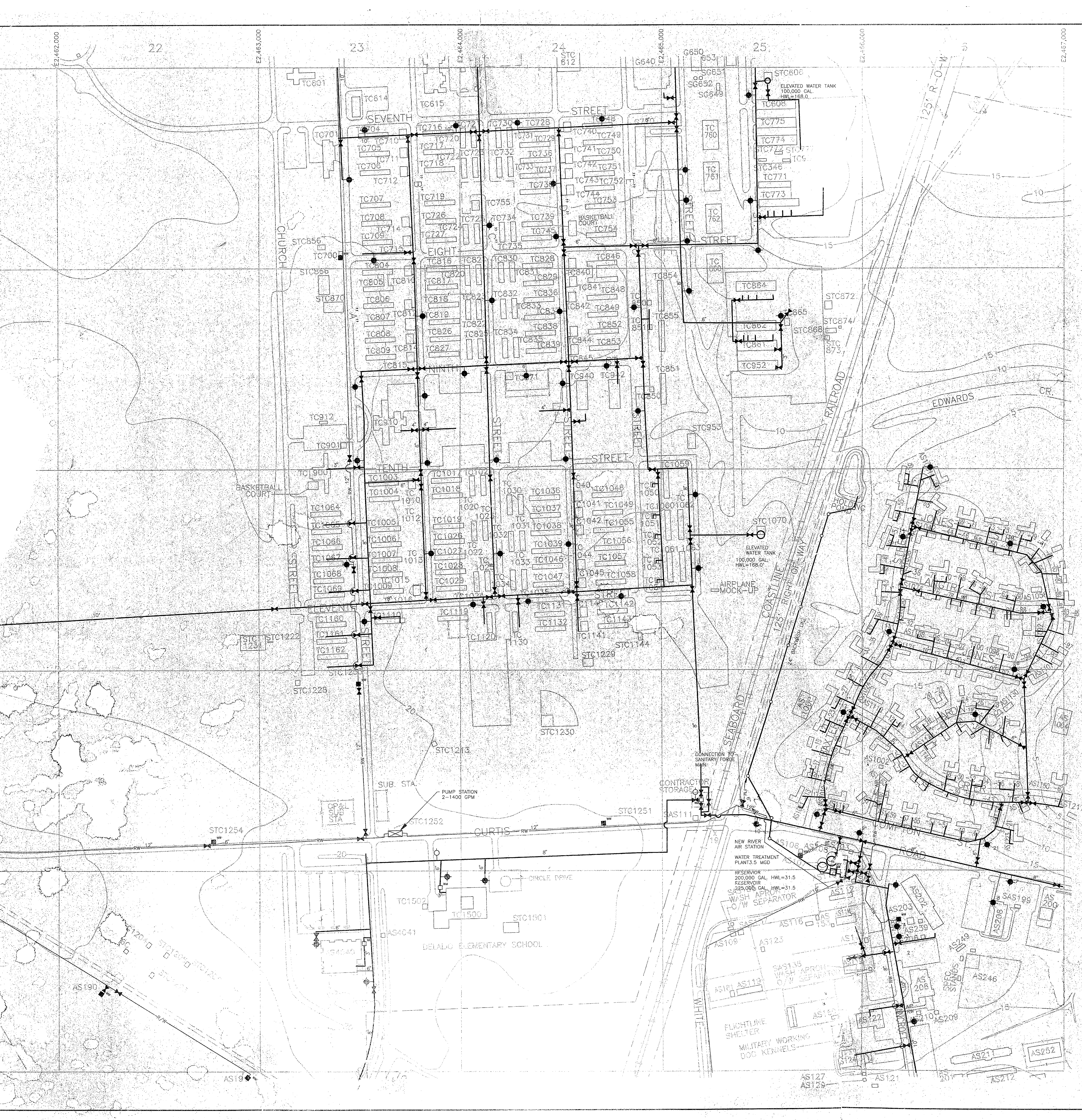

LEGEND

- BUILDINGS AND STRUCTURES
- ROADS AND HIGHWAYS
- ROADS (Unpaved)
- FENCE
- 5' CONTOUR (Source - USGS Maps)
- AIR STATION BOUNDARY
- POTABLE WATER MAIN
- RAW WATER MAIN
- POST INDICATOR VALVE
- FIRE HYDRANT
- ABANDONED IN PLACE
- PUMPING STATION
- WATER WELL
- GROUND STORAGE TANK
- ELEVATED STORAGE TANK
- WATER METER
- VALVE
- AIR RELEASE VALVE
- CAPPED MAIN
- VALVE
- FIRE HYDRANT W/ VALVE

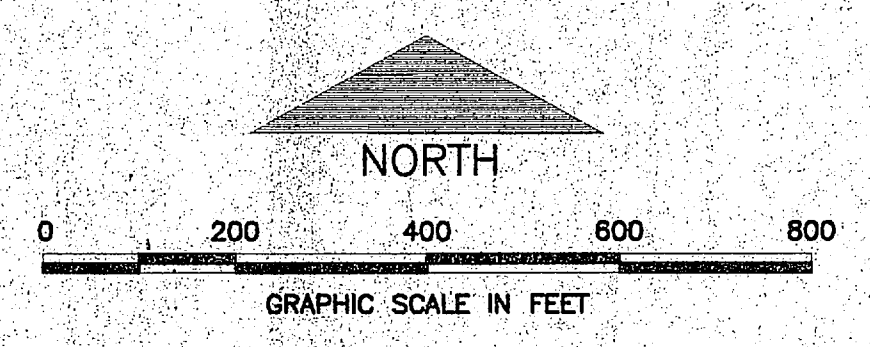

B-2

NO.	DESCRIPTION OF REVISION	DATE	INT.
DEPARTMENT OF THE NAVY MARINE CORPS BASE CAMP LEJEUNE, NORTH CAROLINA			
WATER DISTRIBUTION SYSTEM EXISTING CONDITIONS			
DATE:	SCALE: GRAPHIC	SHEET	OF
APPROVED/DATE:			



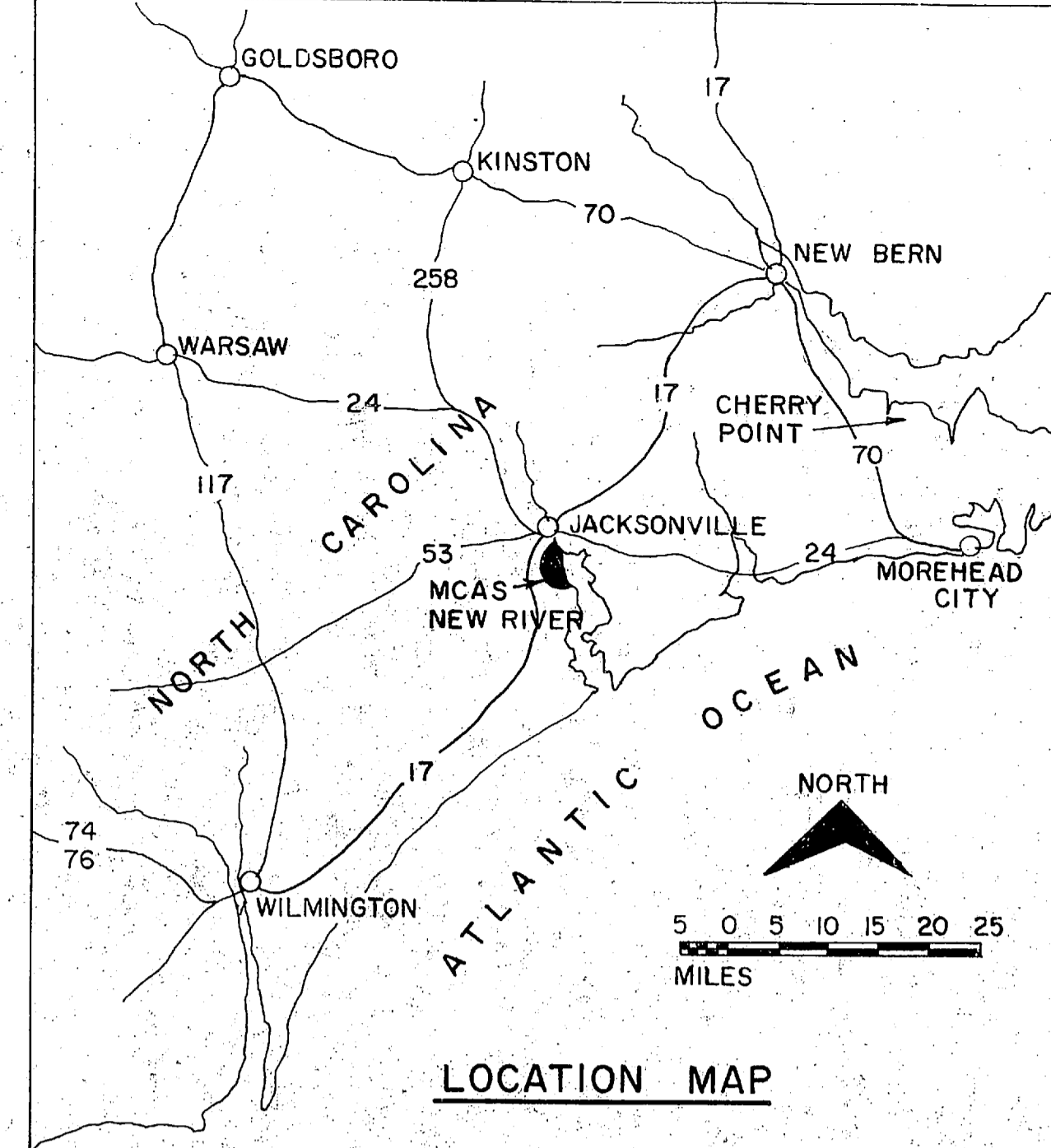
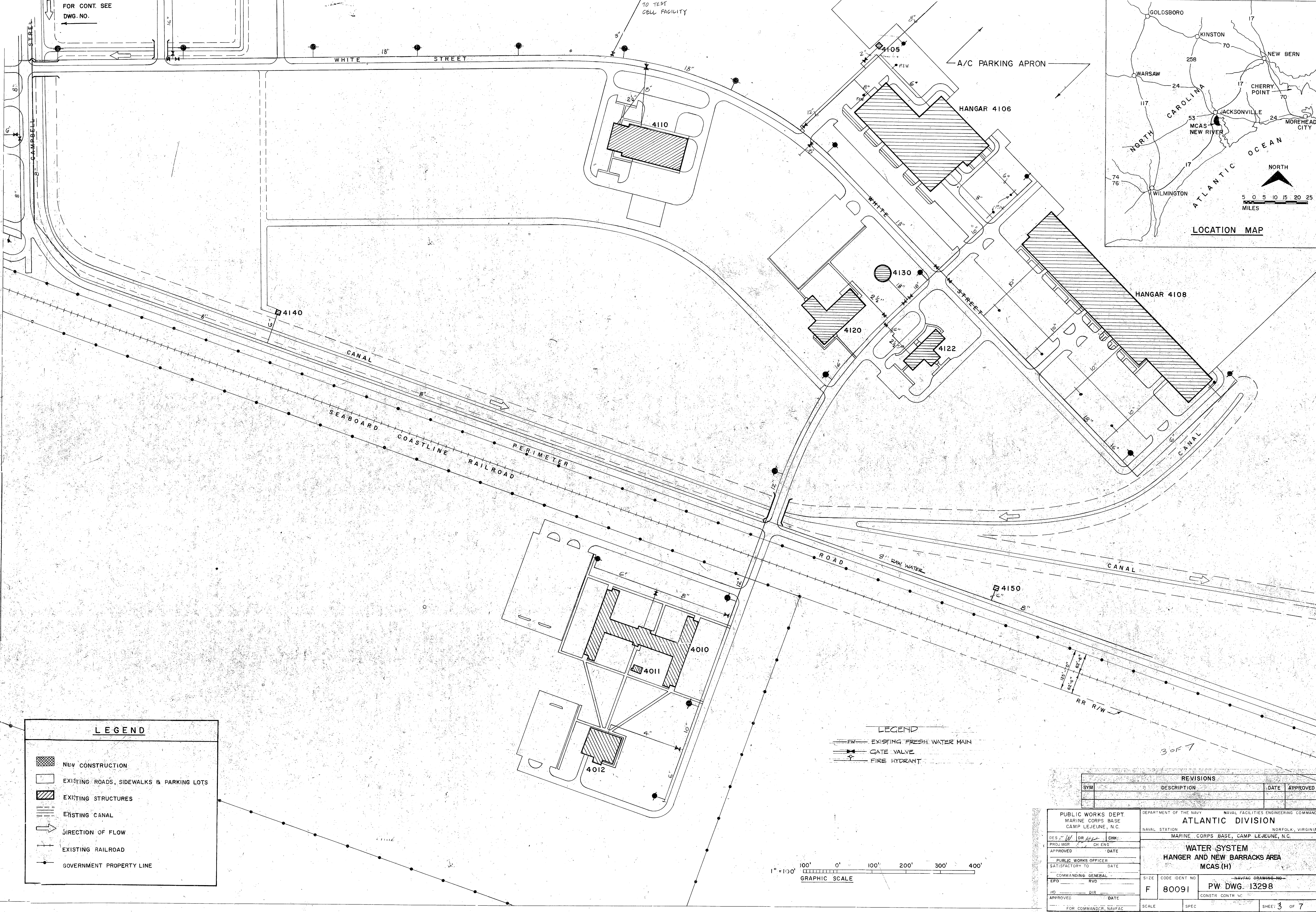

LEGEND

- NEW CONSTRUCTION
- EXISTING ROADS, SIDEWALKS & PARKING LOTS
- EXISTING STRUCTURES
- EXISTING CANAL
- DIRECTION OF FLOW
- EXISTING RAILROAD
- GOVERNMENT PROPERTY LINE

LEGEND

- EXISTING FRESH WATER MAIN
- GATE VALVE
- FIRE HYDRANT

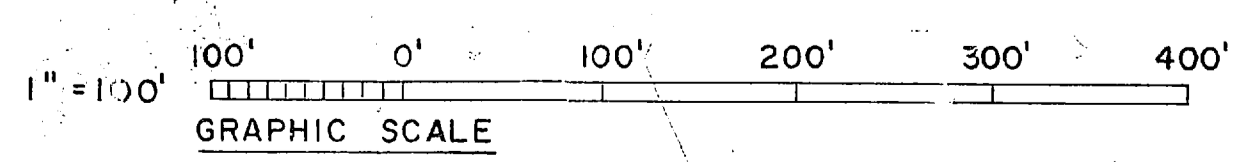

REVISIONS			
SYM	DESCRIPTION	DATE	APPROVED

PUBLIC WORKS DEPT MARINE CORPS BASE CAMP LEJEUNE, N.C.		DEPARTMENT OF THE NAVY NAVAL FACILITIES ENGINEERING COMMAND ATLANTIC DIVISION NAVAL STATION MARINE CORPS BASE, CAMP LEJEUNE, N.C.	
DESIGNED BY: DR	CHECKED BY: CH	DATE	
APPROVED BY: PW	DATE	DATE	
SATSFACTORY TO: DATE		DATE	
COMMANDING GENERAL	RVD	SIZE	CODE IDENT NO
HD	DIR	F	80091
APPROVED BY: PW	DATE	SCALE	SPEC
FOR COMMANDER, NAVFAC		CONSTR. CONTR. NO.	
		PW DWG. 13298	
		SHEET 3 OF 7	

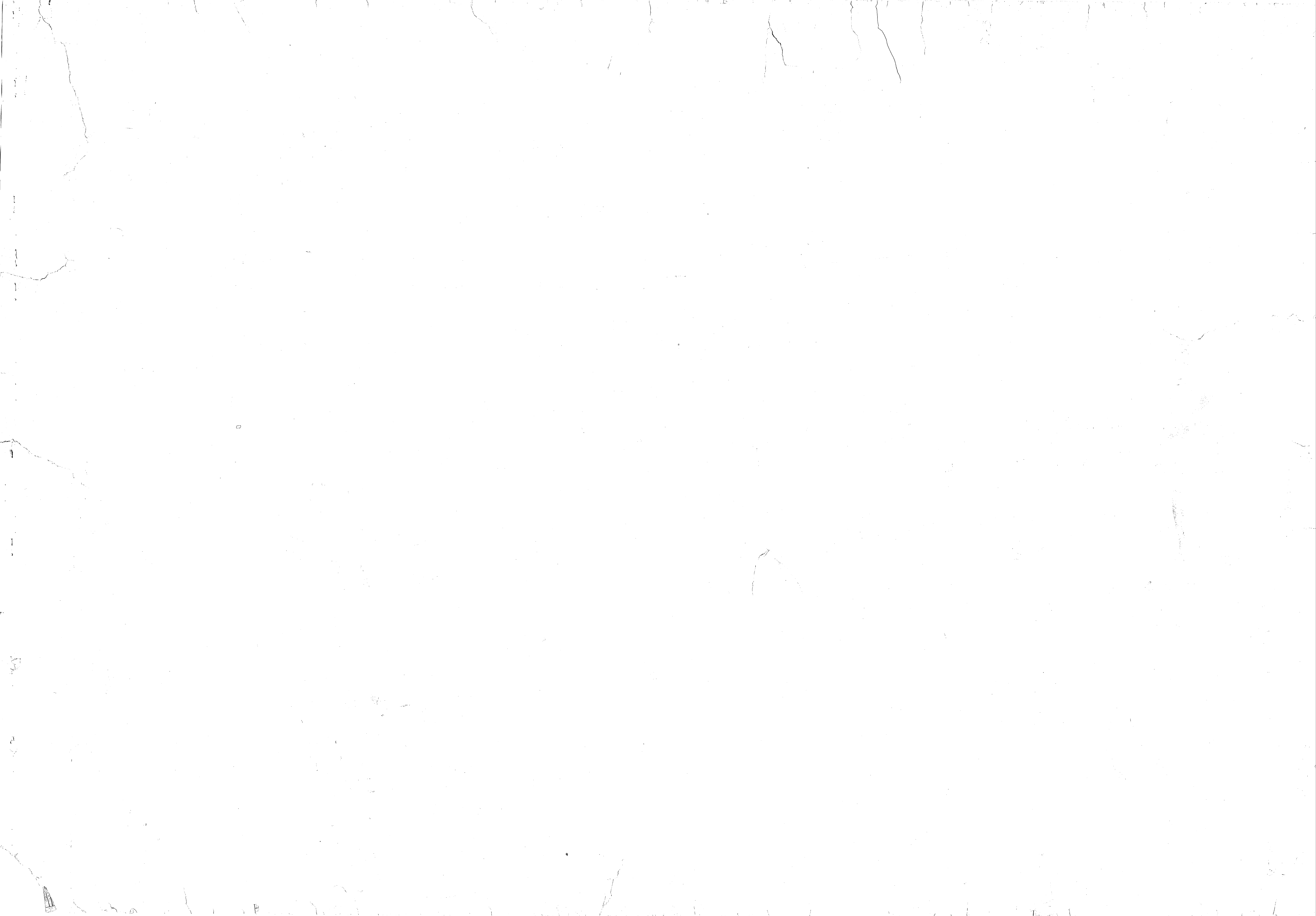

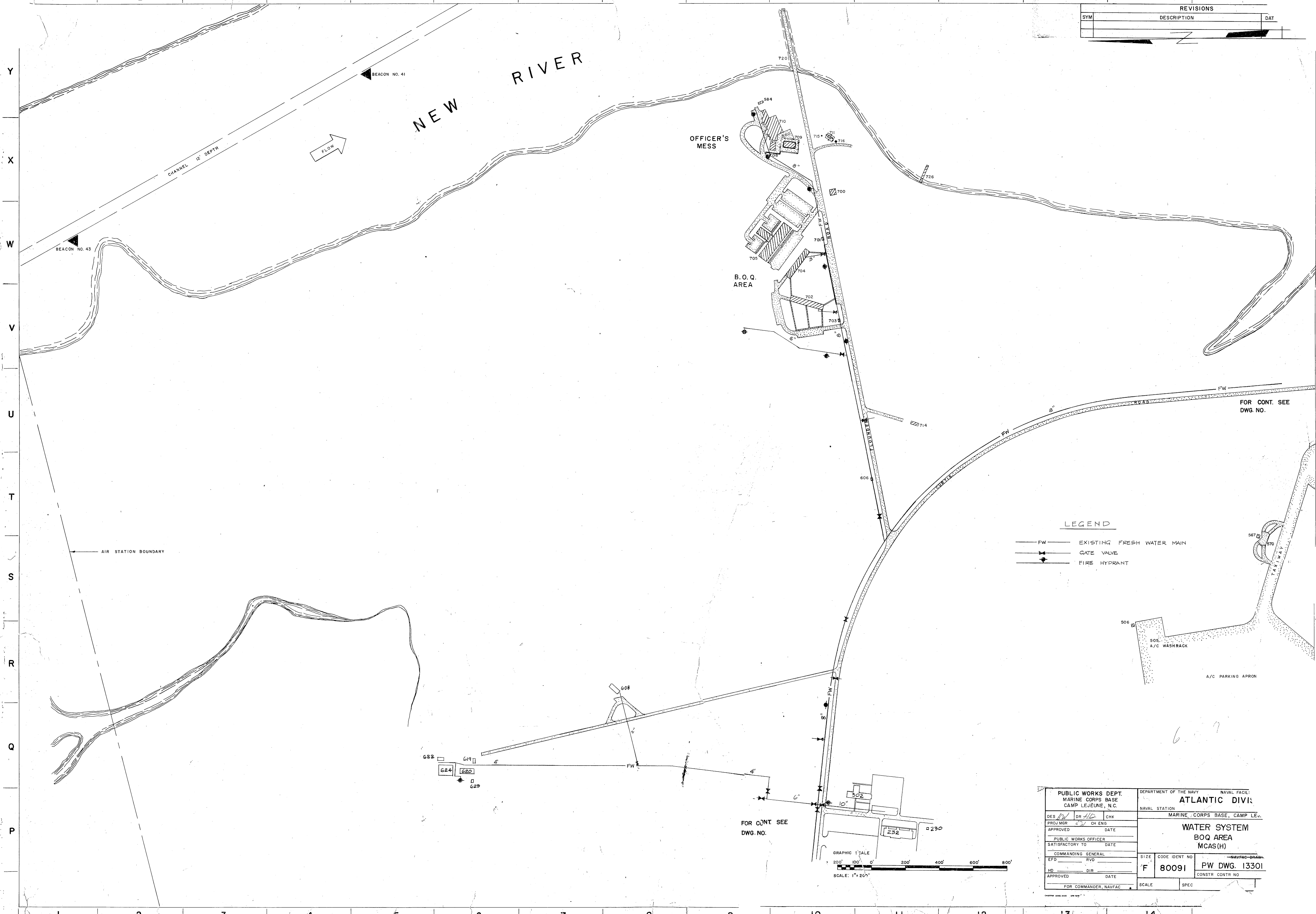

REVISIONS		
SYM	DESCRIPTION	DAT

LEGEND

	EXISTING FRESH WATER MAIN
	GATE VALVE
	FIRE HYDRANT

PUBLIC WORKS DEPT. MARINE CORPS BASE CAMP LEJUNE, N.C.		DEPARTMENT OF THE NAVY NAVAL FACILITY ATLANTIC DIVISION	
DESIGNED BY: DR. H. L.	CHKD BY: CH. ENG.	NAVAL STATION MARINE CORPS BASE, CAMP LEJUNE	
APPROVED: [Signature]	DATE: [Blank]	WATER SYSTEM BOQ AREA MCAS(H)	
SATISFACTORY TO: [Blank]	DATE: [Blank]	SIZE: F	CODE IDENT NO: 80091
COMMANDING GENERAL: [Blank]	DATE: [Blank]	PW DWG. 13301	
EFD: [Blank]	RVD: [Blank]	CONSTR CONTR NO: [Blank]	
HD: [Blank]	DIR: [Blank]	SCALE: [Blank]	SPEC: [Blank]
APPROVED: [Signature]		DATE: [Blank]	
FOR COMMANDER, NAVFAC			

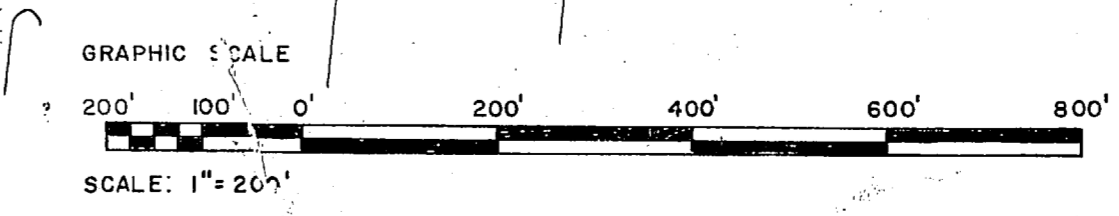

FOR CONT. SEE
DWG. NO.

FOR CONT. SEE
DWG. NO.

AIR STATION BOUNDARY

1 2 3 4 5 6 7 8 9 10 11 12 13 14 15

Y
X
W
V
U
T
S
R
Q
P

NEW RIVER

BEACON NO. 41

BEACON NO. 43

CHANNEL 12' DEPTH

FLOW

OFFICER'S MESS

B.O.Q. AREA

720

722 584

710

709

715

716

700

705

704

702

703

726

722 114

606

608

622

619

624

620

623

FW

8"

6"

10"

302

232

230

567

570

506

505

A/C WASHRACK

A/C PARKING APRON

LEGEND

FW EXISTING FRESH WATER MAIN

X GATE VALVE

Circle with cross FIRE HYDRANT

GRAPHIC SCALE

SCALE: 1" = 200'

FOR CONT. SEE DWG. NO.

FOR CONT. SEE DWG. NO.

AIR STATION BOUNDARY

REVISIONS

SYM DESCRIPTION DAT

PUBLIC WORKS DEPT. MARINE CORPS BASE CAMP LEJUNE, N.C.

DEPARTMENT OF THE NAVY NAVAL FACILITY ATLANTIC DIVISION

NAVAL STATION MARINE CORPS BASE, CAMP LEJUNE

WATER SYSTEM BOQ AREA MCAS(H)

DESIGNED BY: DR. H. L. CHKD BY: CH. ENG.

APPROVED: [Signature] DATE: [Blank]

SATISFACTORY TO: [Blank] DATE: [Blank]

COMMANDING GENERAL: [Blank] DATE: [Blank]

EFD: [Blank] RVD: [Blank]

HD: [Blank] DIR: [Blank]

APPROVED: [Signature] DATE: [Blank]

FOR COMMANDER, NAVFAC

SIZE: F CODE IDENT NO: 80091 PW DWG. 13301

CONSTR CONTR NO: [Blank]

SCALE: [Blank] SPEC: [Blank]

