

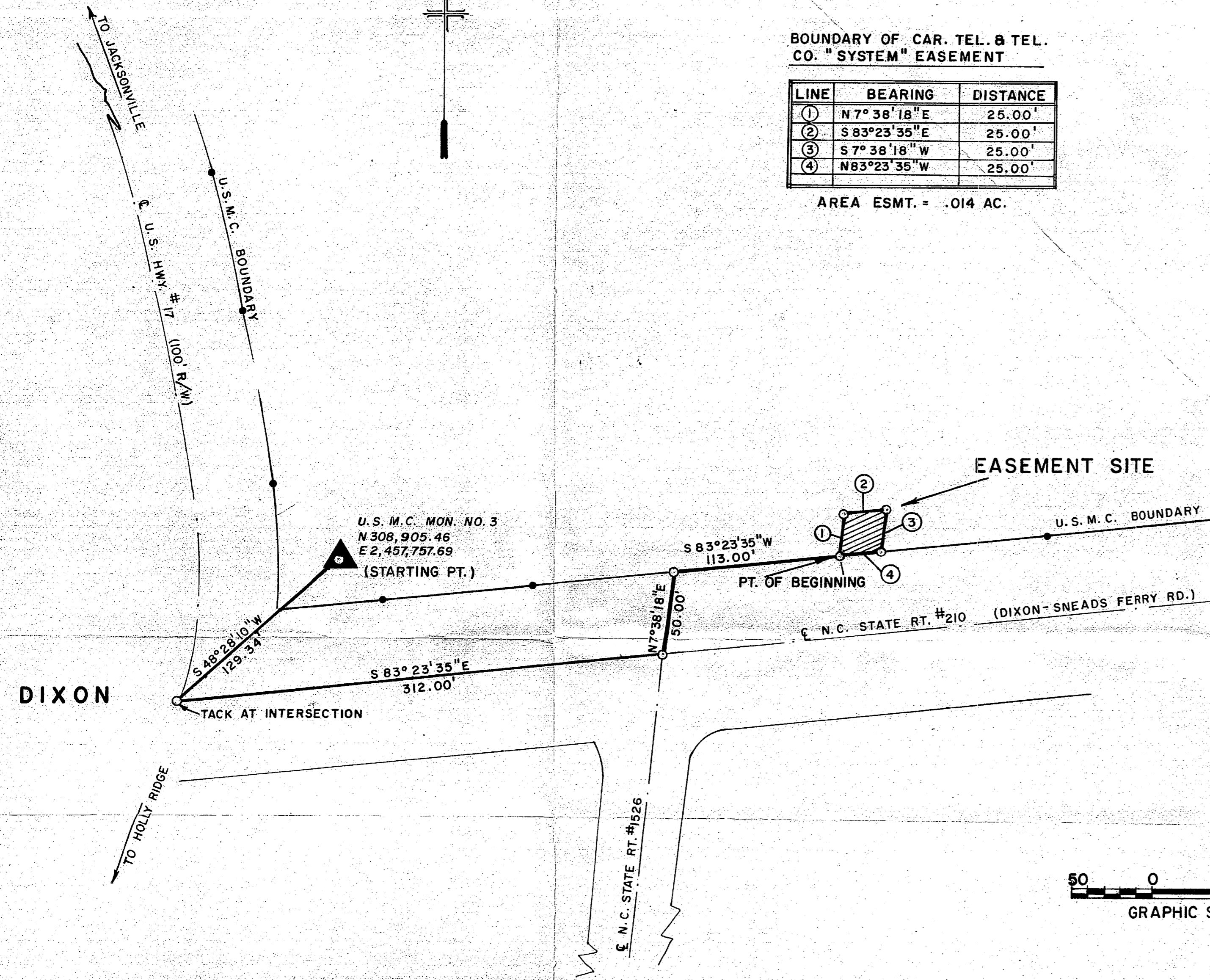

**BOUNDARY OF CAR. TEL. & TEL. CO. "SYSTEM" EASEMENT**

LINE	BEARING	DISTANCE
①	N 7° 38' 18" E	25.00'
②	S 83° 23' 35" E	25.00'
③	S 7° 38' 18" W	25.00'
④	N 83° 23' 35" W	25.00'

AREA ESMT. = .014 AC.



**LEGEND**

●—● GOV. PROPERTY LINE

▨ EASEMENT (25' X 25')

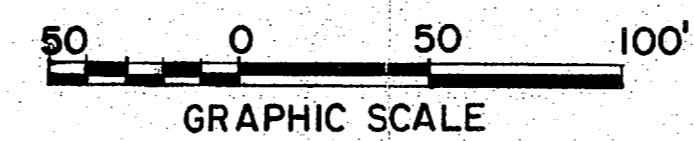

ATLANTIC DIVISION  
NAVAL FACILITIES ENGINEERING COMMAND

EASEMENT FOR SUBSCRIBER CARRIER SYSTEM  
(CAROLINA TEL. & TEL. CO.)  
AT THE MARINE CORPS BASE  
CAMP LEJEUNE, NORTH CAROLINA

APPROVED: \_\_\_\_\_ DATE: 20 OCT. 1986 SK-C-19-86

