

SEE P.W. DRAWING NO. 14405

Scale is Approximate Only - Not to be used for Firing
 8000 0 2000 4000 6000 8000 10000
 SCALE OF FEET

PUBLIC WORKS DEPT. MARINE CORPS BASE CAMP LEJEUNE, N.C.		DEPARTMENT OF THE NAVY NAVAL FACILITIES ENGINEERING COMMAND ATLANTIC DIVISION	
DESIGNED BY: <i>EGJ</i>		NAVAL STATION: MARINE CORPS BASE, CAMP LEJEUNE, N.C.	
DRAWN BY: <i>EGJ</i>		DATE: <i>7/17/58</i>	
APPROVED BY: <i>EGJ</i>		DATE: <i>7/17/58</i>	
PUBLIC WORKS OFFICER FOR THE DISTRICT		GENERAL SUPERVISOR	
DATE: _____		DATE: _____	
COMMISSARY GENERAL		SIZE: CODE IDENT NO.	
EFD: _____		F 80091	
ND: _____		DRAWING NO. 14393	
APPROVED: _____		CONSTR. CONTR. NO.	
DATE: _____		SCALE: 1"=2000'	
FOR COMMANDER, NAVAL		SPEC: _____	
		SHEET 1 OF 17	
		LANTION: SWP-NO	



1111

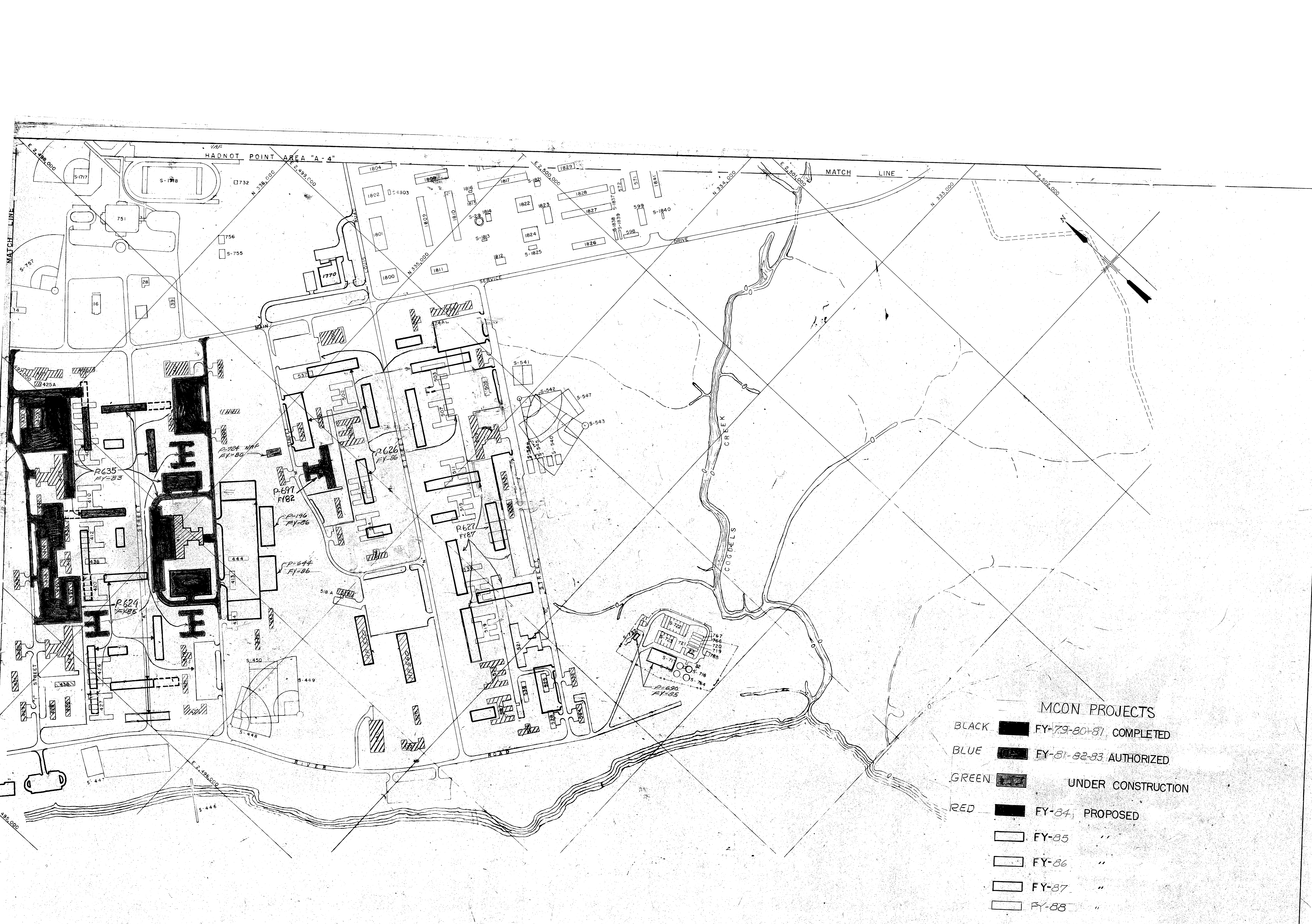

- MCON PROJECTS**
- BLACK ■ FY-79-80-81, COMPLETED
 - BLUE ■ FY-81-82-83 AUTHORIZED
 - GREEN ■ UNDER CONSTRUCTION
 - RED ■ FY-84, PROPOSED
 - FY-85 "
 - FY-86 "
 - FY-87 "
 - FY-88 "

N E W R I V E R

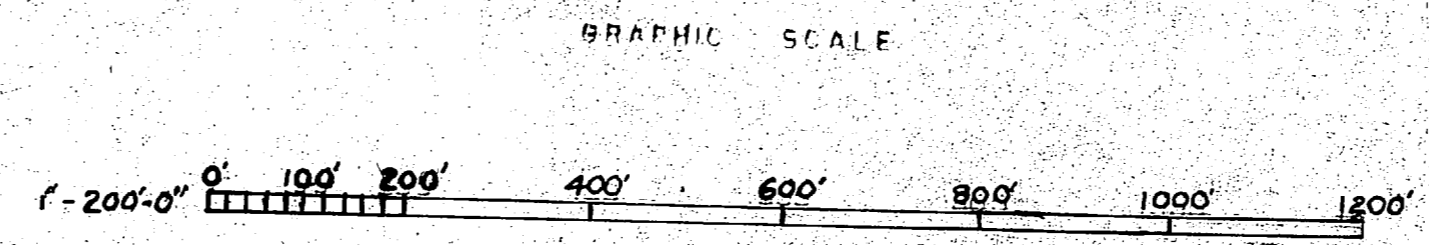

REVISIONS	
SYM	DESCRIPTION DATE APPROVED

PUBLIC WORKS DEPT. MARINE CORPS BASE CAMP LEJEUNE, N.C.		DEPARTMENT OF THE NAVY NAVAL FACILITIES ENGINEERING COMMAND ATLANTIC DIVISION MARINE CORPS BASE, CAMP LEJEUNE, N.C.	
DES	DR	CHK	EGJ
PROG	EGJ	CH	ENGR
DATE	DATE	DATE	DATE
COMMANDED GENERAL		GENERAL LEVOTIENI MAP	
HD	RVD	SIZE	CODE IDENT NO
		F	80091
APPROVED	DIR	DATE	CONSTR CONTR NO
FOR COMMANDER, NAVFAC		SCALE	1" = 200' SPEC
		SHEET 3 OF 17	
		LANDIV DWG NO	

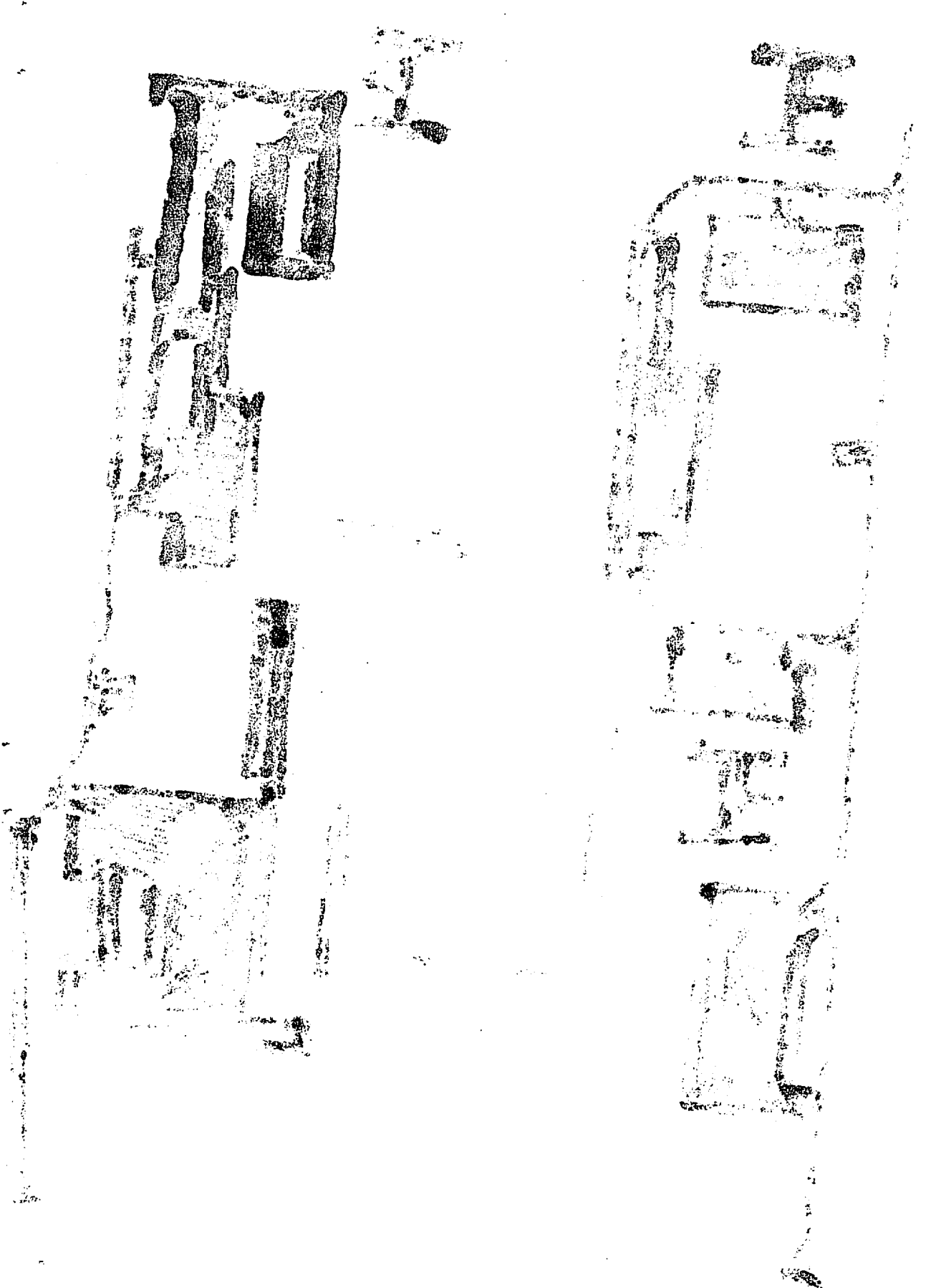

11

11

UNIT	GEOG AREA	AUTO ORG SH 214-51	FLD MAINT SH 215-60	C/A TRK VH SH 214-50	EL COM MNT SH 217-10	COM ELIX FLD SH 217-30	WAREHOUSE 441-12
MAR INFT REG	2ND AREA	P-525 25,915 SF			P-643 29,775 SF		P-507 50,760 SF
MAR INFT REG	1ST AREA	P-526 25,915 SF			P-527 29,775 SF		P-508 50,760 SF
MAR INFT REG	4TH AREA	P-196 25,915 SF			P-644 29,775 SF		P-509 50,760 SF
MAR ART REG	DIV SHOP AREA				P-229 36,280 SF		P-510 83,438 SF
1ST, 2ND & 3RD BN	" " "	P-138 42,636 SF					
4TH BN	" " "	P-092 8,840 SF	P-678 ADD 8,800 SF				
5TH BN	" " "	P-255 18,815 SF					
HQ BN & TRUCK COMPANY	" " "	P-530 19,230 SF	P-137 18,668 SF	P-139 58,940 SF	P-175 24,900 SF	P-133 14,920 SF	P-511 48,360 SF
TANK BN	" " "	P-536 73,891 SF			P-536 6,100 SF		P-536 12,000 SF
ENGR BN	" " "	P-503 21,000 SF			P-565 8,084 SF		P-567 24,360 SF
RECON BN	BEACH AREA	P-568 8,500 SF			P-569 6,316 SF		P-516 16,240 SF

EXIST VADUATE
FACILITY

LEGEND
 [Hatched Box] EXIST FACILITY (PERMANENT)
 [Dashed Box] EXIST FAC (SEMI-PERMANENT OR TEMPORARY)
 [Solid Box] PLANNED FACILITIES

MCON PROJECTS

BLACK ■ FY-79-80-81 COMPLETED
 BLUE ■ FY-81-82-83 AUTHORIZED
 GREEN ■ UNDER CONSTRUCTION
 RED ■ FY-84 PROPOSED
 □ FY-85 "
 □ FY-86 "
 □ FY-87 "
 □ FY-88 "

REVISIONS		DATE	APPROVED
SYM	DESCRIPTION		

PUBLIC WORKS DEPT MARINE CORPS BASE CAMP LEJEUNE, N.C.		DEPARTMENT OF THE NAVY NAVAL FACILITIES ENGINEERING COMMAND ATLANTIC DIVISION NORFOLK, VIRGINIA	
DESIGNED BY: E.G. CHENG		CHECKED BY: E.G. CHENG	
APPROVED BY: [Signature]		DATE: 6/12/81	
PUBLIC WORKS OFFICER: [Signature]		DATE: 6/12/81	
SATISFACTORY TO: [Signature]		DATE: 6/12/81	
COMMANDING GENERAL		SIZE	CODE IDENT NO
[Signature]		F	80091
APPROVED BY: [Signature]		CONSTR CONTR NO	
FOR COMMANDER, NAVFAC		SCALE	SPEC
		SHEET 2 OF 17	
		LAND DIV DWG NO	

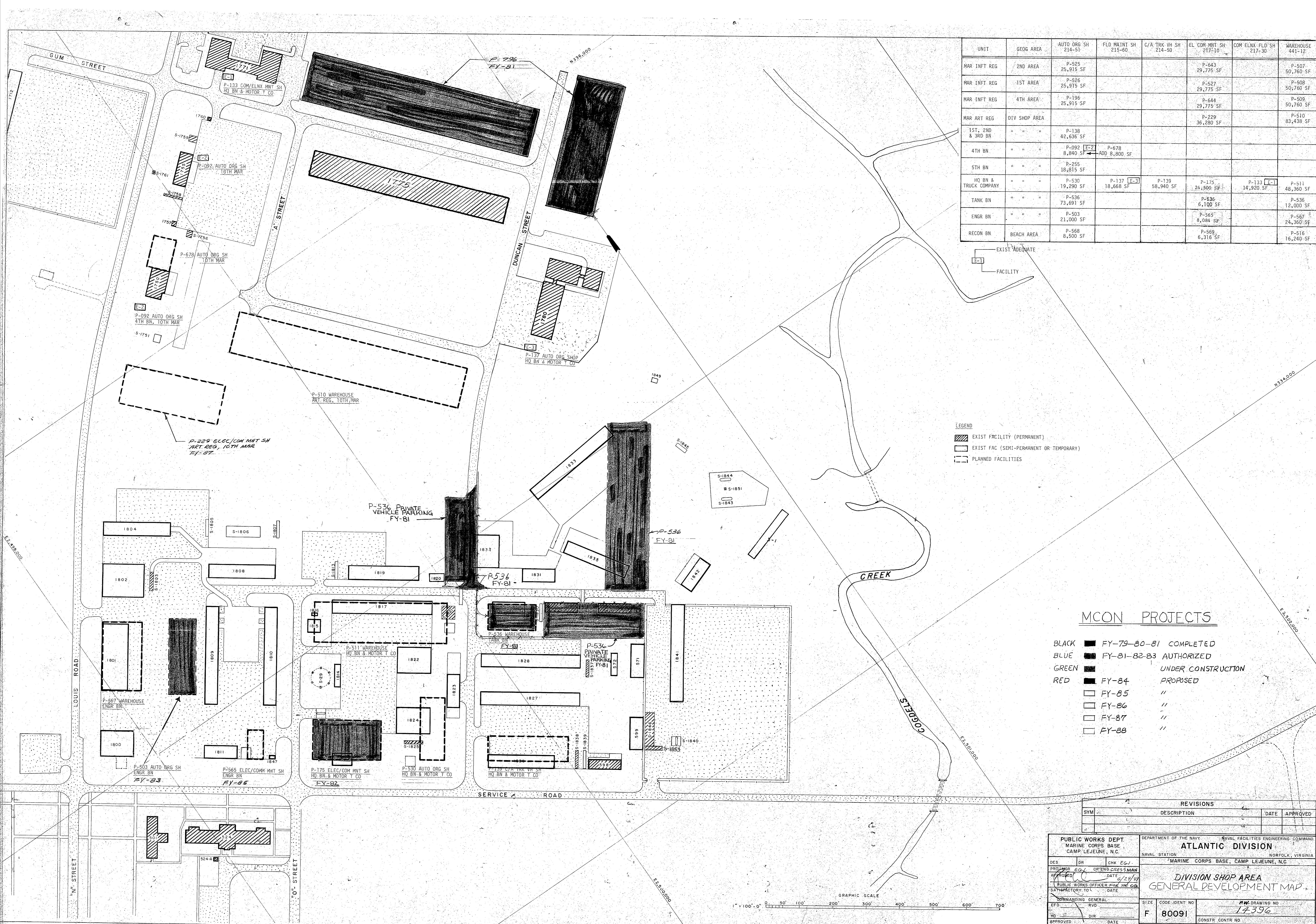
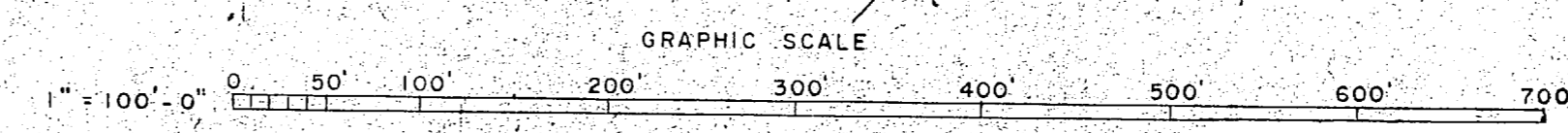

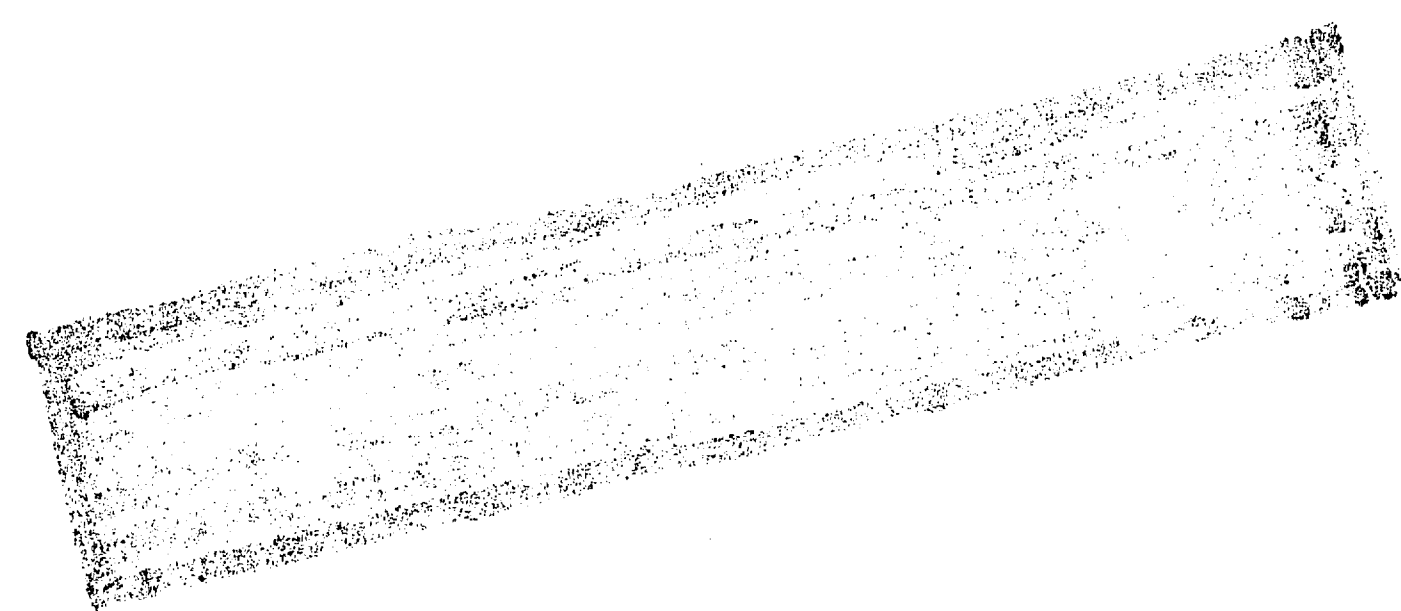
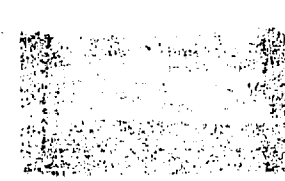
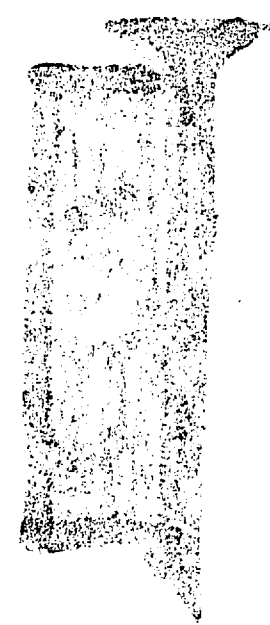
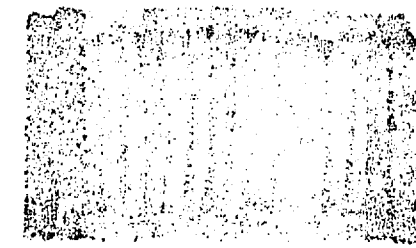
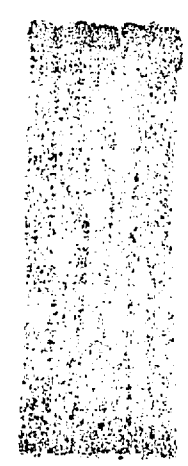

228

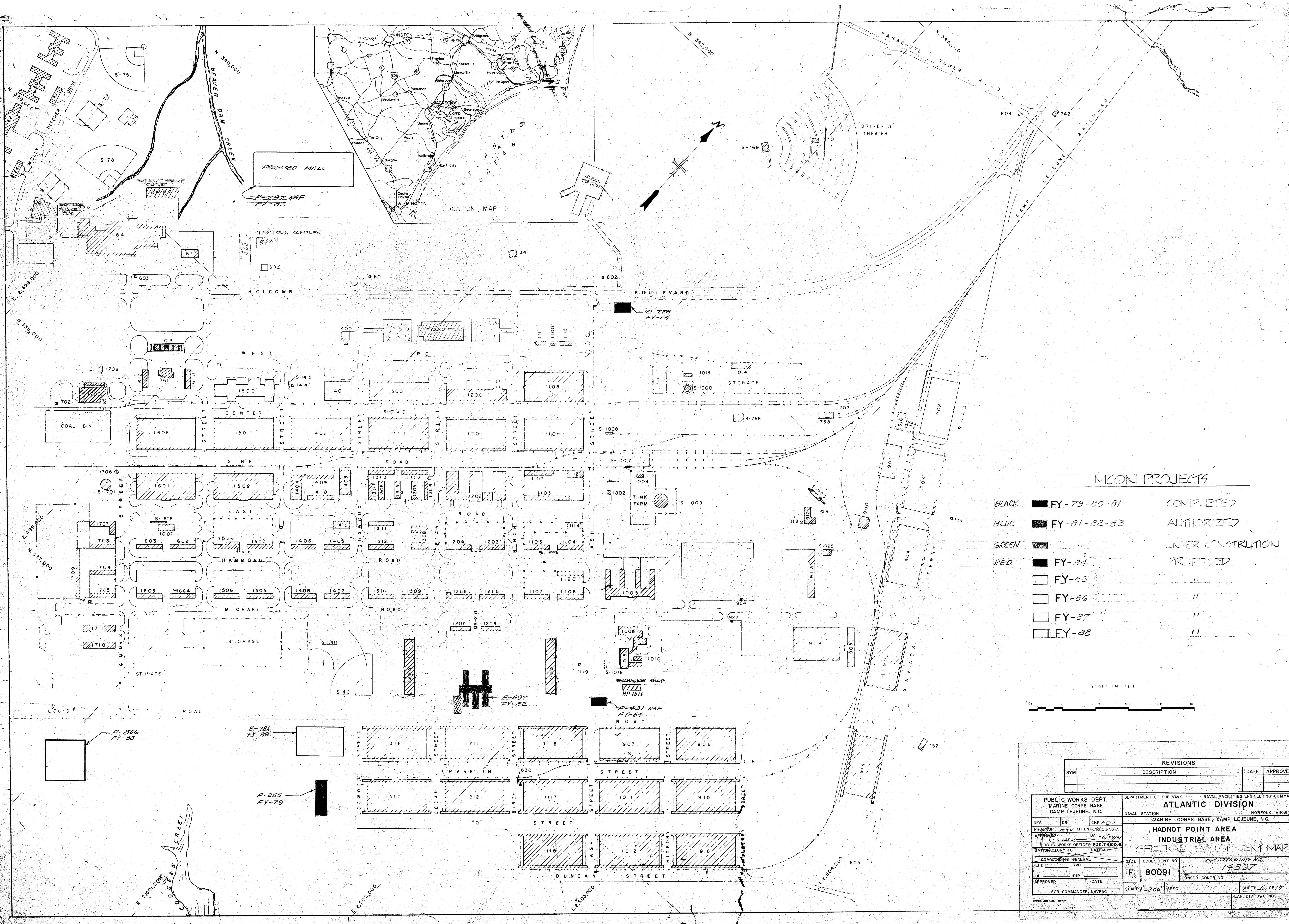

CON PROJECTS

BLACK	FY-79-80-81	COMPLETED
BLUE	FY-81-82-83	AUTHORIZED
GREEN		UNDER CONSTRUCTION
RED	FY-84	PROPOSED
	FY-85	"
	FY-86	"
	FY-87	"
	FY-88	"

SCALE IN FEET

REVISIONS		
SYM	DESCRIPTION	DATE APPROVED

PUBLIC WORKS DEPT. MARINE CORPS BASE CAMP LEJEUNE, N.C.		DEPARTMENT OF THE NAVY NAVAL FACILITIES ENGINEERING COMMAND ATLANTIC DIVISION MARINE CORPS BASE, CAMP LEJEUNE, N.C.	
DES	DR	CHK	EGJ
PROJECT	EGV	DR	EGV
DATE	4/7/74	DATE	4/7/74
PUBLIC WORKS OFFICER FOR TALKS		GENERAL DEVELOPMENT MAP	
COMMISSIONING GENERAL	RVD	SIZE	CODE IDENT NO
APPROVED	DATE	F	80091
FOR COMMANDER, NAVFAC		SCALE	1"=200' SPEC
		CONSTR CONTR NO	14397
		SHEET	5 OF 17
		LANTDIV DWG NO	

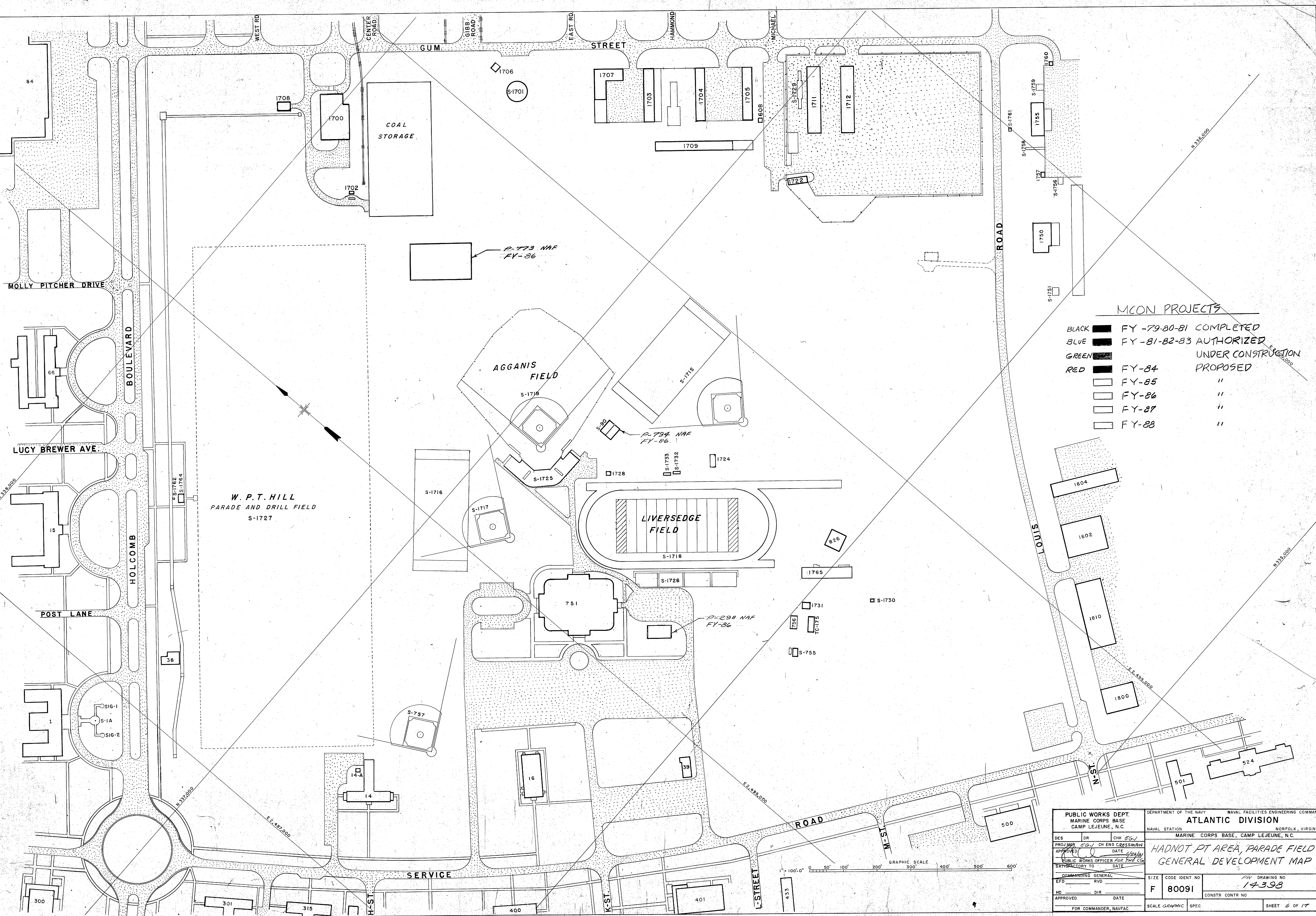

MCON PROJECTS

- BLACK ■ FY -79-80-81 COMPLETED
- BLUE ■ FY -81-82-83 AUTHORIZED
- GREEN ■ UNDER CONSTRUCTION
- RED ■ FY-84 PROPOSED
- FY-85 "
- FY-86 "
- FY-87 "
- FY-88 "

PUBLIC WORKS DEPT. MARINE CORPS BASE CAMP LEJEUNE, N.C.		DEPARTMENT OF THE NAVY NAVAL FACILITIES ENGINEERING COMMAND ATLANTIC DIVISION NORFOLK, VIRGINIA	
DES	DR	CHK	EGJ
PROJ	EGJ	CH ENG	CRESSMAN
APPROVED	DATE	DATE	DATE
PUBLIC WORKS OFFICER FOR THE CD		DATE	
SAP/REACTIVITY TO		DATE	
COMMODORING GENERAL	SIZE	CODE	IDENT NO
EPD	RVD	F	80091
HD	DIR	CONSTR	CONTR NO
APPROVED	DATE	SCALE	GRAPHIC SPEC
FOR COMMANDER, NAVFAC		SHEET 6 OF 17	

HADNOT PT AREA, PARADE FIELD
GENERAL DEVELOPMENT MAP

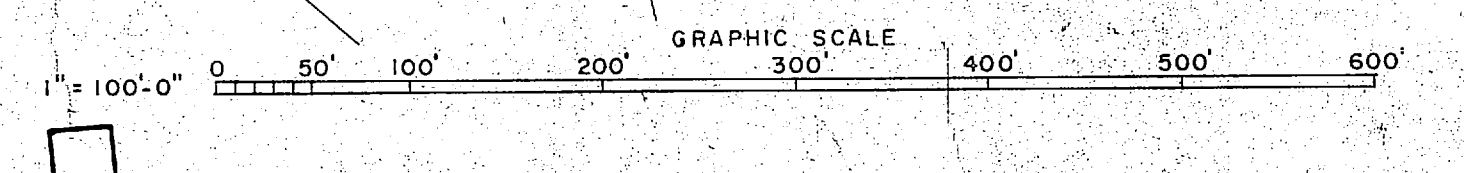

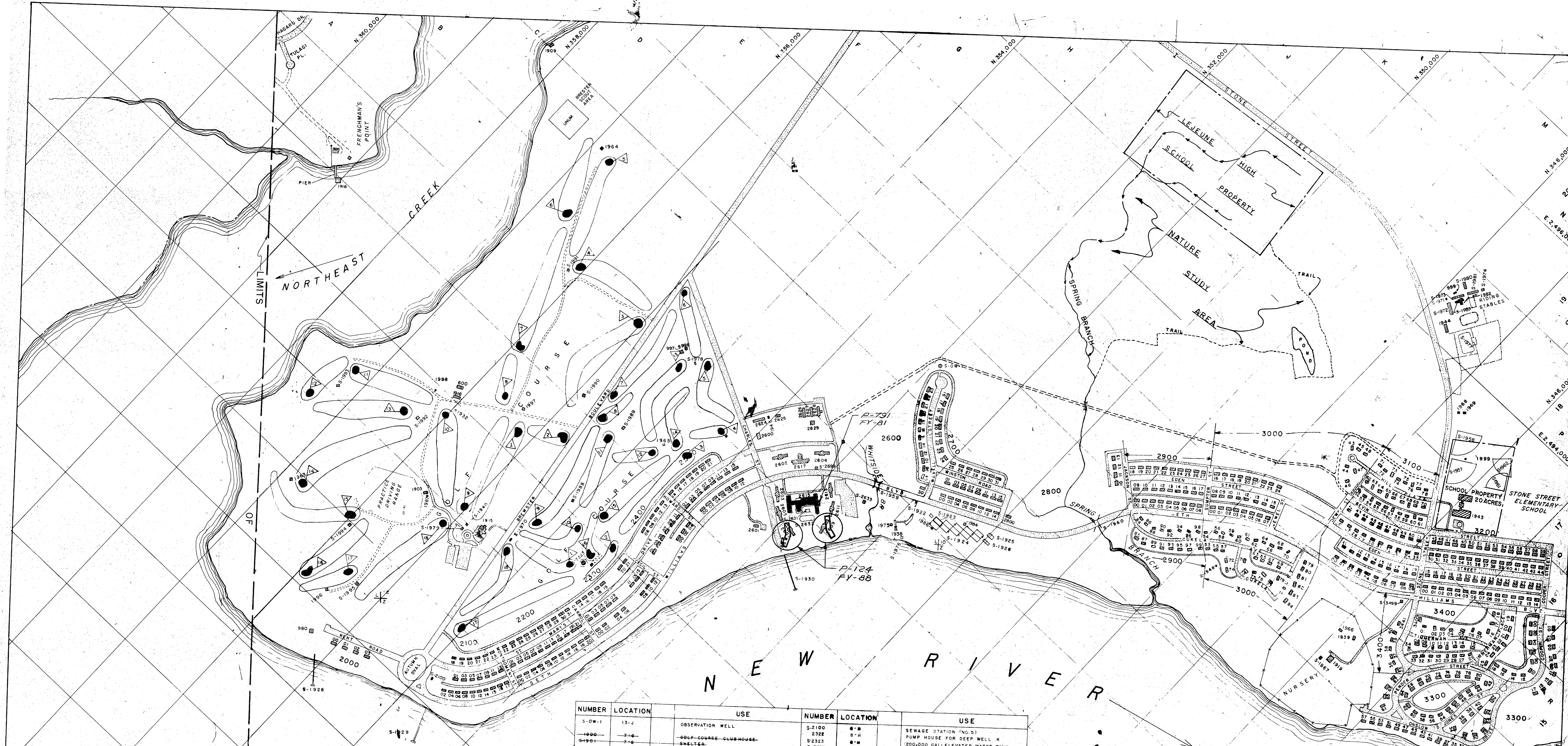

NUMBER	LOCATION	USE
S-1988	9-G	SHELTER
S-1989	10-G	
S-1990	10-D	
S-1991	11-C	
S-1992	8-E	
S-1993	8-E	
S-1994	8-E	
S-1995	8-E	
S-1996	8-E	
S-1997	8-E	
S-1998	8-E	
S-1999	17-O	
S-2000	15-P	BUS STOP SHELTER

NUMBER	LOCATION	USE	NUMBER	LOCATION	USE
S-00-1	13-J	OBSERVATION WELL	S-2100	8-M	SEWAGE STATION (NG-5)
1000	7-G	GOLF COURSE CLUBHOUSE	2322	8-M	PUMP HOUSE FOR DEEP WELL #
1001	7-G	SHELTER	2323	8-M	200,000 GAL ELEVATED WATER TANK
1002	7-G	TOILET	S-2009	11-I	BUS STOP SHELTER
1003	7-F	TOILET	2600	11-I	WIRE HOUSE) KINDERGARTEN
1004	6-E	RANGE HOUSE, GOLF COURSE	2601	10-I	GUEST HOUSE
1005	6-E	SHELTER	2602	10-I	BOY SCOUT HUT (EXISTING BUILDING)
1006	6-E	SHELTER	2603	10-I	OFFICERS' GUEST HOUSE
1007	6-E	SHELTER	2604	10-I	BACHELOR OFFICERS' QUARTERS
1008	6-E	SHELTER	2605	10-I	BACHELOR OFFICERS' QUARTERS
1009	13-C	SHELTER	2606	10-I	BACHELOR OFFICERS' QUARTERS
1010	11-E	SHELTER	2607	10-J	BACHELOR OFFICERS' QUARTERS
1011	11-E	SHELTER	2608	11-J	BACHELOR OFFICERS' QUARTERS
1012	11-E	SHELTER	2609	11-J	BACHELOR OFFICERS' QUARTERS
1013	11-E	SHELTER	2610	11-J	BACHELOR OFFICERS' QUARTERS
1014	7-G	CLUB HOUSE-GOLF	2611	11-J	BACHELOR OFFICERS' QUARTERS
1015	8-G	STORAGE COV ORG/OTH	2612	11-J	BACHELOR OFFICERS' QUARTERS
1016	9-E	SNEL MESSHALL	2613	11-J	BACHELOR OFFICERS' QUARTERS
1017	10-B	BOAT HOUSE	2614	11-J	OFFICERS' CLUB (OPEN)
1018	9-B	PW/MAINT SHOP	2615	11-I	BACHELOR OFFICERS' QUARTERS
1019	14-P	STORAGE-BUILDING	2617	11-I	DEPT SCH/ANDER
1020	16-P	MAINTENANCE BUILDING	2624	11-M	DEPT SCH/NRSY
1021	18-K	MAINTENANCE BUILDING	2625	11-I	RECREATION BUILDING
S-1922	12-K	TENNIS COURT	2626	11-I	P W MNT SHOP
S-1923	12-K	TENNIS COURT	2627	11-I	RETAIL WAREHOUSE
S-1924	12-K	TENNIS COURTS	2628	12-I	BADING POOL
S-1925	12-L	VOLLEY BALL COURT	2629	11-E	SWIMMING POOL OUTDOOR
S-1926	12-L	HANDBALL COURTS	S-2631	11-J	SEWAGE PUMPING STATION (NO. 4)
1027	17-N	BAR-SHED	S-2632	10-J	PROJECTION ROOM
S-1928	5-J	PIER	S-2633	11-J	ROCKING POWER
S-1929	5-M	PIER	S-2634	11-J	ALL QUARTERS IN BLOCKS 2000, 2100, 2200, 2300, 2400, 2500, 2600, 2700, 2800, 2900, 3000, 3100, 3200, 3300, 3400 ARE MARINE OFFICERS' QUARTERS EXCEPT AS OTHERWISE SHOWN OR NOTED.
S-1930	10-J	PIER	S-1971	18-N	FEED HOPPER
1931	14-P	STORAGE COV ORG/OTH	S-1972	18-N	RIDING STABLES (SPEC. SERV.)
1932	8-F	OFFICE	S-1973	18-N	" " (RENTAL)
1933	8-E	OFFICE	S-1974	18-N	" " (ISOLATION)
1934	8-E	SHELTER (GOLF COURSE)	GG-042	18-N	OUTH/PER-SHELTER (TRAILER)
1935	8-E	SHELTER	1975	11-K	STORAGE BLDG
1936	8-E	SHELTER	S-1976	11-K	COVERED PATIO
1937	8-E	SHELTER	S-1977	18-N	ROCKE CORRAL
1938	10-E	REC BUILDING	GG-061	18-M	STORAGE (TRAILER)
1939	14-P	STORAGE COV ORG/OTH	S-1979	11-G	CONCESSION STAND
1940	7-G	STARTER SHED (GOLF COURSE)	S-1980	7-G	PATIO
1941	10-B	STORAGE COV ORG/OTH	S-1981	18-N	STORAGE STABLE
1942	10-B	STORAGE COV ORG/OTH	1982	18-N	TOILET
1943	16-P	DEPT SCH/GRADE	S-1983	18-N	MITCHING SHELTER
1944	18-M	STORAGE COV ORG/OTH	1984	18-N	TOILET
1945	18-M	PER SUP FAC OTH	1985	11-K	STORAGE
1946	17-M	SOFTBALL FIELD	1986	11-K	RECREATION BLDG.
S-1944	14-K	SOFTBALL FIELD	1987	11-K	TOILET
S-1945	17-G	BASEBALL FIELD	1988	18-N	POW STABLE
S-1946	17-G	BASEBALL FIELD	1989	18-N	GOLF SHELTER
S-1947	17-G	BASEBALL FIELD	S-1990	11-G	GOLF EQUIP BLDG.
S-1948	17-G	BASEBALL FIELD	1991	11-G	PUBLIC TOILET
S-1949	17-G	BASEBALL FIELD			
S-1950	17-G	BASEBALL FIELD			
S-1951	17-G	BASEBALL FIELD			
S-1952	17-G	BASEBALL FIELD			
S-1953	17-G	BASEBALL FIELD			
S-1954	17-G	BASEBALL FIELD			
S-1955	17-G	BASEBALL FIELD			
S-1956	17-G	BASEBALL FIELD			
S-1957	17-G	BASEBALL FIELD			
S-1958	17-G	BASEBALL FIELD			
S-1959	17-G	BASEBALL FIELD			
S-1960	17-G	BASEBALL FIELD			
S-1961	17-G	BASEBALL FIELD			
S-1962	17-G	BASEBALL FIELD			
S-1963	17-G	BASEBALL FIELD			
S-1964	17-G	BASEBALL FIELD			
S-1965	17-G	BASEBALL FIELD			
S-1966	17-G	BASEBALL FIELD			
S-1967	17-G	BASEBALL FIELD			
S-1968	17-G	BASEBALL FIELD			
S-1969	17-G	BASEBALL FIELD			
S-1970	17-G	BASEBALL FIELD			
S-1971	17-G	BASEBALL FIELD			
S-1972	17-G	BASEBALL FIELD			
S-1973	17-G	BASEBALL FIELD			
S-1974	17-G	BASEBALL FIELD			
S-1975	17-G	BASEBALL FIELD			
S-1976	17-G	BASEBALL FIELD			
S-1977	17-G	BASEBALL FIELD			
S-1978	17-G	BASEBALL FIELD			
S-1979	17-G	BASEBALL FIELD			
S-1980	17-G	BASEBALL FIELD			
S-1981	17-G	BASEBALL FIELD			
S-1982	17-G	BASEBALL FIELD			
S-1983	17-G	BASEBALL FIELD			
S-1984	17-G	BASEBALL FIELD			
S-1985	17-G	BASEBALL FIELD			
S-1986	17-G	BASEBALL FIELD			
S-1987	17-G	BASEBALL FIELD			
S-1988	17-G	BASEBALL FIELD			
S-1989	17-G	BASEBALL FIELD			
S-1990	17-G	BASEBALL FIELD			
S-1991	17-G	BASEBALL FIELD			
S-1992	17-G	BASEBALL FIELD			
S-1993	17-G	BASEBALL FIELD			
S-1994	17-G	BASEBALL FIELD			
S-1995	17-G	BASEBALL FIELD			
S-1996	17-G	BASEBALL FIELD			
S-1997	17-G	BASEBALL FIELD			
S-1998	17-G	BASEBALL FIELD			
S-1999	17-G	BASEBALL FIELD			
S-2000	17-G	BASEBALL FIELD			

LEGEND

- BUILDINGS
- ASPHALT SURFACED
- SHELL ROCK SURFACED
- FENCE
- HELICOPTER/LANDING ZONE

MCON PROJECTS

- BLACK ■ FY-79-80-81 COMPLETED
- BLUE ■ FY-81-82-83 AUTHORIZED
- GREEN ■ UNDER CONSTRUCTION
- RED ■ FY-84 PROPOSED
- FY-85
- FY-86
- FY-87
- FY-88

PUBLIC WORKS DEPT MARINE CORPS BASE CAMP LEJEUNE, N.C.		DEPARTMENT OF THE NAVY NAVAL FACILITIES ENGINEERING COMMAND ATLANTIC DIVISION MARINE CORPS BASE, CAMP LEJEUNE, N.C.	
DESIGNED BY: CHK EGV		DRAWING NO: 4399	
APPROVED BY: [Signature]		DATE: 1/23/84	
PUBLIC WORKS OFFICER FOR THE CAMP		CONSTR. CONTR. NO:	
DATE: 1/23/84		SHEET 7 OF 17	
SCALE: 1" = 200'		SPEC: 17	

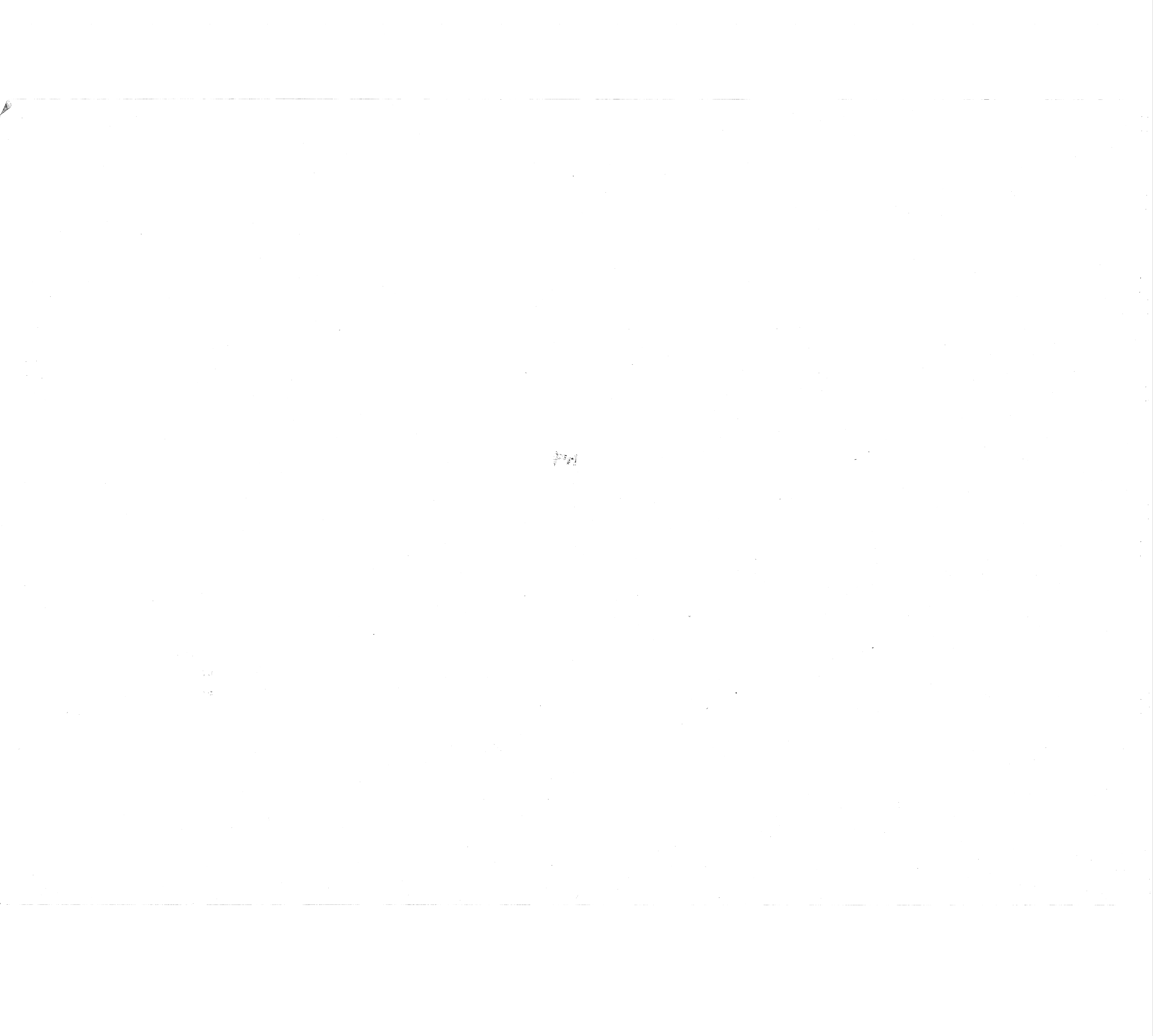

REVISIONS			
SYM	DESCRIPTION	DATE	APPROVED

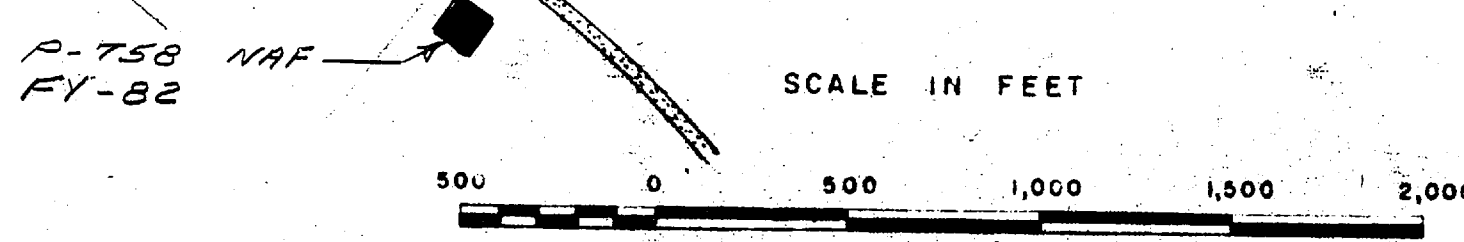
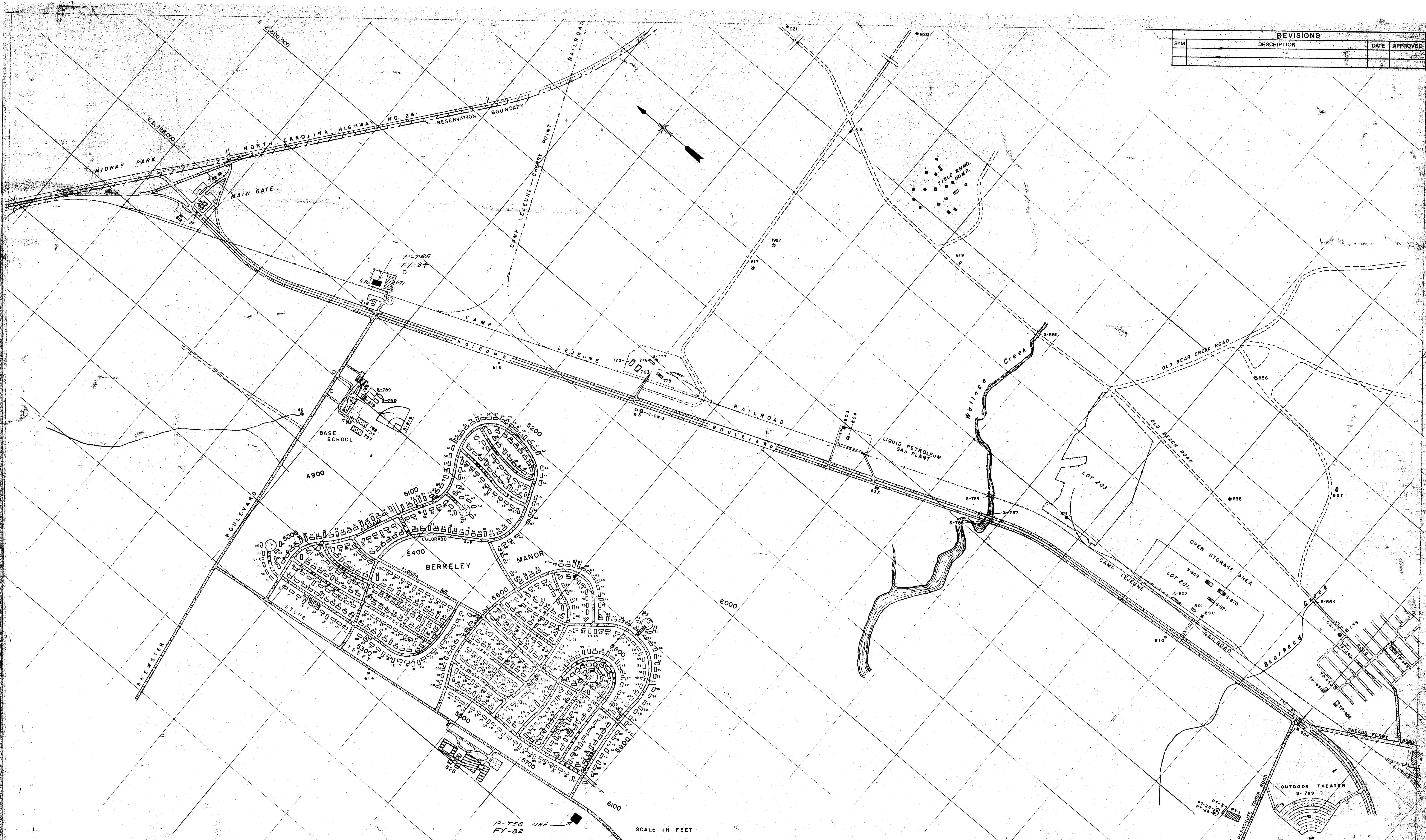

MCON PROJECTS

- BLACK ■ FY-79-80-81 COMPLETED
- BLUE ■ FY-81-82-83 AUTHORIZED
- GREEN ■ UNDER CONSTRUCTION
- RED ■ FY-84 PROPOSED
- FY-85 //
- FY-86 //
- FY-87 //
- FY-88 //

PUBLIC WORKS DEPT. MARINE CORPS BASE CAMP LEJUNE, N.C.		DEPARTMENT OF THE NAVY NAVAL FACILITIES ENGINEERING COMMAND ATLANTIC DIVISION NORFOLK, VIRGINIA	
DES	OR	CHK	ESJ
PROJ	MR	EGV	CH ENGR/CS/SMAN
APPROV	DATE	DATE	DATE
PUBLIC WORKS OFFICER FOR THE EG		DATE	
RESPONSIBLE TO		DATE	
COMMAN/ING GENERAL		DATE	
SIZE	CODE	IDENT NO.	FW DRAWING NO.
F	80091		14400
CONSTR CONTR NO.		SHEET 07 OF 17	
SCALE GRAPHIC		SPEC	
END FOR COMMANDER, NAVFAC		LANDING DRG NO.	

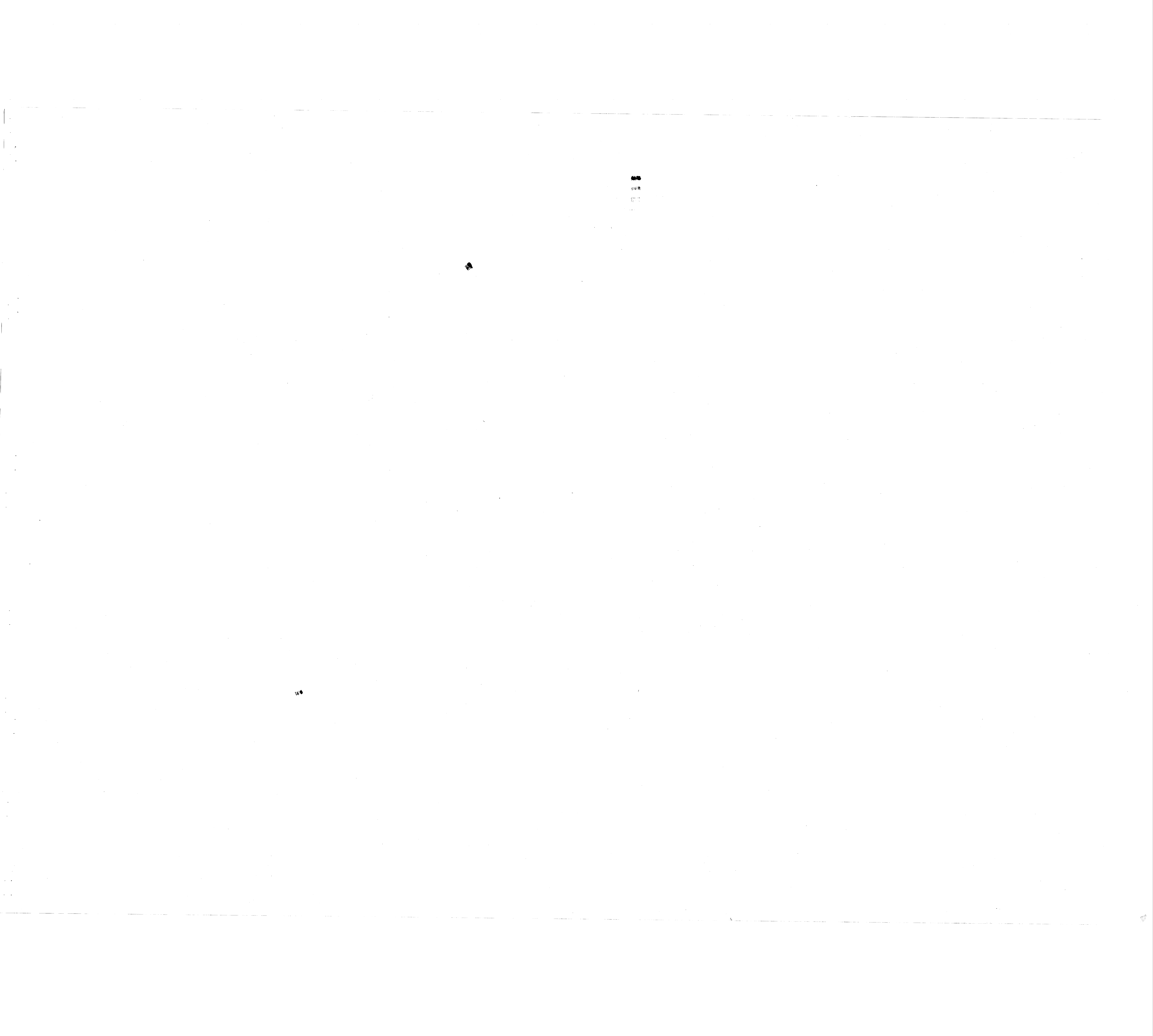

NUMBER	LOCAT.	USE	NUMBER	LOCAT.	USE
H-1	2-D	HOSPITAL	H-41	2-C	GARAGE
H-2	2-D	WARDS AND CLINIC	H-42	2-C	GARAGE
H-3	3-D	WARDS	H-43	2-D	WARDS
H-4	3-D	ADMINISTRATION BLDG	H-44	2-D	WARDS
H-5	3-D	WARDS	H-45	3-D	WARDS
H-6	3-D	WARDS	H-46	3-D	WARDS
H-7	3-D	WARDS	H-47	3-D	PERSONNEL AND RECORDS BLDG
H-8	2-D	WARDS-RED CROSS	H-48	4-C	ANIMAL HOUSE
H-9	3-D	WARDS	H-49	4-C	MEDICAL OFFICERS' QUARTERS
H-10	3-C	MESS HALL AND RECREATION BLDG	H-50	5-C	MEDICAL OFFICERS' QUARTERS
H-11	3-D	WARDS	H-51	5-C	MEDICAL OFFICERS' QUARTERS
H-12	3-D	WARDS	H-52	5-C	MEDICAL OFFICERS' QUARTERS
H-13	3-C	WARDS	H-53	5-C	MEDICAL OFFICERS' QUARTERS
H-14	4-D	BACHELOR OFFICERS QUARTERS	H-54	5-C	MEDICAL OFFICERS' QUARTERS
H-15	4-C	FAMILY HOSPITAL	H-55	5-C	MEDICAL OFFICERS' QUARTERS
H-16	4-C	WAVE ENLISTED HOSE CORPS BKS.	H-56	5-C	MEDICAL OFFICERS' QUARTERS
H-17	3-C	MEDICAL WAREHOUSE	H-57	5-C	MEDICAL OFFICERS' QUARTERS
H-18	3-C	GARAGE	H-58	5-C	MEDICAL OFFICERS' QUARTERS
H-19	3-C	SHOPS	H-59	5-C	MEDICAL OFFICERS' QUARTERS
H-20	4-C	POWER PLANT	H-60	5-C	MEDICAL OFFICERS' QUARTERS
H-21	4-C	LAUNDRY	H-61	5-C	MEDICAL OFFICERS' QUARTERS
H-22	4-C	WAREHOUSE	H-62	5-C	MEDICAL OFFICERS' QUARTERS
H-23	3-C	CORPSMENS' BARRACKS	H-63	5-C	MEDICAL OFFICERS' QUARTERS
H-24	3-C	CORPSMENS' BARRACKS	H-65	5-C	MEDICAL OFFICERS' QUARTERS
H-25	2-C	MEDICAL OFFICERS' QUARTERS	H-66	5-C	MEDICAL OFFICERS' QUARTERS
H-26	2-C	MEDICAL OFFICERS' QUARTERS	H-67	5-C	MEDICAL OFFICERS' QUARTERS
H-27	2-C	MEDICAL OFFICERS' QUARTERS	H-68	4-D	MEDICAL OFFICERS' QUARTERS
H-28	4-C	MEDICAL OFFICERS' QUARTERS	H-69	4-C	MEDICAL OFFICERS' QUARTERS
H-29	4-D	SEWAGE PUMPING STATION NO.2	H-70	5-C	TRANSFORMER HOUSE
H-30	5-C	NON-HOUSEKEEPING QUARTERS	S-H-72	4-D	BASKETBALL COURTS
H-31	5-C	NON-HOUSEKEEPING QUARTERS	S-H-73	4-C	TENNIS COURTS
H-32	5-D	BACHELOR OFFICERS QUARTERS	S-H-74	4-C	TENNIS COURTS
H-33	4-C	TRANSFORMER HOUSE "B"	S-H-75	3-C	TENNIS COURTS
H-34	4-C	TRANSFORMER HOUSE "E"	H-76	4-C	PAINT & INFLAMMABLE STORAGE BLDG.
H-35	2-C	TRANSFORMER HOUSE "D"	H-77	4-C	GENERATOR HOUSE
H-36	3-C	GARAGE	H-78	4-C	PATHOLOGICAL WASTE INCINER. BLDG.
H-37	3-C	WELL-E-1	H-79	3-C	BULK OXYGEN STORAGE BLDG.
H-38	5-C	TRANSFORMER HOUSE	S-H-80	3-D	FLAGPOLE
H-39	5-C	NIGHT CORPSMENS' BARRACKS	S-H-81	4-D	PLAYING COURT
H-40	5-C	MEDICAL WAREHOUSE	H-82	3-D	PICNIC COOKOUT FACILITY
			H-83	3-D	STORAGE SHED
			H-84	3-C	GARDENERS STORAGE BUILDING
			S-H-85	3-D	HELICOPTER LANDING PAD (CONC.)

NUMBER	LOCAT.	USE
H-86	4-C	STORAGE
H-87	4-C	"
H-88	5-C	"
H-89	5-C	"
H-90	5-C	"
H-91	5-C	"
H-92	5-C	"
H-93	5-C	"
H-94	5-C	"
H-95	5-C	"
H-96	5-C	"
H-97	5-C	"
H-98	5-C	"
H-99	5-C	"
H-100	5-C	"
H-101	5-C	"
H-102	5-C	"
H-103	5-C	"
H-104	5-C	"
S-H-105	3-C	PLATFORM, OXYGEN FACILITY
H-106	3-D	HELICOPTER LANDING PAD LZ-2
H-107	5-D	ELECT. SWITCHING STA.
H-108	4-C	SUB-STATION
H-109	4-C	TRANSFORMER PAD
H-110	4-C	VEHICLE WASH RACK
H-111	3-C	BAR-B-CUE PIT
H-112	3-C	GREASE RACK
H-113	3-C	READY VEH STORAGE TANK
H-114	3-C	FILLING STATION
H-115	3-C	DUST COLLECTOR SYSTEM
H-116	3-D	TRANSFORMER PAD
H-117	1-D	PICNIC SHELTER
H-118	3-C	HEATING OIL TANK
H-119	3-C	"
H-120	3-C	GENERATOR OIL TANK
H-121	3-C	HEATING OIL TANK
H-122	1-D	WOMENS TOILET
H-123	1-D	MENS
H-124	5-C	HEATING OIL TANK
H-125	5-C	"
H-126	5-C	SIGN
H-127	1-D	TOILET FACILITIES



LEGEND

- BUILDINGS
- ASPHALT SURFACED
- SHORE LINE
- HELICOPTER LANDING ZONE
- STONE SURFACE ROAD
- EARTH ROAD
- MARINE CORPS BASE PROPERTY

REVISED PROPERTY DELINEATION

NAVAL HOSPITAL	127.1 ACRES
MARINE CORPS BASE	17.5 "
TOTAL HOSPITAL AREA	144.6 "

MCON PROJECTS

BLACK	■	FY-79-80-81	COMPLETED
BLUE	■	FY-81-82-83	AUTHORIZED
GREEN	■		UNDER CONSTRUCTION
RED	■	FY-84	PROPOSED
	□	FY-85	//
	□	FY-86	//
	□	FY-87	//
	□	FY-88	//

PUBLIC WORKS DEPT. MARINE CORPS BASE CAMP LEJEUNE, N.C.		DEPARTMENT OF THE NAVY NAVAL FACILITIES ENGINEERING COMMAND NORFOLK, VIRGINIA	
DES: DR: CHK: EGN		NAVAL STATION: MARINE CORPS BASE, CAMP LEJEUNE, N.C.	
APPROVED: EGN CH ENG CAZES/MAJ		DATE: 4/29/81	
PUBLIC WORKS OFFICER FOR THE CG		DATE: 4/29/81	
COMMITTING GENERAL		SIZE: F	CODE IDENT NO: 80091
APPROVED: DIR: DATE:		SCALE: 1"=200'	SPEC: CONSTR CONTR NO:
FOR COMMANDER, NAVFAC		SCALE: 1"=200'	SPEC: SHEET 9 OF 17

1000
1000
1000
1000

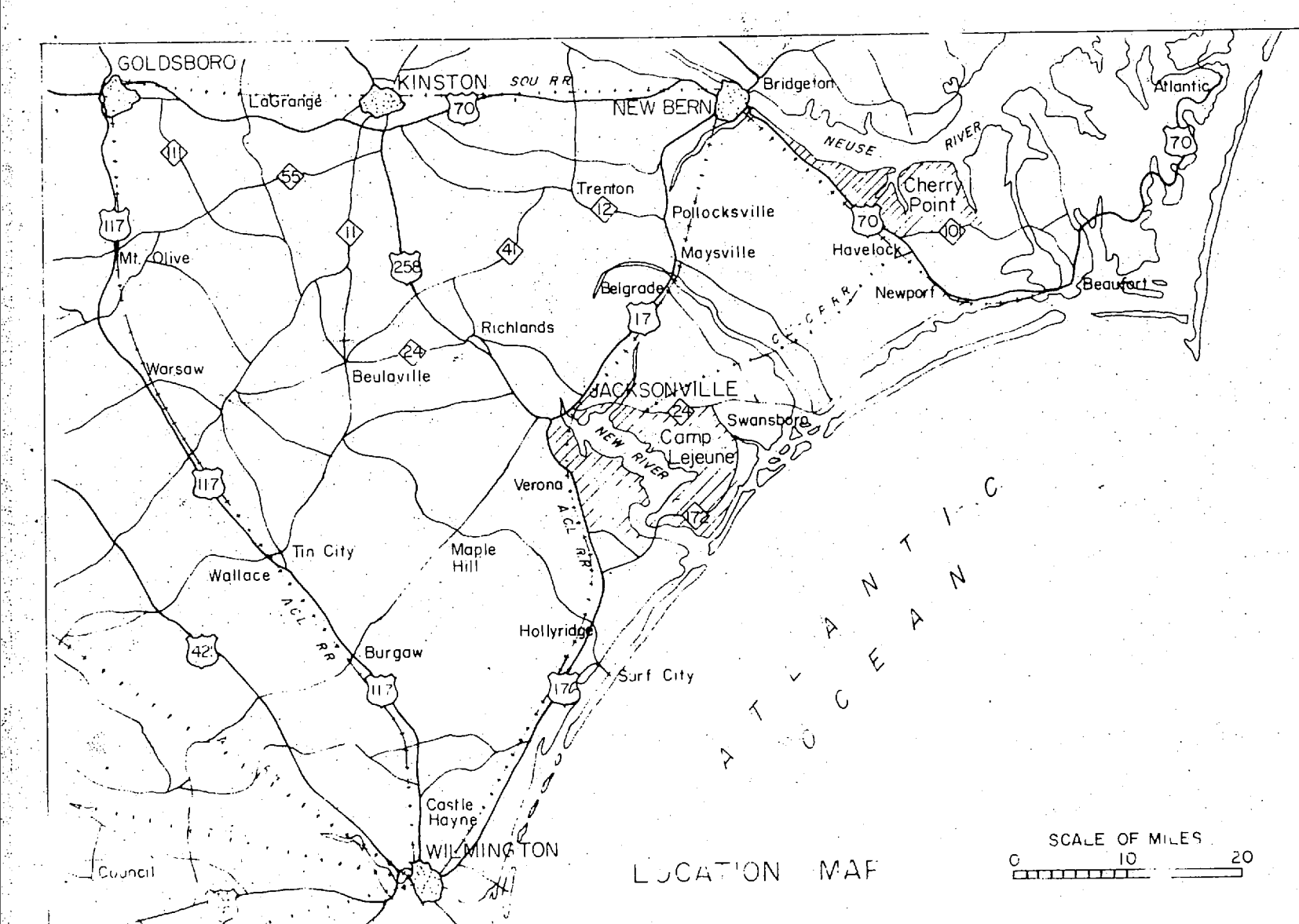

MCON PROJECTS

- BLACK ■ FY-79-80-81 COMPLETED
- BLUE ■ FY-81-82-83 AUTHORIZED
- GREEN ■ UNDER CONSTRUCTION
- RED ■ FY-84 PROPOSED
- FY-85 //
- FY-86 //
- FY-87 //
- FY-88 //

PUBLIC WORKS DEPT. MARINE CORPS BASE CAMP LEJEUNE, N.C.		DEPARTMENT OF THE NAVY NAVAL FACILITIES ENGINEERING COMMAND ATLANTIC DIVISION NORFOLK, VIRGINIA	
DESIGNED BY: <i>EGY</i>		NAVAL STATION: MARINE CORPS BASE, CAMP LEJEUNE, N.C.	
APPROVED BY: <i>EGY</i>		PROJECT: TARAWA TERRACE HSG AREA	
DATE: <i>10/81</i>		GENERAL DEVELOPMENT MAP	
PUBLIC WORKS OFFICER FOR THE CG		SIZE: F	
SATISFACTORY TO: _____		CODE IDENT NO: 80091	
COMMANDING GENERAL: _____		PW DRAWING NO: 14403	
EFD: _____		CONSTR CONTR NO: _____	
NO: _____		SCALE: GRAPHIC SPEC	
APPROVED: _____		SHEET: 11 OF 17	
DATE: _____		FOR COMMANDER, NAVFAC:	

1994
1994
1994
1994

1994

1994

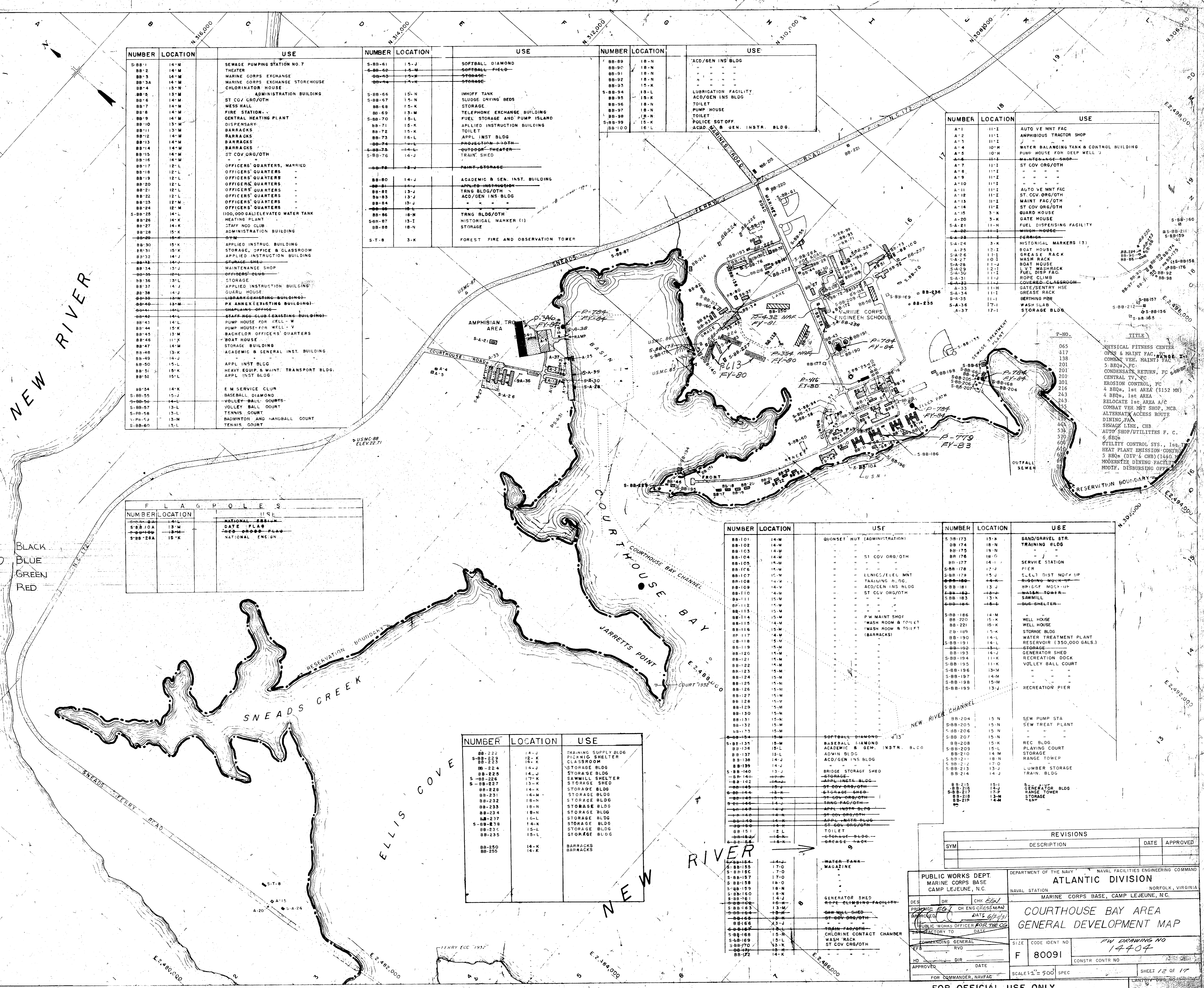

NUMBER	LOCATION	USE	NUMBER	LOCATION	USE	NUMBER	LOCATION	USE
S-BB-1	14-M	SEWAGE PUMP STATION NO. 7	S-BB-61	15-J	SOFTBALL DIAMOND	BB-89	18-N	ACD/GEN IN'S BLDG
BB-2	14-M	THEATER	S-BB-62	15-M	SOFTBALL FIELD	BB-90	18-N	"
BB-3	14-M	MARINE CORPS EXCHANGE	BB-63	15-M	STORAGE	BB-91	18-N	"
BB-3A	14-M	MARINE CORPS EXCHANGE STOREHOUSE	BB-64	15-M	STORAGE	BB-92	18-N	"
BB-4	15-N	CHLORINATOR HOUSE	BB-65	15-N	IMHOFF TANK	BB-93	15-K	"
BB-5	13-M	ADMINISTRATION BUILDING	S-BB-66	15-N	SLUDGE DRYING BEDS	S-BB-94	18-L	LUBRICATION FACILITY
BB-6	14-M	ST COV ORG/OTH	BB-67	15-N	STORAGE	BB-95	18-K	ACD/GEN IN'S BLDG
BB-7	14-M	MESS HALL	BB-68	15-N	STORAGE	BB-96	18-N	TOILET
BB-8	14-M	FIRE STATION	BB-69	13-M	TELEPHONE EXCHANGE BUILDING	BB-97	18-N	TOILET
BB-9	14-M	CENTRAL HEATING PLANT	S-BB-70	15-L	FUEL STORAGE AND PUMP ISLAND	BB-98	18-N	PUMP HOUSE
BB-10	13-M	BARRACKS	BB-71	15-K	APPLIED INSTRUCTION BUILDING	S-BB-99	15-K	TOILET
BB-11	13-M	BARRACKS	BB-72	15-K	TOILET	BB-100	16-L	ACD/GEN INSTR. BLDG.
BB-12	14-M	BARRACKS	BB-73	16-L	APPL. INST. BLDG.			
BB-13	14-M	BARRACKS	BB-74	16-L	PROJECTION ROOM			
BB-14	14-M	BARRACKS	BB-75	14-L	OUTDOOR THEATER			
BB-15	14-M	ST COV ORG/OTH	S-BB-76	14-J	TRAIN SHED			
BB-16	14-M	"	S-BB-77	12-J	PAINT STORAGE			
BB-17	12-L	OFFICERS' QUARTERS, MARRIED	BB-80	14-J	ACADEMIC B GEN. INST. BUILDING			
BB-18	12-L	OFFICERS' QUARTERS	BB-81	14-J	TRNG BLDG/OTH			
BB-19	12-L	OFFICERS' QUARTERS	BB-82	13-J	ACD/GEN IN'S BLDG			
BB-20	12-L	OFFICERS' QUARTERS	BB-83	13-L	"			
BB-21	12-L	OFFICERS' QUARTERS	BB-84	13-J	"			
BB-22	12-L	OFFICERS' QUARTERS	BB-85	13-L	"			
BB-23	12-M	OFFICERS' QUARTERS	BB-86	18-N	TRNG BLDG/OTH			
BB-24	12-M	OFFICERS' QUARTERS	S-BB-87	18-N	HISTORICAL WALKER (1)			
S-BB-25	14-L	100,000 GALLON ELEVATED WATER TANK	BB-88	18-N	STORAGE			
BB-26	14-K	HEATING PLANT	S-T-8	3-K	FOREST FIRE AND OBSERVATION TOWER			
BB-27	14-K	STAFF NOD CLUB						
BB-28	15-K	ADMINISTRATION BUILDING						
BB-29	15-K	GYM						
BB-30	15-K	APPLIED INSTRU. BUILDING						
BB-31	15-K	STORAGE, OFFICE & CLASSROOM						
BB-32	14-J	APPLIED INSTRUCTION BUILDING						
BB-33	14-J	MAINTENANCE SHOP						
BB-34	14-J	OFFICERS' QUARTERS						
BB-35	14-M	STORAGE						
BB-36	13-L	APPLIED INSTRUCTION BUILDING						
BB-37	14-J	OUTSIDE RANGE						
BB-38	14-J	LIBRARY (EXISTING BUILDING)						
BB-39	13-M	PK ANNEX (EXISTING BUILDING)						
BB-40	13-M	CHANGING ROOMS						
BB-41	14-L	STAFF NOD CLUB (EXISTING BUILDING)						
BB-42	14-L	PUMP HOUSE FOR WELL - W						
BB-43	14-L	PUMP HOUSE FOR WELL - V						
BB-44	15-K	BACHELOR OFFICERS' QUARTERS						
BB-45	13-M	BOAT HOUSE						
BB-46	11-K	STORAGE BUILDING						
BB-47	14-M	ACADEMIC & GENERAL INST. BUILDING						
BB-48	13-K	STORAGE BUILDING						
BB-49	14-J	APPL. INST. BLDG.						
BB-50	15-L	HEAVY EQUIP. & MAINT. TRANSPORT BLDG.						
BB-51	15-K	APPL. INST. BLDG.						
BB-52	15-L	APPL. INST. BLDG.						
BB-53	14-K	E.M. SERVICE CLUP						
S-BB-54	15-J	BASEBALL DIAMOND						
S-BB-55	14-L	VOLLEY BALL COURTS						
S-BB-56	13-L	VOLLEY BALL COURT						
S-BB-57	13-L	TENNIS COURT						
S-BB-58	13-M	BADMINTON AND HANDBALL COURT						
S-BB-59	13-M	TENNIS COURT						
S-BB-60	13-L	TENNIS COURT						

NUMBER	LOCATION	USE
A-1	11-I	AUTO VEH MNT FAC
A-2	11-I	AMPHIBIOUS TRACTOR SHOP
A-3	11-I	"
A-4	10-M	WATER BALANCING TANK & CONTROL BUILDING
A-5	10-H	PUMP HOUSE FOR DEEP WELL 2
A-6	11-I	ST COV ORG/OTH
A-7	11-I	"
A-8	11-I	"
A-9	11-I	"
A-10	11-I	AUTO VEH MNT FAC
A-11	11-I	ST COV ORG/OTH
A-12	11-I	MAINT FAC/OTH
A-13	11-I	ST COV ORG/OTH
A-14	11-I	GUARD HOUSE
A-15	3-K	FUEL DISPENSING FACILITY
S-A-21	11-N	MINI-HOUSE
S-A-22	11-I	BERNARD
S-A-23	3-K	HISTORICAL MARKERS (3)
S-A-24	10-I	BOAT HOUSE
S-A-25	10-I	GREASE RACK
S-A-26	10-I	WASH RACK
S-A-27	11-J	L.V.T. WASH RACK
S-A-28	11-J	ROPE CLIMB
S-A-29	11-J	ROPE CLIMB
S-A-30	11-J	ROPE CLIMB
S-A-31	11-J	ROPE CLIMB
S-A-32	11-I	GATE/ENTRY USE
S-A-33	11-I	UTILITY CONTROL SYS.
S-A-34	11-I	UTILITY CONTROL SYS.
S-A-35	17-I	WASH SLAB
S-A-36	17-I	STORAGE BLDG.

FLAG POLES		
NUMBER	LOCATION	USE
S-BB-104	13-M	NATIONAL FLAG
S-BB-105	13-M	DATE FLAG
S-BB-106	13-M	NATIONAL FLAG
S-BB-107	13-M	NATIONAL FLAG

NUMBER	LOCATION	USE	NUMBER	LOCATION	USE
BB-101	14-M	QUONSET HUT (ADMINISTRATION)	S-BB-173	13-K	SAND/GRAVEL STR.
BB-102	14-M	"	BB-174	18-N	TRAINING BLDG.
BB-103	14-M	"	BB-175	19-N	"
BB-104	14-M	"	BB-176	18-O	"
BB-105	14-M	ST COV ORG/OTH	BB-177	14-I	SERVICE STATION
BB-106	14-M	"	S-BB-178	12-J	PIER
BB-107	15-M	ELNHC/TELE. MNT	S-BB-179	15-J	ELECT. DIST. MCK. HP
BB-108	14-M	TRAINING BLDG.	S-BB-180	14-K	BRIDGE MCK. HP
BB-109	14-M	ACD/GEN IN'S BLDG	S-BB-181	13-J	WASH. TOWER
BB-110	14-M	ST COV ORG/OTH	S-BB-182	13-K	SUMMIT
BB-111	14-M	"	S-BB-183	14-K	SHUTTER
BB-112	15-M	"	S-BB-184	14-L	SHUTTER
BB-113	15-M	"	S-BB-186	14-M	WELL HOUSE
BB-114	15-M	"	BB-220	15-K	WELL HOUSE
BB-115	15-M	"	S-BB-221	15-K	STORAGE BLDG.
BB-116	15-M	"	BB-185	15-K	WATER TREATMENT PLANT
BB-117	15-M	"	BB-191	16-L	RESERVOIR (150,000 GALS.)
BB-118	15-M	"	BB-192	15-L	STORAGE
BB-119	15-M	"	S-BB-193	11-K	RECREATION DOCK
BB-120	15-M	"	S-BB-194	11-K	VOLLEY BALL COURT
BB-121	15-M	"	S-BB-195	11-K	"
BB-122	15-M	"	S-BB-196	14-M	"
BB-123	15-M	"	S-BB-197	14-M	"
BB-124	15-M	"	S-BB-198	15-M	"
BB-125	15-M	"	S-BB-199	13-J	RECREATION PIER
BB-126	15-M	"			
BB-127	15-M	"			
BB-128	15-M	"			
BB-129	15-M	"			
BB-130	15-M	"			
BB-131	15-K	"			
BB-132	15-M	"			
BB-133	15-M	"			
BB-134	15-M	"			
BB-135	15-M	SOFTBALL DIAMOND	BB-204	15-N	SEW PUMP STA.
BB-136	15-L	BASEBALL DIAMOND	S-BB-205	15-N	SEW TREAT PLANT
BB-137	15-L	ACADEMIC & GEN. INSTR. BLDG	S-BB-206	15-N	"
BB-138	14-J	ADMIN BLDG	S-BB-207	15-N	"
BB-139	14-J	ACD/GEN IN'S BLDG	BB-208	15-K	REC. BLDG.
BB-140	13-J	BRIDGE STORAGE SHED	S-BB-209	15-L	PLAYING COURT
BB-141	13-K	STORAGE	BB-210	14-M	STORAGE
BB-142	13-K	STORAGE	S-BB-211	18-N	RANGE TOWER
BB-143	13-K	STORAGE	S-BB-212	17-O	"
BB-144	13-K	STORAGE	S-BB-213	13-J	LUMBER STORAGE
BB-145	13-K	STORAGE	BB-214	14-J	TRAIN. BLDG.
BB-146	13-K	STORAGE			
BB-147	13-K	STORAGE			
BB-148	13-K	STORAGE			
BB-149	13-K	STORAGE			
BB-150	13-K	STORAGE			
BB-151	12-L	TOILET			
BB-152	12-L	TOILET			
BB-153	12-L	TOILET			
BB-154	12-L	TOILET			
BB-155	12-L	TOILET			
BB-156	12-L	TOILET			
BB-157	12-L	TOILET			
BB-158	12-L	TOILET			
BB-159	12-L	TOILET			
BB-160	12-L	TOILET			
BB-161	12-L	TOILET			
BB-162	12-L	TOILET			
BB-163	12-L	TOILET			
BB-164	12-L	TOILET			
BB-165	12-L	TOILET			
BB-166	12-L	TOILET			
BB-167	12-L	TOILET			
BB-168	12-L	TOILET			
BB-169	12-L	TOILET			
BB-170	12-L	TOILET			
BB-171	12-L	TOILET			
BB-172	12-L	TOILET			

REVISIONS

SYM	DESCRIPTION	DATE	APPROVED

PUBLIC WORKS DEPT.
MARINE CORPS BASE
CAMP LEJEUNE, N.C.

DEPARTMENT OF THE NAVY
NAVAL FACILITIES ENGINEERING COMMAND
NORFOLK, VIRGINIA

COURTHOUSE BAY AREA
GENERAL DEVELOPMENT MAP

DESIGNED BY: *EG*
DRAWN BY: *EG*
CHECKED BY: *EG*
DATE: *10/1/51*

SCALE: 1" = 500' SPEC

SHEET 12 OF 17

FOR OFFICIAL USE ONLY. CAMP LEJEUNE, N.C.

MOON PROJECTS

- FY-79-80-81 - COMPLETED BLACK
- FY-81-82-83 - AUTHORIZED BLUE
- UNDER CONSTRUCTION GREEN
- FY-84 - PROPOSED RED
- FY-85 " "
- FY-86 " "
- FY-87 " "
- FY-88 " "



NUMBER	LOC	USE
BA-160	14-N	SEW PUMP STA
BA-161	14-N	SEW TREAT PLANT
BA-162	13-M	PUBLIC TOILET
BA-163	13-M	WELL HOUSE
BA-164	13-L	DRY WASHING
BA-165	17-L	RECREATION LODGING
BA-166	17-L	RECREATION LODGING
BA-167	17-L	RECREATION LODGING
BA-168	17-L	RECREATION LODGING
BA-169	17-L	RECREATION LODGING
BA-170	17-L	RECREATION LODGING
BA-171	13-O	RECREATION LODGING
BA-172	13-O	RECREATION LODGING
BA-173	13-O	RECREATION LODGING
BA-174	13-O	RECREATION LODGING
BA-175	13-O	RECREATION LODGING
BA-176	13-O	RECREATION LODGING
BA-177	13-O	RECREATION LODGING
BA-178	13-O	RECREATION LODGING
BA-179	13-O	RECREATION LODGING
THRU	16-M	
BA-189	17-L	SEWAGE LIFT STA
BA-190	17-L	SEWAGE LIFT STA
BA-191	17-L	SEWAGE LIFT STA
BA-192	17-L	SEWAGE LIFT STA
BA-193	17-L	SEWAGE LIFT STA
BA-194	17-L	SEWAGE LIFT STA
BA-195	17-L	SEWAGE LIFT STA
BA-196	17-L	SEWAGE LIFT STA
BA-197	17-L	SEWAGE LIFT STA
BA-198	17-L	SEWAGE LIFT STA
BA-199	17-L	SEWAGE LIFT STA
BA-200	17-L	SEWAGE LIFT STA

NUMBER	LOCATION	USE
BA-101	14-N	SCHOOL BUILDING
BA-102	14-N	E. M. SERVICE CLUB
BA-103	14-N	BARRACKS
BA-104	14-N	MESS HALL
BA-105	14-N	BARRACKS
BA-106	14-N	BARRACKS
BA-107	14-N	HEATING PLANT
BA-108	14-N	COORDINATOR HOUSE
BA-109	14-N	10,000 GAL ELEVATED WATER TANK
BA-110	14-N	PUMP HOUSE FOR CIST. WEL. 22
BA-111	14-N	PUMP HOUSE FOR CIST. WEL. 23
BA-112	14-N	PUMP HOUSE FOR CIST. WEL. 24
BA-113	14-N	STAFF NCO CLUB
BA-114	14-N	REC BLDG
BA-115	14-N	REC BLDG
BA-116	14-N	SEWAGE PUMPING STATION
BA-117	14-N	SEWAGE PUMPING STATION
BA-118	14-N	OFFICERS SEARCH HOUSE
BA-119	14-N	REC BLDG
BA-120	14-N	REC BLDG
BA-121	14-N	REC BLDG
BA-122	14-N	CIVILIAN BEACH HOUSE (EXISTING BUILDING)
BA-123	14-N	CIVILIAN BEACH HOUSE (EXISTING BUILDING)
BA-124	14-N	RESTROOM - BATHS AND WASHING HOUSE
BA-125	14-N	RESTROOM
BA-126	14-N	OBSERVATION TOWER
BA-127	14-N	IMHOFF TANK
BA-128	14-N	FLUORESCENT LIGHT
BA-129	14-N	ST COV ORG/OTH
BA-130	14-N	VEHICULAR BRIDGE
BA-131	14-N	MAINT SHOP
BA-132	14-N	VEHICULAR BRIDGE
BA-133	14-N	VEHICULAR BRIDGE
BA-134	14-N	VEHICULAR BRIDGE
BA-135	14-N	VEHICULAR BRIDGE
BA-136	14-N	VEHICULAR BRIDGE
BA-137	14-N	VEHICULAR BRIDGE
BA-138	14-N	VEHICULAR BRIDGE
BA-139	14-N	VEHICULAR BRIDGE
BA-140	14-N	VEHICULAR BRIDGE
BA-141	14-N	VEHICULAR BRIDGE
BA-142	14-N	VEHICULAR BRIDGE
BA-143	14-N	VEHICULAR BRIDGE
BA-144	14-N	VEHICULAR BRIDGE
BA-145	14-N	VEHICULAR BRIDGE
BA-146	14-N	VEHICULAR BRIDGE
BA-147	14-N	VEHICULAR BRIDGE
BA-148	14-N	VEHICULAR BRIDGE
BA-149	14-N	VEHICULAR BRIDGE
BA-150	14-N	VEHICULAR BRIDGE
BA-151	14-N	VEHICULAR BRIDGE
BA-152	14-N	VEHICULAR BRIDGE
BA-153	14-N	VEHICULAR BRIDGE
BA-154	14-N	VEHICULAR BRIDGE
BA-155	14-N	VEHICULAR BRIDGE
BA-156	14-N	VEHICULAR BRIDGE
BA-157	14-N	VEHICULAR BRIDGE
BA-158	14-N	VEHICULAR BRIDGE
BA-159	14-N	VEHICULAR BRIDGE
BA-160	14-N	VEHICULAR BRIDGE
BA-161	14-N	VEHICULAR BRIDGE
BA-162	14-N	VEHICULAR BRIDGE
BA-163	14-N	VEHICULAR BRIDGE
BA-164	14-N	VEHICULAR BRIDGE
BA-165	14-N	VEHICULAR BRIDGE
BA-166	14-N	VEHICULAR BRIDGE
BA-167	14-N	VEHICULAR BRIDGE
BA-168	14-N	VEHICULAR BRIDGE
BA-169	14-N	VEHICULAR BRIDGE
BA-170	14-N	VEHICULAR BRIDGE
BA-171	14-N	VEHICULAR BRIDGE
BA-172	14-N	VEHICULAR BRIDGE
BA-173	14-N	VEHICULAR BRIDGE
BA-174	14-N	VEHICULAR BRIDGE
BA-175	14-N	VEHICULAR BRIDGE
BA-176	14-N	VEHICULAR BRIDGE
BA-177	14-N	VEHICULAR BRIDGE
BA-178	14-N	VEHICULAR BRIDGE
BA-179	14-N	VEHICULAR BRIDGE
BA-180	14-N	VEHICULAR BRIDGE
BA-181	14-N	VEHICULAR BRIDGE
BA-182	14-N	VEHICULAR BRIDGE
BA-183	14-N	VEHICULAR BRIDGE
BA-184	14-N	VEHICULAR BRIDGE
BA-185	14-N	VEHICULAR BRIDGE
BA-186	14-N	VEHICULAR BRIDGE
BA-187	14-N	VEHICULAR BRIDGE
BA-188	14-N	VEHICULAR BRIDGE
BA-189	14-N	VEHICULAR BRIDGE
BA-190	14-N	VEHICULAR BRIDGE
BA-191	14-N	VEHICULAR BRIDGE
BA-192	14-N	VEHICULAR BRIDGE
BA-193	14-N	VEHICULAR BRIDGE
BA-194	14-N	VEHICULAR BRIDGE
BA-195	14-N	VEHICULAR BRIDGE
BA-196	14-N	VEHICULAR BRIDGE
BA-197	14-N	VEHICULAR BRIDGE
BA-198	14-N	VEHICULAR BRIDGE
BA-199	14-N	VEHICULAR BRIDGE
BA-200	14-N	VEHICULAR BRIDGE

MCON PROJECTS

BLACK ■ FY-79-80-81 COMPLETED
 BLUE ■ FY-81-82-83 AUTHORIZED
 GREEN ■ UNDER CONSTRUCTION
 RED ■ FY-84 PROPOSED
 □ FY-85
 □ FY-86
 □ FY-87
 □ FY-88

REVISIONS		DATE	APPROVED
SYM	DESCRIPTION		
BA-146			

PUBLIC WORKS DEPT.		DEPARTMENT OF THE NAVY		NAVAL FACILITIES ENGINEERING COMMAND	
MARINE CORPS BASE		CAMP LEJEUNE, N.C.		ATLANTIC DIVISION	
NAVAL STATION		NORFOLK, VIRGINIA		AREA	
MARINE CORPS BASE, CAMP LEJEUNE, N.C.		DRAWING NO.		14405	
DATE		DATE		CONSTR CONTR NO.	
FOR COMMANDER, NAVFAC		SCALE		SHEET / OF	

FOR OFFICIAL USE ONLY CAMP LEJEUNE, N.C.

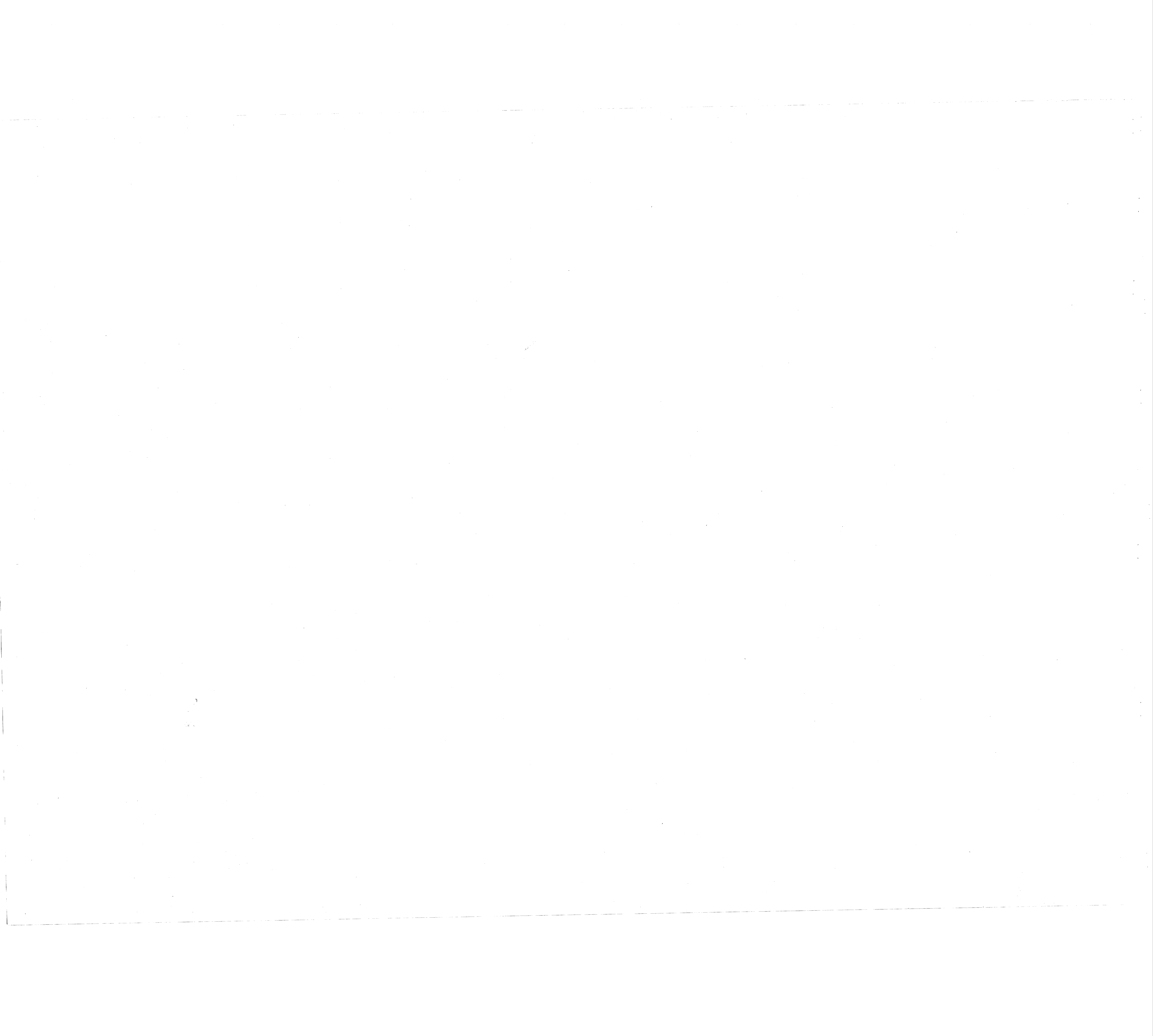

FOR ENLARGEMENT KNOX AREA
PRIVATELY OWNED TRAILERS
REFER TO SHEET 2-B

KNOX AREA TRAILER PARK
PRIVATE OWNED TRAILERS
PRIVATELY OWNED TRAILERS
BLOCK D
BLOCK E

ALL BUILDING NUMBERS
IN MONTFORD POINT AREA
ARE PREFIXED BY "M"

MCON PROJECTS

- BLACK ■ FY-79-80-81 COMPLETED
- BLUE ■ FY-81-82-83 AUTHORIZED
- GREEN ■ UNDER CONSTRUCTION
- RED ■ FY-84 PROPOSED
- FY-85
- FY-86
- FY-87
- FY-88

MONT PT AREA NO 1

MONTFORD POINT AREA NO 2

MONTFORD POINT AREA NO 2-A

LEGEND
BUILDINGS
PAVED SURFACES
GRAVEL SURFACES
RAILROADS

REVISIONS			
NO.	DESCRIPTION	DATE	APPROVED

PUBLIC WORKS DEPT. MARINE CORPS BASE CAMP LEJEUNE, N.C.		DEPARTMENT OF THE NAVY NAVAL FACILITIES ENGINEERING COMMAND ATLANTIC DIVISION MARINE CORPS BASE, CAMP LEJEUNE, N.C.	
DESIGNED BY: DR	CHKD BY: EGV	DATE: 1/1/81	DRAWING NO: 1443
APPROVED BY: [Signature]	DATE: 1/1/81	CONSTR CONTR NO:	SHEET: 1
PROJECT: CAMP DEVELOPMENT II	SCALE: 1" = 100'	FOR OFFICIAL USE ONLY	

FOR OFFICIAL USE ONLY CAMP LEJEUNE, N.C.

