

**ONSLow COUNTY
SUPPLEMENT
THIRD DIVISION**

SCALE
1" = 1 MILE

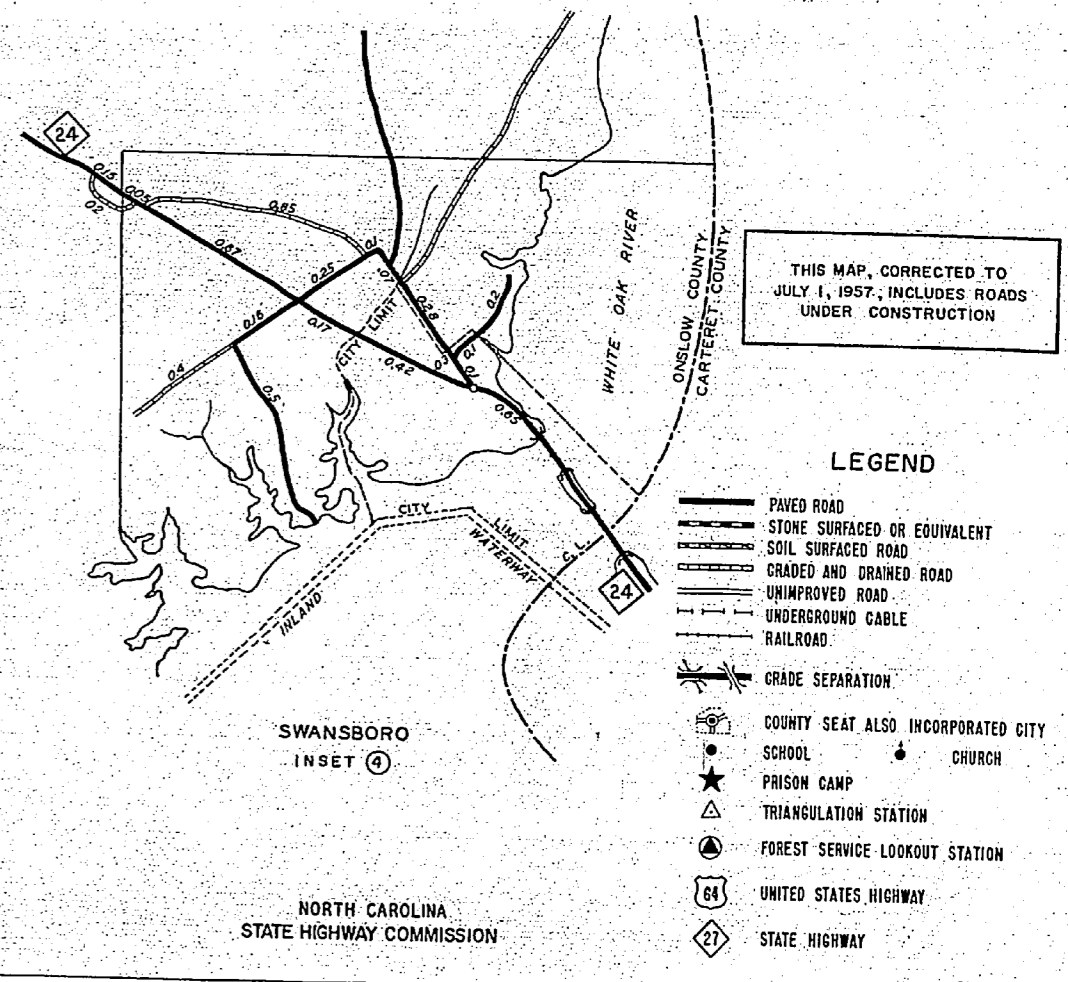
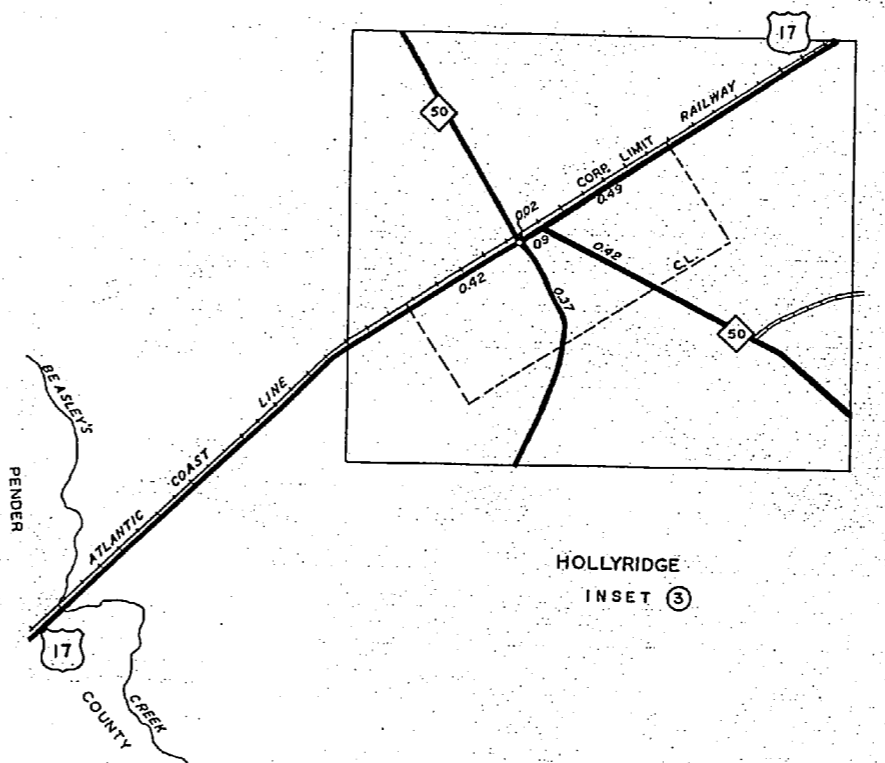
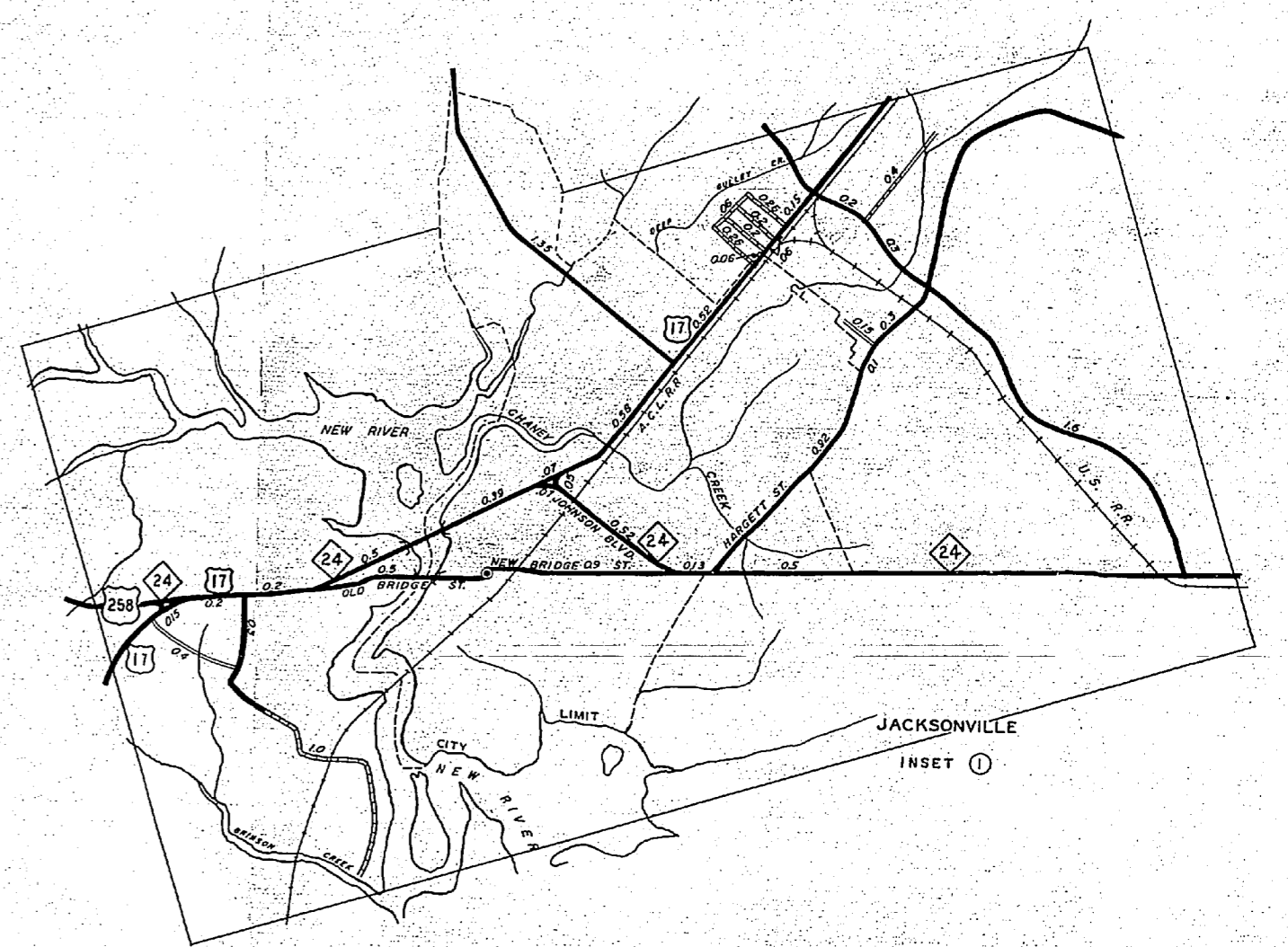
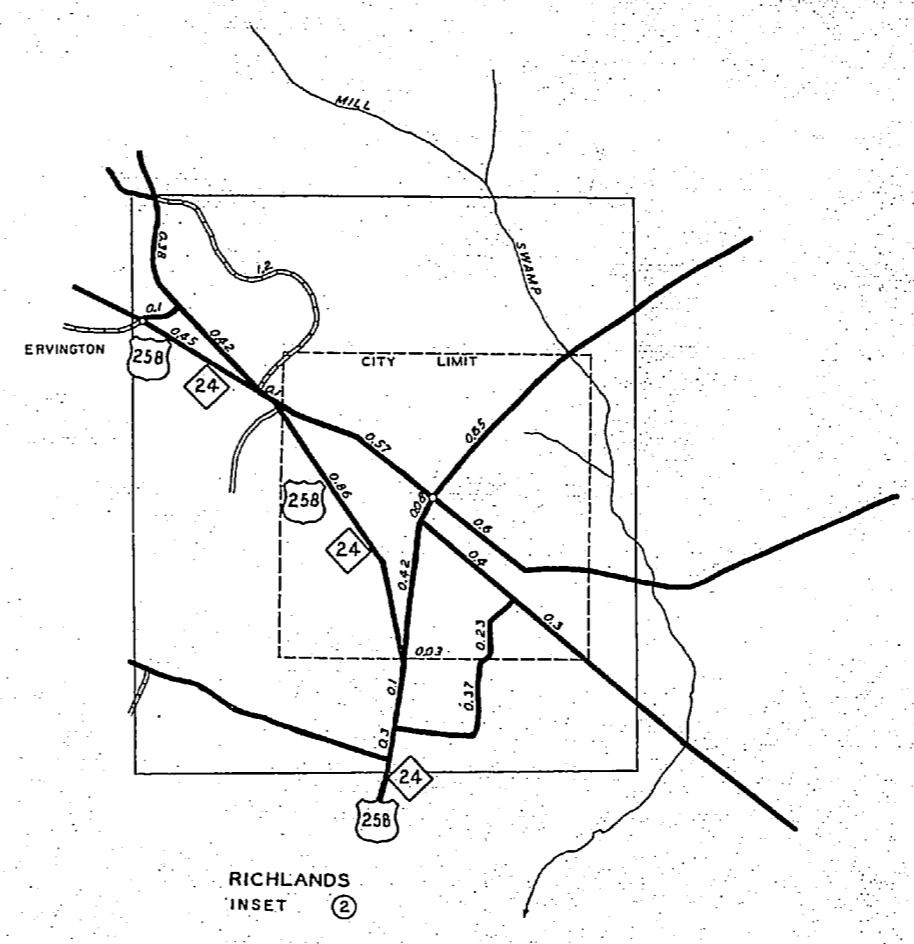

THIS MAP, CORRECTED TO JULY 1, 1957, INCLUDES ROADS UNDER CONSTRUCTION.

LEGEND

- PAVED ROAD
- ROAD UNDER CONSTRUCTION
- UNPAVED ROAD
- RAILROAD
- CRUISE SEPARATION
- COUNTY SEAT ALSO INCORPORATED CITY
- SCHOOL
- PRISON CAMP
- TRANSCHEMELATION STATION
- POWER SERVICE LEADOUT STATION
- UNITED STATES AIRCRAFT
- STATE HIGHWAY

NORTH CAROLINA
STATE HIGHWAY COMMISSION

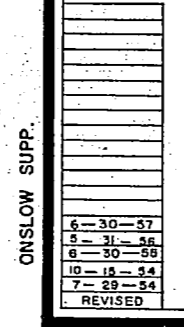

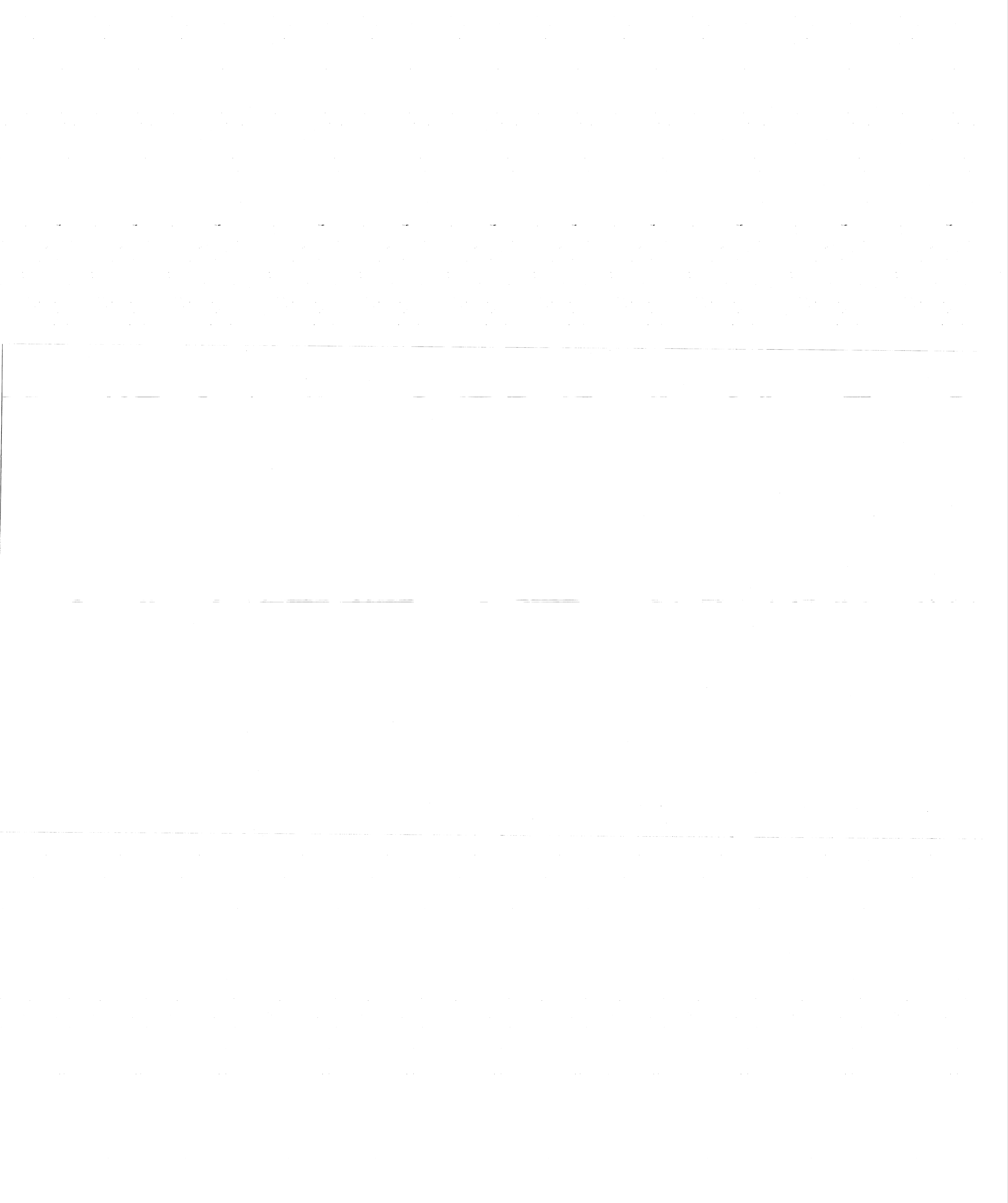

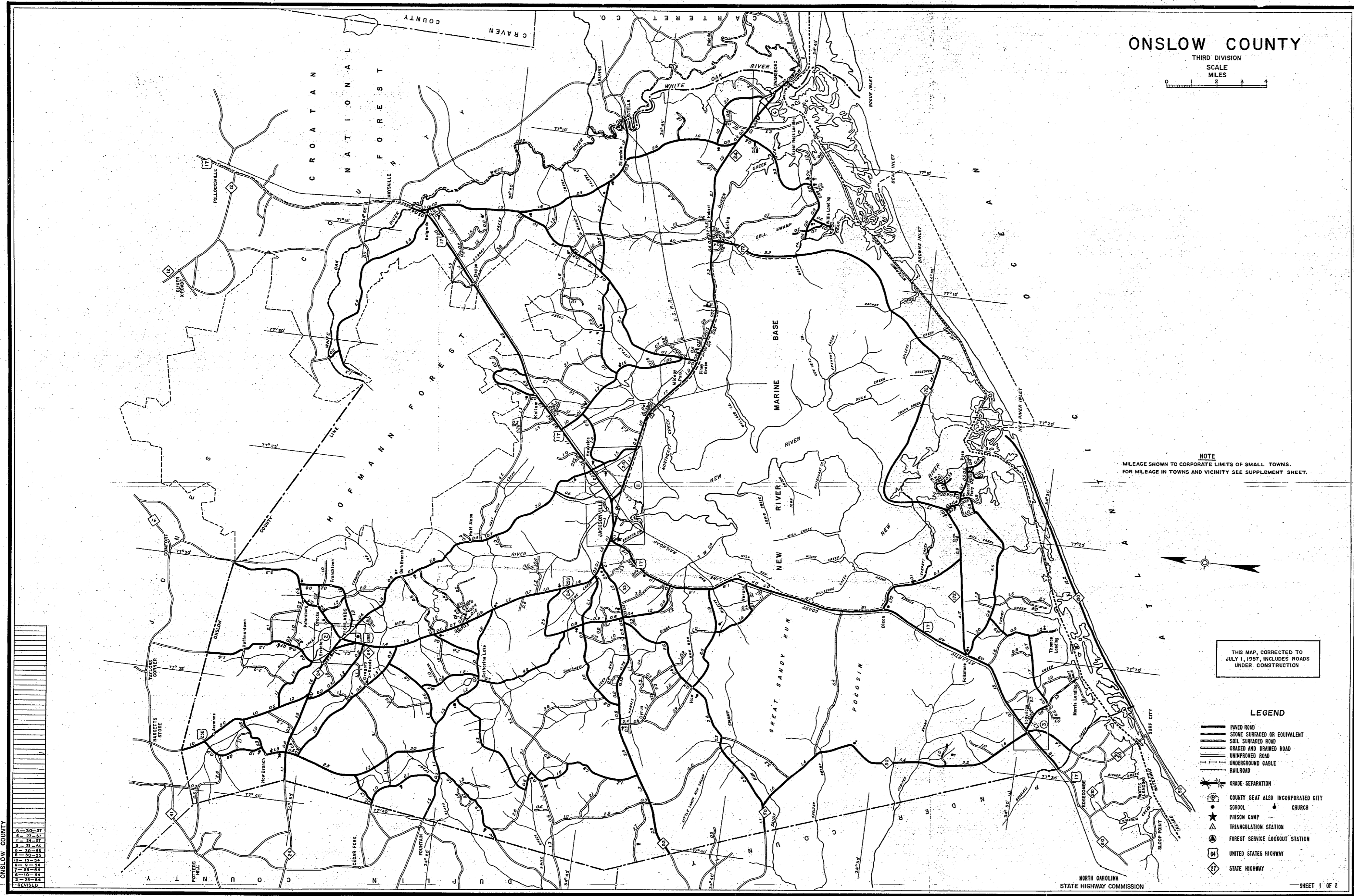

DESCRIPTION

THE MARINE CORPS RESERVATION BOUNDARY MONUMENT NO. 1331, SAID MONUMENT LOCATED IN THE NORTHEAST QUARTER OF THE SECTION 16, COUNTY OF ONSLAW AND U.S. DISTRICT OF NORTH CAROLINA, THENCE BEGINNING AT POINT DESIGNATED BY THE U.S. GOVERNMENT AS POINT NO. 1, THENCE BY THE COMMON PROPERTY LINE BETWEEN THE U.S. GOVERNMENT AND THE STATE HIGHWAY AND PUBLIC WORKS COMMISSION, SAID POINT BEING THE RIGHT OF WAY STATION 222.88+77.74, THENCE BY DIRECT BEARINGS AND DISTANCES AS SHOWN IN CURVE BELOW.

WHERE MORE THAN ONE VALUE IS SHOWN FOR AN ITEM ON A PARTICULAR COURSE, THE VALUE IN PARENTHESES IS THE VALUE AS COMPUTED FROM WORDS AND DIMENSIONS NOS. 222.88+77.74 AND 222.88+77.74, INCLUDING THE VALUES NOT IN PARENTHESES ARE BASED UPON SURVEY AS SHOWN ON PLAN AND PROFILE SHEETS FOR N.C. HIGHWAY PROJECT 3451, AND THE VALUES USED IN CALCULATIONS FOR COMPUTING THE ACRESAGE AND CLOSURE OF THE SAID COURSE TO POINTS ARE EQUIVALENT TO COURSE 12, TAKING 36.51 AS A CONSTANT.

DISTANCE	BEARING	CENTRAL ANGLE	CURVE	CHORD	LENGTH	RADIUS	LONG. CHORD
423.87	N26°10'00"N						
(6689.23)	N09°00'00"W						715.88
6674.00	N09°00'00"W						1923.82
9055.30	N10°30'00"E						
(1742.60)	N07°30'00"E						
8180.00	N08°00'00"E						
7103	N07°30'00"E						
14702	N07°30'00"E						
12925	N07°30'00"E						
12802.33	N07°30'00"E						
4200.33	N07°30'00"E						
668.60	N07°30'00"E						
(4678.60)	N13°05'28"00"W						1299.00
4670.00	N13°05'28"00"W						
(8701.60)	N08°05'00"00"W						944.67
8701.00	N08°05'00"00"W						
(2137.30)	N17°44'30"E						595.95
2137.00	N17°44'30"E						
(5579.30)	N17°44'30"E						680.67
5587.00	N17°44'30"E						
(4729.20)	N03°34'30"E						516.81
4729.00	N03°34'30"E						
(1288.70)	N32°12'30"E						1288.03
1288.00	N32°12'30"E						
(1028.70)	N19°04'00"E						962.05
1028.00	N19°04'00"E						
(1430.00)	N02°02'30"E						1039.92
1430.00	N02°02'30"E						
(1830.00)	S59°04'30"W						1829.22
1830.00	S59°04'30"W						
(2910.00)	S37°00'00"W						1366.62
2910.00	S37°00'00"W						
(2587.00)	S76°45'00"W						1736.28
2587.00	S76°45'00"W						
(2171.00)	S74°00'00"E						2283.42
2171.00	S74°00'00"E						
(3304.20)	S04°06'00"E						1492.86
3304.20	S04°06'00"E						
(2742.40)	S30°22'00"E						
2742.40	S30°22'00"E						
(400.00)	S59°35'00"W						
400.00	S59°35'00"W						
(70.00)	N59°35'00"E						
70.00	N59°35'00"E						
(973.70)	S30°25'00"E						2487.91
973.70	S30°25'00"E						
(2431.92)	S29°45'00"W						2168.24
2431.92	S29°45'00"W						
(5770.05)	S10°32'00"N						1389.95
5770.05	S10°32'00"N						
(7075.00)	S10°30'00"N						
7075.00	S10°30'00"N						
(7827.74)	S09°00'00"E						
7827.74	S09°00'00"E						

SECTION: THE PERMANENT RIGHT OF WAY AND EASEMENT PRIVILEGES ENJOYED BY THE STATE HIGHWAY AND PUBLIC WORKS COMMISSION ON THAT AREA BOUNDED BY THE FOLLOWING: BEGINNING AT POINT NO. 1, THENCE N30°12'00"W 190.03 TO POINT NO. 16, THENCE N10°33'00"E 228.03 TO POINT NO. 51, THENCE S30°12'00"E 190.03 TO POINT NO. 52, THENCE S10°33'00"W 228.03 TO POINT NO. 15, THE POINT BEGINNING.

CONTAINING A NET AREA OF 103.023 ACRES.
THE CIRCUIT ENCLOSING THE RIGHT OF WAY NEEDED FOR THE FIRST INCREMENT OF CONSTRUCTION WILL BEGIN AND END AT POINT NO. 201 AS SHOWN ON THE MAP. THE BEARINGS AND DISTANCES OF THE SUPPLEMENTARY COURSES ARE SHOWN BELOW.
THE FIRST INCREMENT WILL CONTAIN 45.425 ACRES.

DISTANCE	BEARING	COURSE	DISTANCE	BEARING
103.00	N44°00'00"W	428.200	100.00	S75°25'00"W
386.00	N14°00'00"W	428.43	1597.00	S14°25'00"E
288.00	S14°35'00"E			

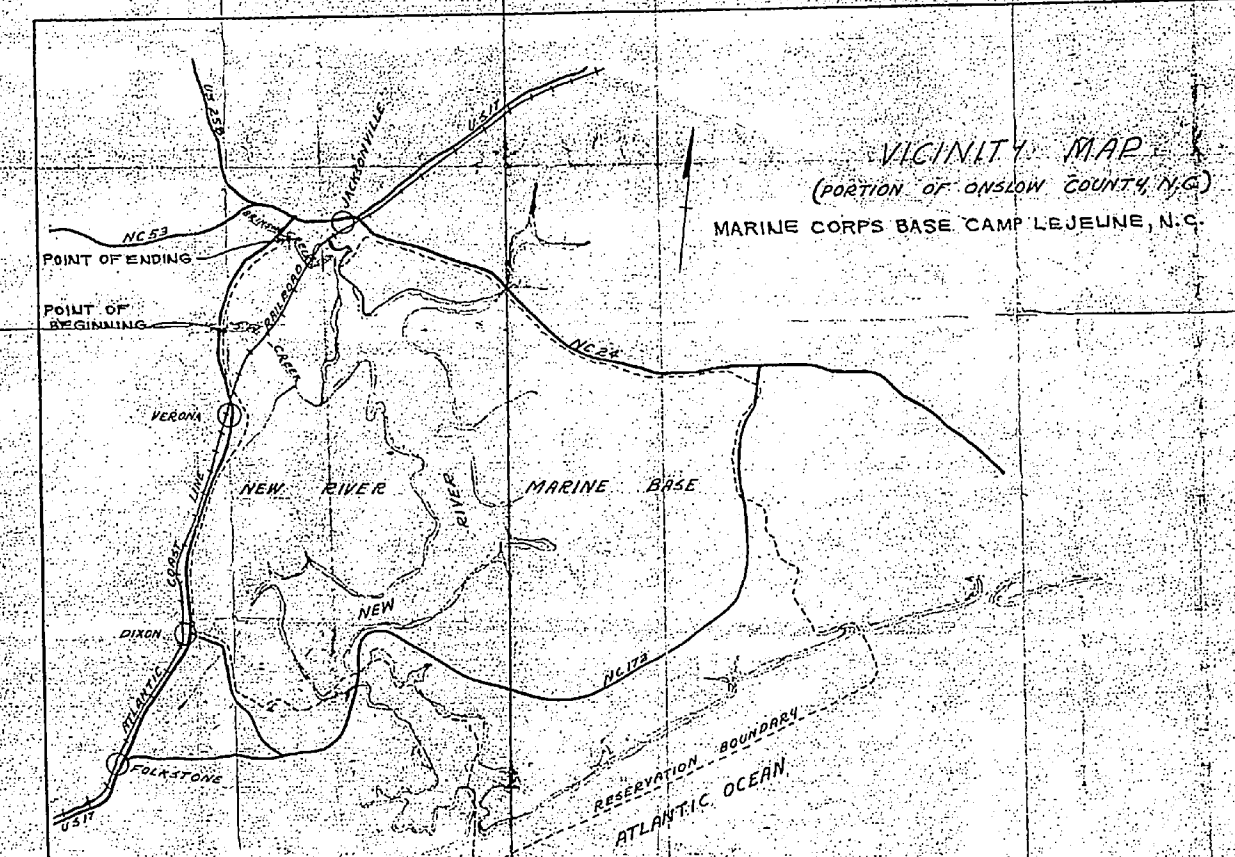
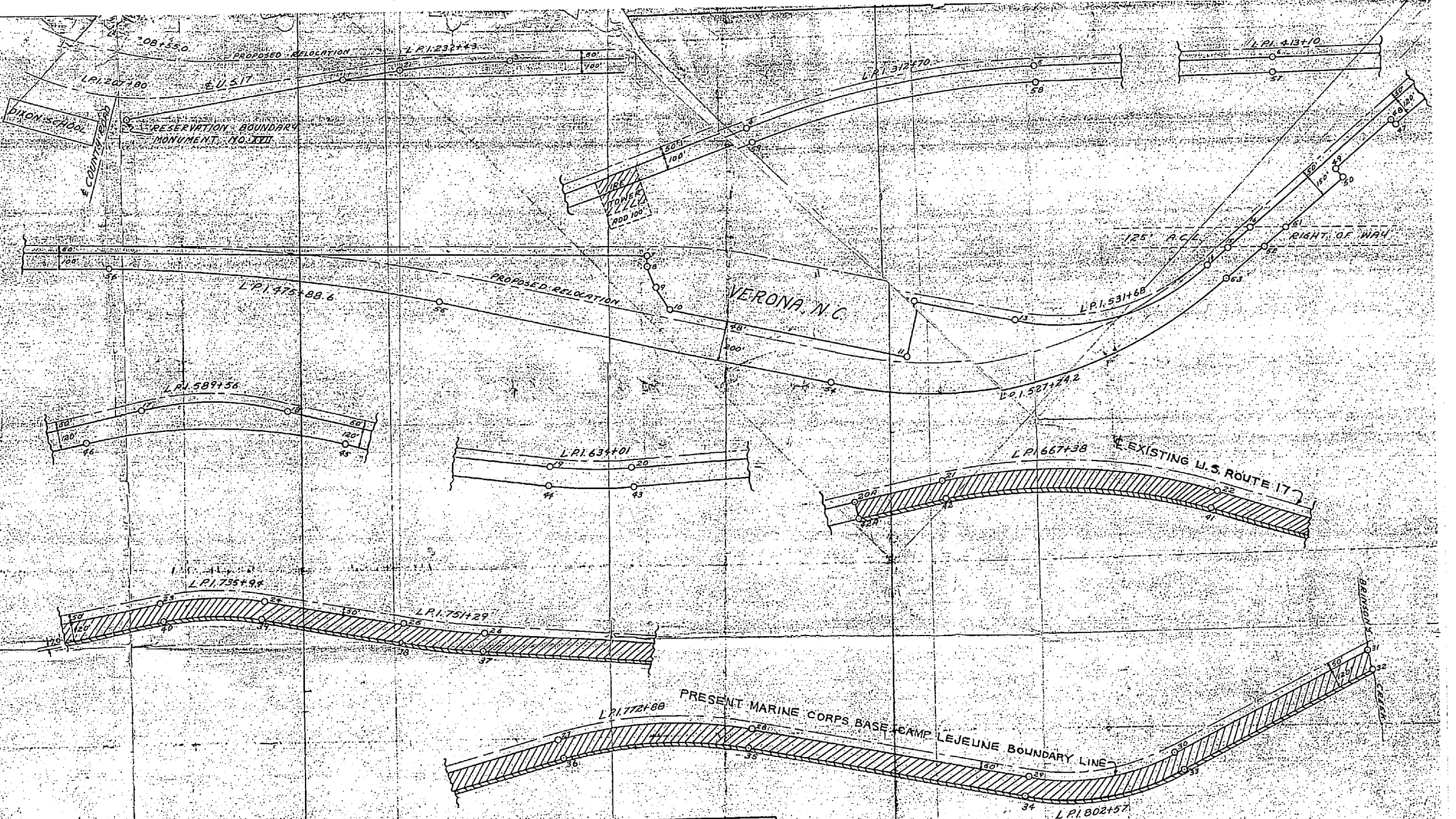

NOTE:
THIS DRAWING REVISED BY FIFTH NAVAL DISTRICT PUBLIC WORKS OFFICE TO SHOW: (1) EASEMENT FOR EXISTING U.S. ROUTE 17; (2) CAMP LEJELINE BOUNDARY LINE; (3) EASEMENT FOR RELOCATION OF TELEPHONE LINE DATE 3-17-56.

NORTH CAROLINA STATE HIGHWAY AND PUBLIC WORKS COMMISSION

PROJECT 3451, F269(4) ONSLOW COUNTY
SCALE 1"=400'

GOVERNMENT AGENCY - U.S. MARINE CORPS

- LEGEND**
- NEEDED FOR FIRST INCREMENT OF CONSTRUCTION
 - NEEDED FOR FUTURE CONSTRUCTION; NOT TO BE NEGOTIATED AT THIS TIME
 - INDICATES 20' EASEMENT REQUIRED FOR RELOCATION OF CAROLINA TELEPHONE & TELEGRAPH CO. TELEPHONE LINE

