

192	N 11° 30' W	0.70
53	N 32° 30' W	3.50
45	N 22° 30' W	1.60
85	N 53° 45' W	1.11
52	N 19° 30' W	0.37
30	N 77° 45' W	2.77
16	S 80° 48' W	3.44
13	S 57° 10' W	2.42
20	S 52° 10' W	1.50
9	S 49° 00' W	2.00
5	S 00° 30' E	1.12
1	S 15° 00' W	1.42
6	S 18° 20' W	2.00
9	S 25° 30' W	0.87

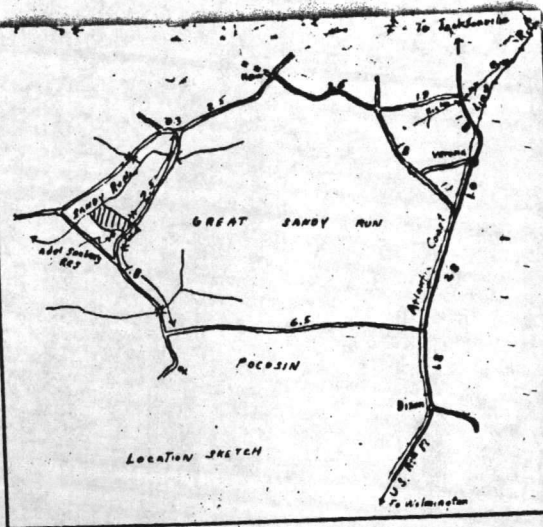
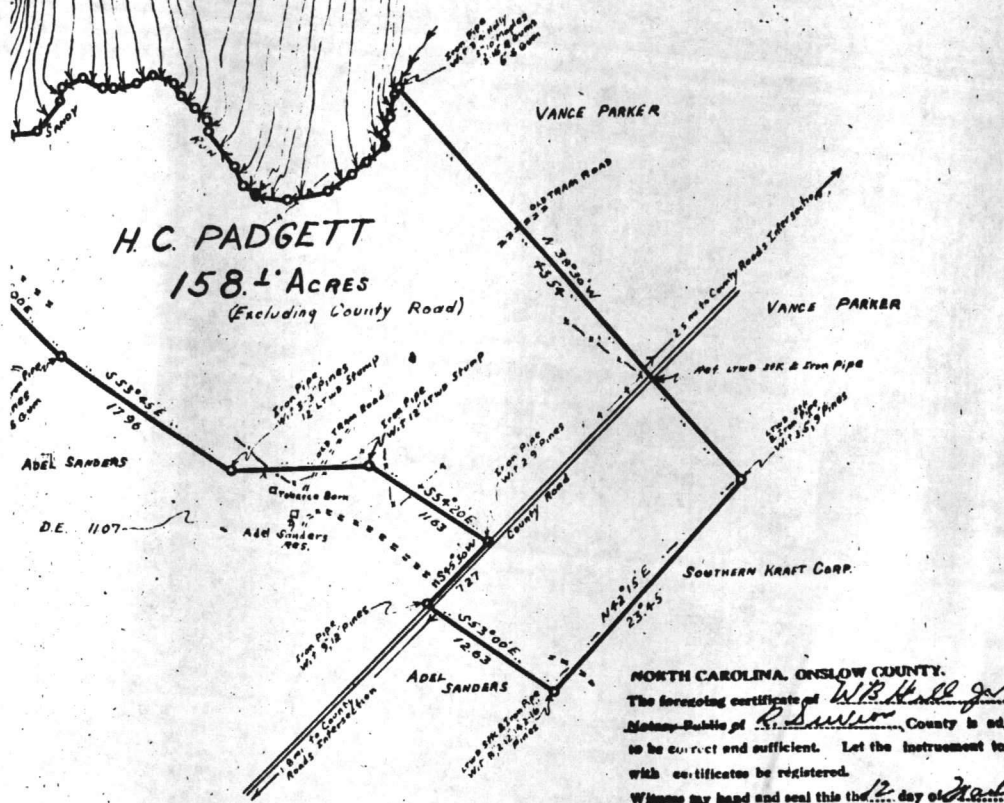

CASE NO. T.G - III-7-67-935.38  
 PROPERTY OF  
**INTERNATIONAL PAPER CO.**  
**H.C. PADGETT TRACT**  
 STUMP SOUND TWP  
 ONSLOW COUNTY  
 NORTH CAROLINA  
 Scale 1 inch = 10 chains

**LEGEND**  
 Chopped line & Corner  
 Branch  
 County Road  
 Woods Road  
 Fence  
 Blot Chop

STATE OF NORTH CAROLINA  
 COUNTY OF NEW HANOVER

I, W.B. Hill, Jr., do hereby certify upon Oath that I prepared the annexed plat and that the same is in all respects correct and was prepared from an actual survey by me made on the 19th day of November 1946.  
 this is the 20th day of November 1946  
 W.B. Hill, Jr. (R.S.) NC, SC

**NORTH CAROLINA, ONSLOW COUNTY.**  
 The foregoing certificate of W.B. Hill, Jr.  
 Notary Public of Onslow County is adjudged  
 to be correct and sufficient. Let the instrument together  
 with certificates be registered.  
 Witness my hand and seal this 12th day of Nov 1946

John E. Hill  
 Clerk Superior Court

Sworn to and subscribed before me, this  
 the 20th day of November 1946.

My Commission expires:

