

Visitor's
Map and
Hours

The National Archives Building

700 Pennsylvania Avenue NW, Washington, DC 20408
1-86-NARA-NARA • 1-866-272-6272

Regular Research Hours

(Closed on Sundays, Federal Holidays, and Most Saturdays)

Mon	Tue	Wed	Thur	Fri
9:00 A.M.	9:00 A.M.	9:00 A.M.	9:00 A.M.	9:00 A.M.
5:00 P.M.	5:00 P.M.	5:00 P.M.	5:00 P.M.	5:00 P.M.

Extended Research Hours Once Monthly

MORE INFO
ONLINE AT
ARCHIVES.GOV

No archival assistance or record pulls available during extended hours.

Thur: 5:00 P.M. - 8:45 P.M.
Fri: 5:00 P.M. - 8:45 P.M.
Sat: 8:45 A.M. - 4:45 P.M.



Archives-Navy
Memorial
Metrorail Station

RESEARCH ENTRANCE

Enter here to
Conduct Research

THE NATIONAL ARCHIVES EXPERIENCE

EXHIBIT ENTRANCE

Enter here to view
the Declaration,
Constitution, & more

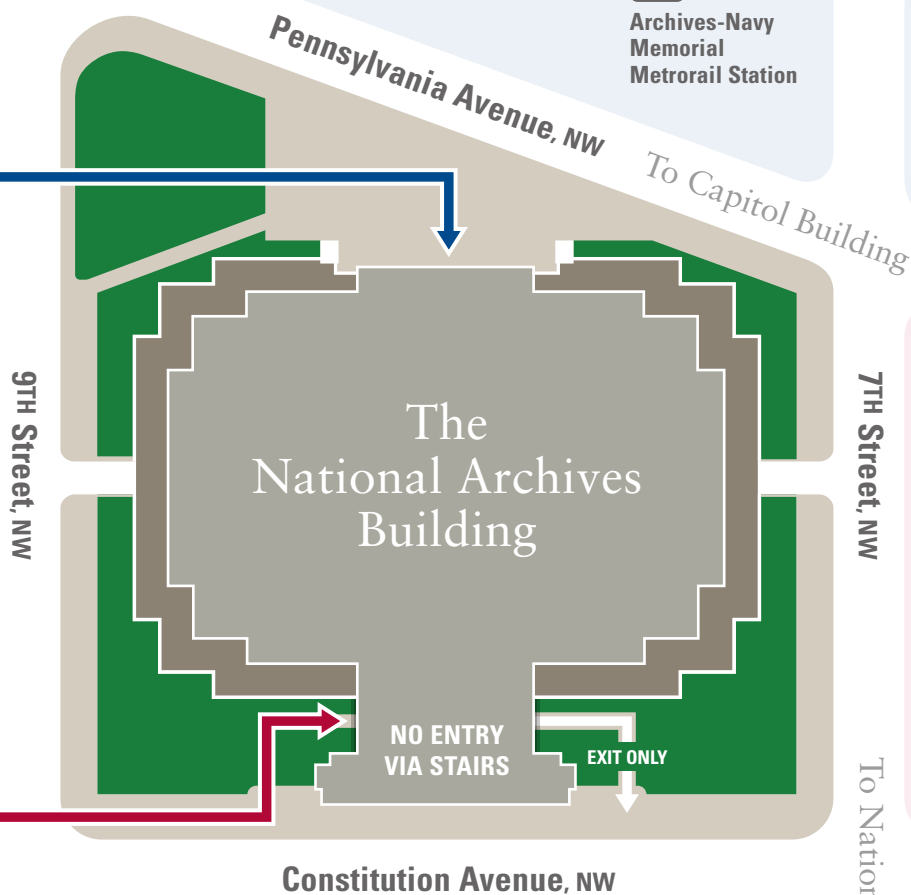

Exhibit Hours

Exhibits open every day *except* Thanksgiving Day and December 25.
Last admission is 30 minutes prior to closing.

Spring & Summer Seasons (March 15 through Labor Day)

10:00 A.M.–7:00 P.M. (every day)

Fall & Winter Seasons (Day after Labor Day through March 14)

10:00 A.M.–5:30 P.M. (every day, *except* closed on Thanksgiving Day and December 25)

THE
NATIONAL
ARCHIVES
EXPERIENCE

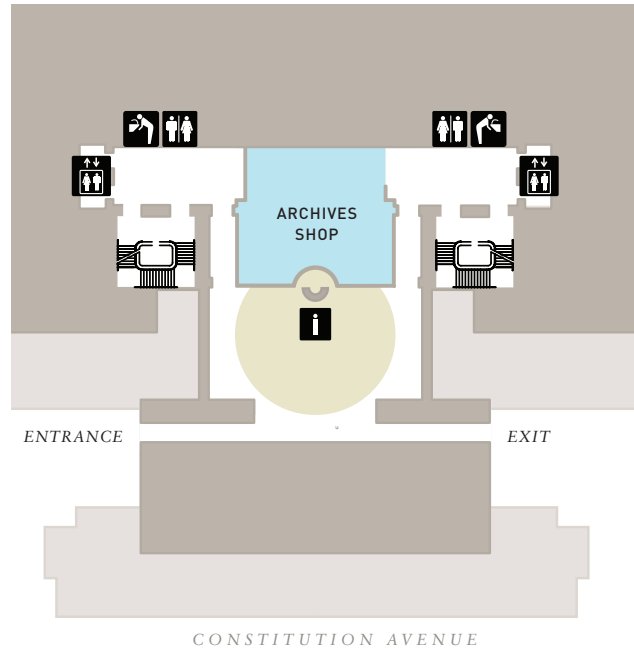

Entrance/Exit GROUND LEVEL

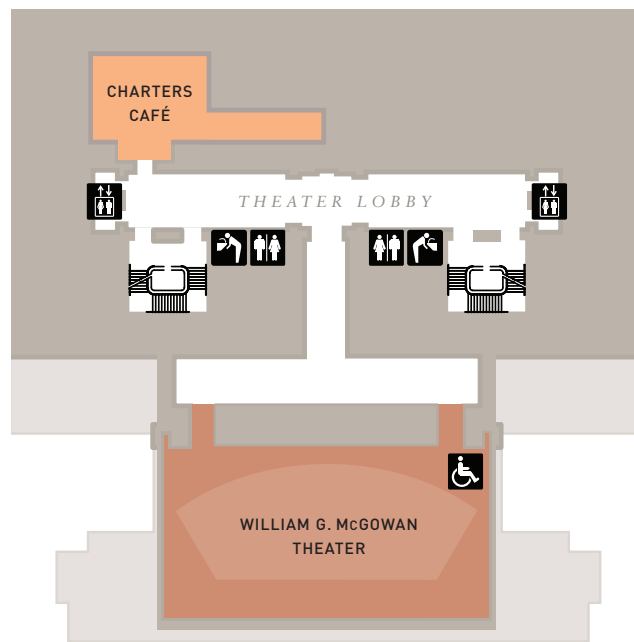

Theater LOWER LEVEL

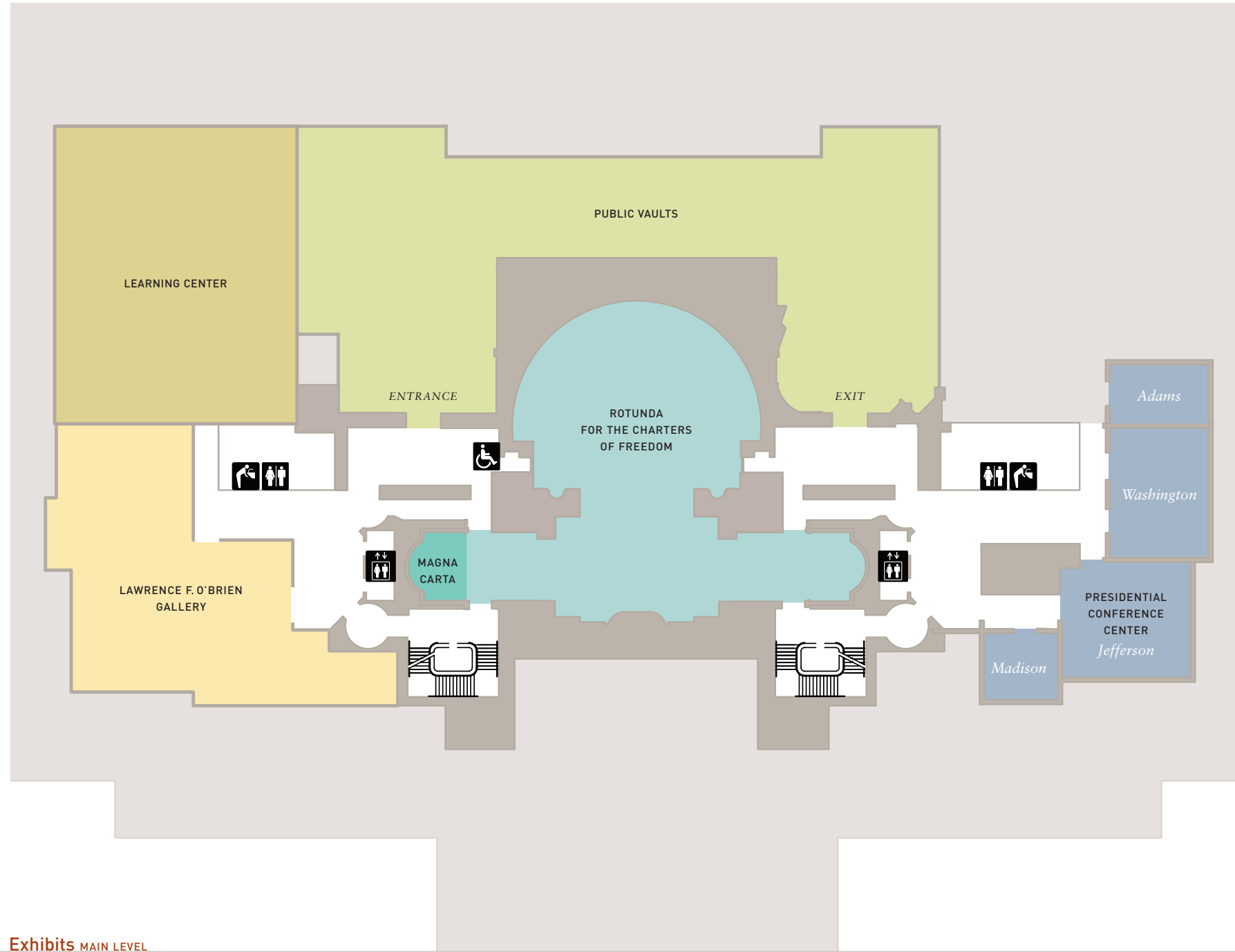

Exhibits MAIN LEVEL



Exhibits MAIN LEVEL

- Lawrence F. O'Brien Gallery
- Public Vaults
- Rotunda for the Charters of Freedom
- Magna Carta
- Learning Center
- Presidential Conference Center
 - Washington Room
 - Jefferson Room
 - Madison Room
 - Adams Room

Entrance/Exit GROUND LEVEL

- Visitor Services
 - Information Desk
 - Wheelchairs
 - Lost and Found
 - First Aid
- Archives Shop

Theater LOWER LEVEL

- Charters Café
- William G. McGowan Theater